

# Sieve Bed Assembly and Product Tank Platinum 5 Models

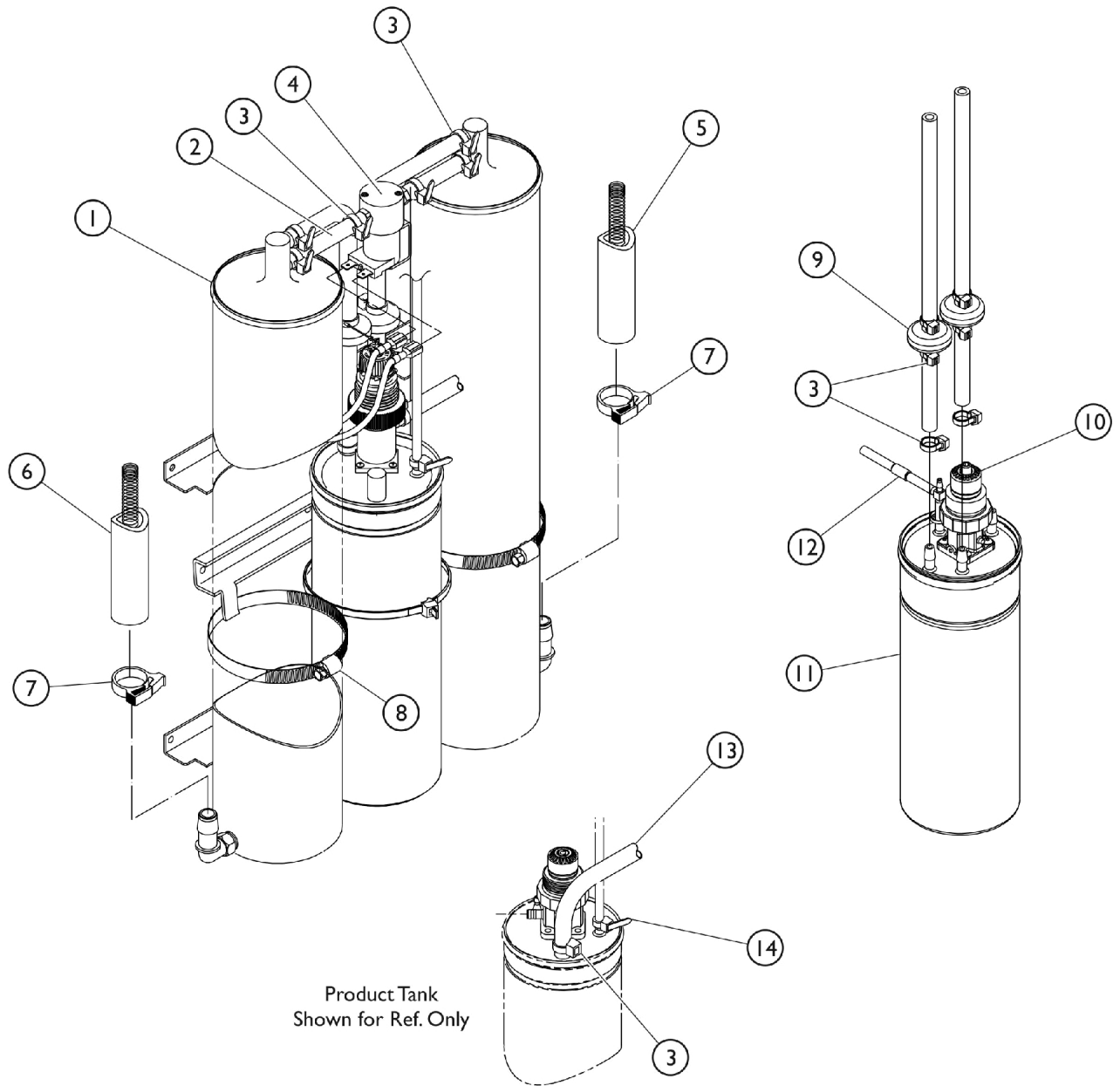

## Sieve Bed Assembly and Product Tank Platinum 5 Models

Item Number	Note	Part Number	Description	Quantity Per	
				Package	Assembly
1	A,I	1101707	Sieve Bed Assembly (Pair)	2	2
2		1110774	Tubing, PVC (1/4 x 2-1/2")	1	2
3		2001682	Tie Wrap (8" L)	1	9
4	B	2001656	PE Valve Assembly w/ Fitting	1	1
5		1108783	Tubing, Braided (1/2 x 23")	1	1
6		1108784	Tubing, Braided (1/2 x 20-1/4")	1	1
7		2001652	Clamp, Plastic (1/2")	1	2
8		1002807	Clamp, Hose	1	2
9		1143544	Check Valve Assembly (9")	1	2
10	H	1182123	Kit, Regulator and Adaptor, No-Bleed Regulator	1	1
			Regulator/Adaptor Assembly, No-Bleed Regulator	1	1
			Screw, Socket Button Head Cap, Regulator (8-32 x 3/8")	1	4
			NLA - O-Ring (11/64" I.D.)	1	2
10	H	1182024	Kit, Regulator and Adaptor w/ Bled Regulator	1	1
11	E,G	1082588-NLA	NLA - Product Tank Assembly - IRC5LX	1	1
11		1114925-NLA	NLA - Product Tank Assembly - IRC5LX	1	1
11	E	1075665-NLA	NLA - Product Tank Assembly - IRC5LX02	1	1
12	D	1106774-NLA	NLA - HomeFill Tubing Assembly	1	1
13		1108809	Tubing, PVC (1/4 x 12-3/4")	1	1
14		1070050	Tie Wrap (3-29/32" L)	1	1
<p>NOTE: A - Includes (2) Sieve Beds, (2) Clamps, (2) Hose Clamps and (4) Tie Wraps.            B - Includes items 2-3, PE Valve and Barb Fitting.            D - Includes Tubing and Fittings.            E - Includes items 8 and 11.            G - Item no longer available. Please order part #1114925 as a replacement.            H - Kit includes the Regulator, Adaptor, Restrictor, O-Rings, Tubing, Screws, and Cable Ties.            I - May contain reactivated sieve.</p>					