

Door Probe Locking Assemblies

For Models 3600, 3600XL, 3700A, 3700B, 3700BMF, 3700D, 3700DMF, 3750, and 3800 unless noted otherwise.

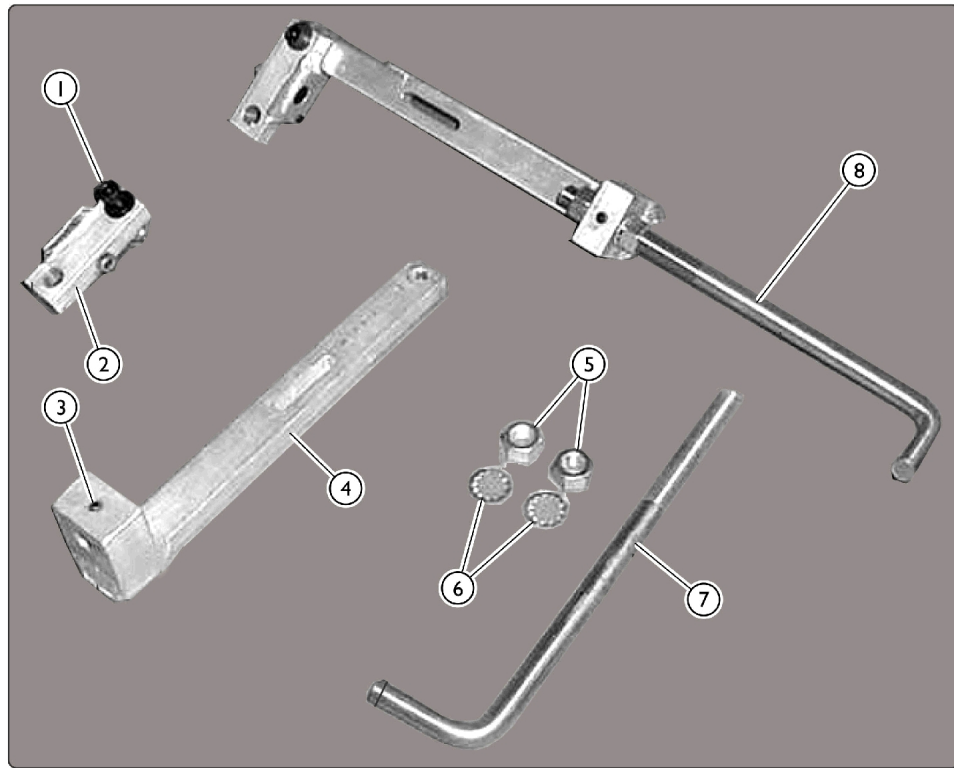

SICC_071A

Door Probe Locking Assemblies

For Models 3600, 3600XL, 3700A, 3700B, 3700BMF, 3700D, 3700DMF, 3750, and 3800 unless noted otherwise.

Item Number	Note	Part Number	Description	Quantity Per	
				Package	Assembly
1		IHPAR9902	Screw, Hex Head (5/16-18 x 2")	1	1
1		PAR9919	Washer	1	1
1		IHPAR9903	Nut (5/16-18)	1	1
2	A,C	1145541	Bracket, Probe Swivel	1	1
2	B,C	IHPAR3743-NLA	NLA - Bracket, Probe Swivel includes #1	1	1
3		IHPAR3625	Screw, Set, Hinge Bracket	1	1
4	A,F	PAR3642-NLA	NLA - Bar, Probe Slide	1	1
4	B	IHPAR3742	Bar, Probe Slide	1	1
5		1127647	Nut, Hex (1/2-20)	1	2
6		IHPAR9852-NLA	NLA - Washer, Star Lock	1	2
7	D	IHPAR3641-NLA	NLA - Probe, Door	1	1
8	A,E	PAR3640	Mechanism, Complete Probe Locking	1	1
			NLA - Bar, Probe Slide	1	1
			Probe, Threaded	1	1
			Slide, Bracket Bar	1	1
			Screw, Set, Socket Head, Cup Point (5/16-18 x 2)	1	1
			Screw, Flat, Socket Head (1/4-20 x 1-1/2)	1	1
			Washer, Flat (5/16 x 3/4 x 3/64)	1	3
			Washer, Lock, Internal Tooth (1/2)	1	2
			Nut, Hex (1/4-20)	1	1
			Nut, Hex (1/2-20)	1	2
			Nut, Hex (5/16-18)	1	2
8	B,E	IHPAR3740-NLA	NLA - Mechanism, Complete Probe Locking	1	1
NOTE: A - For Models 3600, 3600XL, 3750, and 3800 ONLY. B - For Models 3700A, 3700B, 3700BMF, 3700D, 3700DMF ONLY. C - Also includes Item 1 (Screw, Nut, and Washer). D - Also includes Items 5 (Hex Nut) and Item 6 (Lockwasher) E - Also includes Items 1 - 7. F - Part #PAR3642 is no longer available individually. Order item #8 PAR3640 that includes both part numbers PAR3642 and 1145541 together as a replacement.					