

Door Handle and Safety Latch Components

There is a difference between old style and new style handles (Item #2).

Old Style: Distance between handle pin/hole for the latch pin is 3-3/4"

New Style: Distance between handle pin/hole for the latch pin is 3".

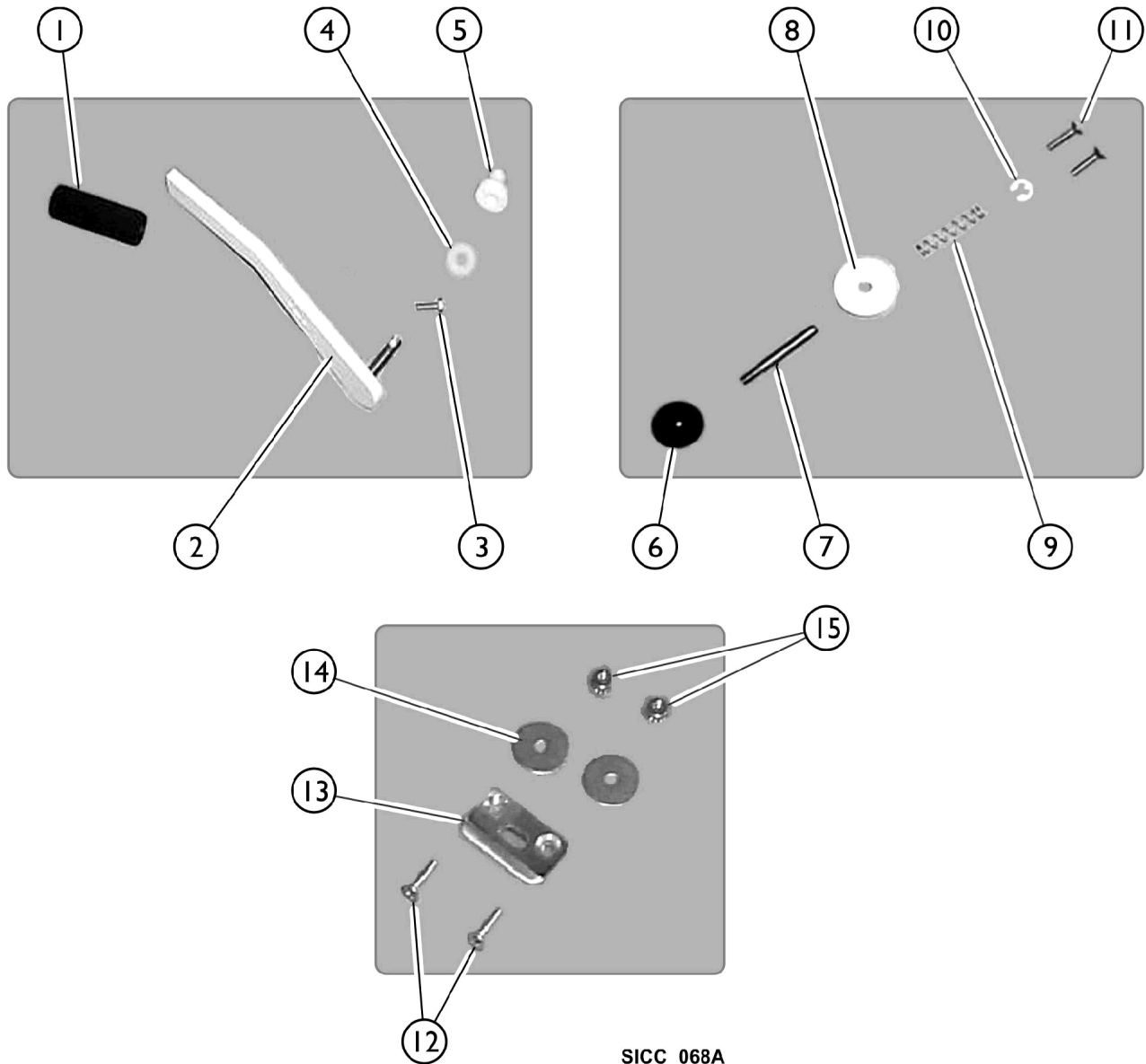

SICC_068A

Door Handle and Safety Latch Components

There is a difference between old style and new style handles (Item #2).

Old Style: Distance between handle pin/hole for the latch pin is 3-3/4"

New Style: Distance between handle pin/hole for the latch pin is 3".

Item Number	Note	Part Number	Description	Quantity Per	
				Package	Assembly
1		TRP1036	Door Handle Grip	1	1
2	A	IHPAR3620A-NL A	NLA - Handle, Door, Almond	1	1
2	A	PAR3620B	Handle, White Door	1	1
2	B	IHPAR3620A-NL A	NLA - Handle, Door, Almond	1	1
2	B	PAR3620B	Handle, White Door	1	1
2	C	IHPAR3702RA-NLA	NLA - Handle, Reverse Door, Almond	1	1
2	C	IHPAR3702RW-NLA	NLA - Handle, Reverse Door, White	1	1
3		PAR9901	Bolt (5/16-18 x 1")	1	1
4		PAR9240A	Washer, Nylon	1	1
5		IHPAR3621	Bushing, Door Handle	1	1
6		PAR3606	Knob, Safety Latch	1	1
7		PAR3601	Pin, Safety Latch	1	1
8		IHPAR3603A-NL A	NLA - Collar, Almond Safety Latch	1	1
8		PAR3603B	Collar, Safety Latch	1	1
9		PAR3604	Spring, Safety Latch	1	1
10		PAR3605	Cir-Clip	1	1
11		IHPAR9911	Screw, Phillips, Flat Head (#10-24 x 3/4")	2	2
12		IHPAR9912	Screw, Phillips, Flat Head (#10-24 x 1")	2	2
13		PAR3607	Striker Plate, Safety Latch	1	1
14		IHPAR9913	Washer, Fender	2	2
15		IHPAR9910	Nut (#10-24)	2	2
NOTE: A - Used on Model 3600, 3600XL, 3750, 3800 Tubs. B - Used on Model 3700A, 3700B, 3700BMF Tubs. C - Used on Model 3700, 3700DMF Tubs.					