

Disinfectant System Components

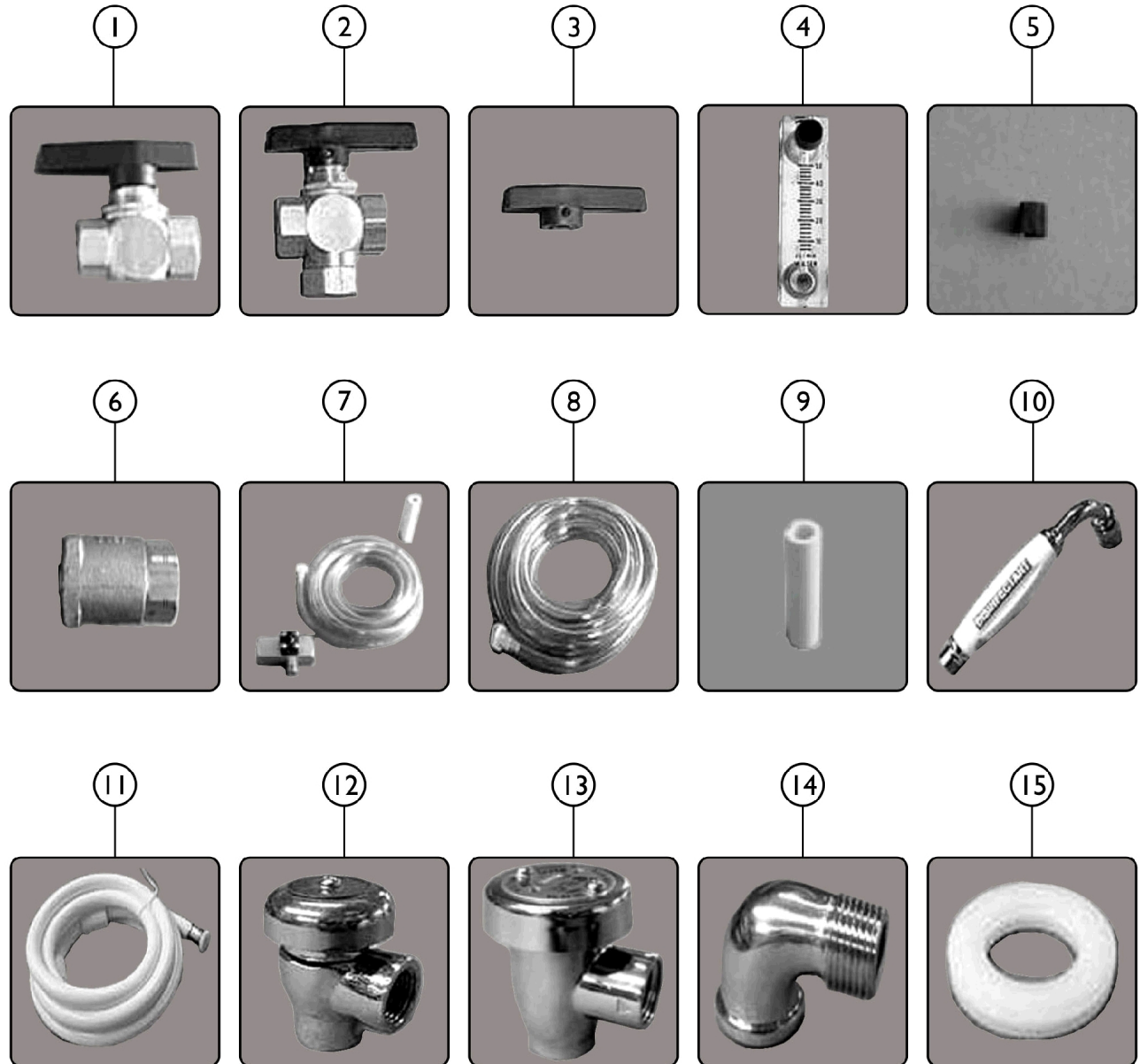

SICC_069A

Disinfectant System Components

For Models 3600, 3600XL, 3700, 3750, 3800, 3300, 4300, 5300

Item Number	Note	Part Number	Description	Quantity Per	
				Package	Assembly
1		PAR1110C	Valve, Two Way Ball (Disinfectant on/off)	1	1
2		IHPAR1111C-NL A	NLA - Valve, Three Way Ball (Diverter valve version)	1	1
3		PAR1110	Handle, Replacement	1	1
4		PAR1108	Metering Valve	1	1
5		IHPAR1106	Metering Valve Replacement Knob	1	1
6		PAR5673	Check Valve (1/4" FPT)	1	1
7	A	PAR1030	Injector Assembly (3/8" FPT)	1	1
7	B	1096922-NLA PAR1161	NLA - Injector Assembly (1/2" FPT) Connector, Male (3/8" Tube x 3/8" MP)	1	1 2
8		IHPAR1034	Check Valve and Suction Tube, Disinfectant	1	1
9		IHPAR1032-NLA	NLA - Weight, Ceramic (for disinfectant suction tube and check valve)	1	1
10	C	PAR5087B-NLA	NLA - Wand, Disinfectant	1	1
11		PAR5118G	Hose, Shower and Disinfectant Wand	1	1
12		PAR7380AG	Back Flow Preventer - Conbraco (1/2") (One Screw in Cap)	1	1
12a		IHPAR7383C	Bonnet	1	1
	D	IHPAR7384C	Kit, Repair	1	1
13		IHPAR7380-AG- W	NLA - Back-Flow Preventer, "WATTS" 1/2" (Two screws in cap)	1	1
13		IHPAR7382CW	NLA - Bonnet	1	1
13		IHPAR7384CW	NLA - Kit, Repair	1	1
14		PAR1136	Elbow, 90 Degrees - Chrome	1	1
15		PAR6160D	Washer, Nylon, Backflow Preventer and Chrome Elbow	1	1

NOTE: A - Used on all tubs prior January 2002. Used on 2 jet tubs only from January 2002 to March 2004. Used on all tubs after March 2004.
 B - If 1/2" FRT Thread connections, order (2 ea.) part number PAR1161.
 C - Used on all models except 3700 series / 3750 and 3800, discontinued on all models manufactured after March 2004.
 D - Not shown in photos.