

Anti-Tip Assembly - Front (After 8/1/11)

Non-serviceable parts in the field require the wheelchair to be returned to Invacare for repair. Call Technical Services for assistance (1-800-832-4707)

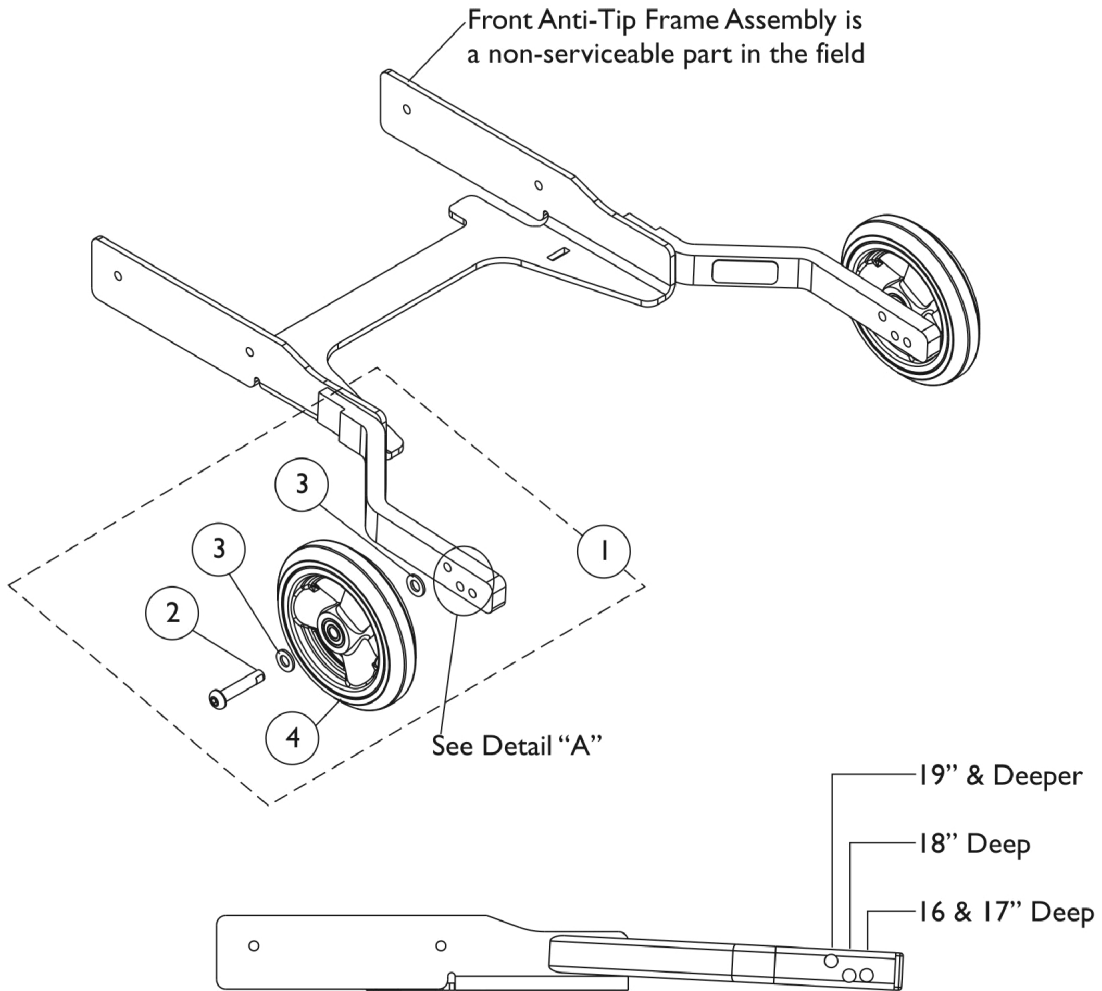

Detail "A"
Anti-Tip Wheel Placement

Anti-Tip Assembly - Front (After 8/1/11)

Non-serviceable parts in the field require the wheelchair to be returned to Invacare for repair. Call
Technical Services for assistance (1-800-832-4707)

Item Number	Note	Part Number	Description	Quantity Per	
				Package	Assembly
1	A	1176373	Kit, Anti-Tip Wheel Assembly and Hardware	1	1
2			Screw, Socket Button Head w/ Patch (M8 x 1.25 x 40mm)	1	1
3			NLA - Washer, Steel (8.4mm x 16mm x 1.6mm)	1	2
4			Wheel Assembly, Composite, Urethane (5" x 1")	1	1
NOTE: A - Includes items 2-4 and accommodates one side only.					