

# Forks and Hardware (Before 7/1/11)

(Upper hole on fork determines the lowest STF dimension)

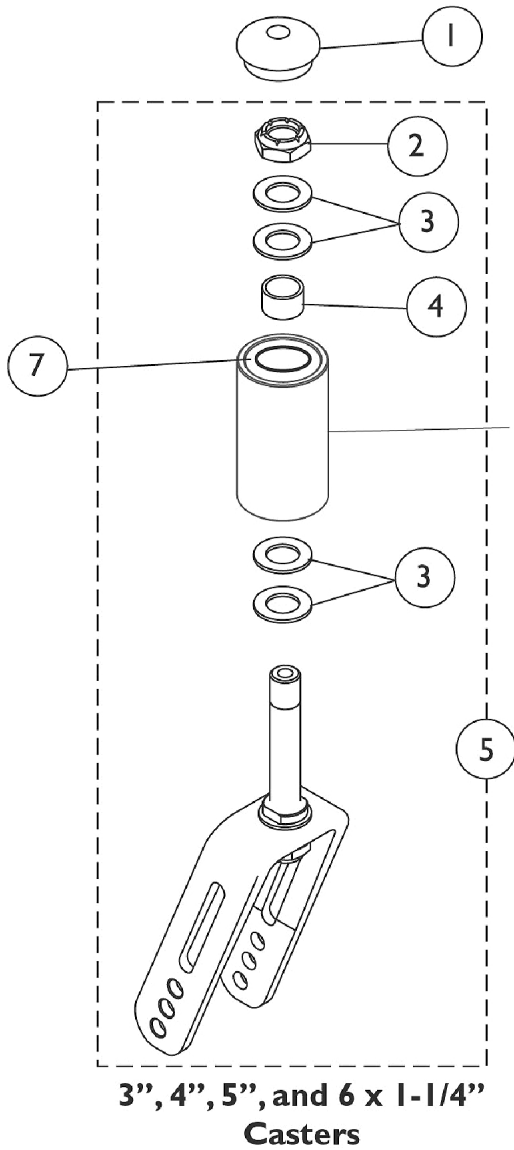

Headtube shown for reference only

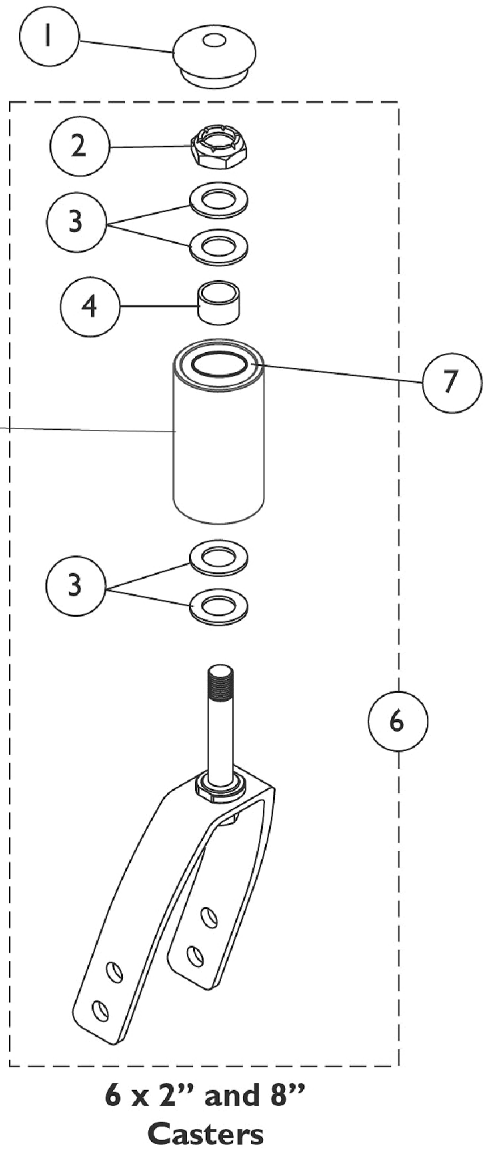

## Forks and Hardware (Before 7/1/11)

(Upper hole on fork determines the lowest STF dimension)

Item Number	Note	Part Number	Description	Quantity Per	
				Package	Assembly
1		1088523	Plug Button, Head Tube, Black	1	2
2		1025737	Locknut (1/2-20)	1	1
3		1026174	Washer (1/2 x 7/8 x 3/64")	1	2
4		1111931	Spacer (1/2 x 5/8 x 3/8")	1	1
5	A	1118545	Kit, Fork (5") w/ Short Stem	1	1
			NLA - Fork, Caster	1	1
			Stem, Fork, Short	1	1
2			Locknut (1/2-20)	1	2
3			Washer, Plain (1/2 x 7/8 x 1/16)	1	6
4			Spacer (1/2 x 5/8 x 3/8")	1	1
6	B	1118546	Kit, Fork Assembly w/ Hardware (6 x 2" - 8" Caster)	1	1
			Fork, Caster	1	1
			Stem, Fork, Short	1	1
2			Locknut (1/2-20)	1	2
3			Washer (1/2 x 7/8 x 3/64")	1	6
4			Spacer (1/2 x 5/8 x 3/8")	1	1
7		40117X021	Bearing (1/2" I.D. x 1-1/8" O.D.)	1	2
NOTE: A - For 3", 4", 5", and 6 x 1-1/4" Casters, includes Fork and items 2 - 4.					
B - For 6 x 2" and 8" Casters, Includes Fork and items 2 - 4.					