

Footrest Support Assemblies

60° and 70°

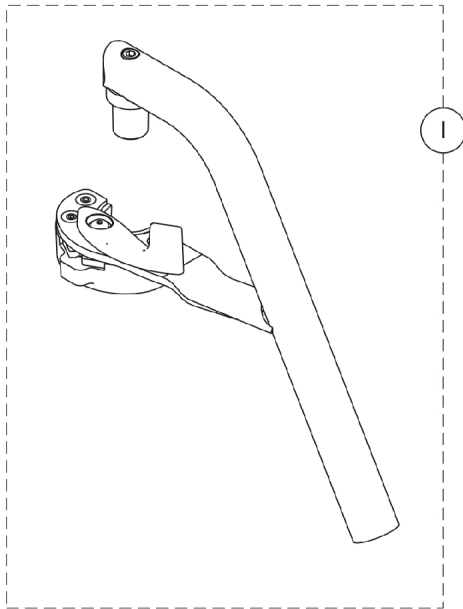

**60° Non-Tapered
Footrest Support Assembly**

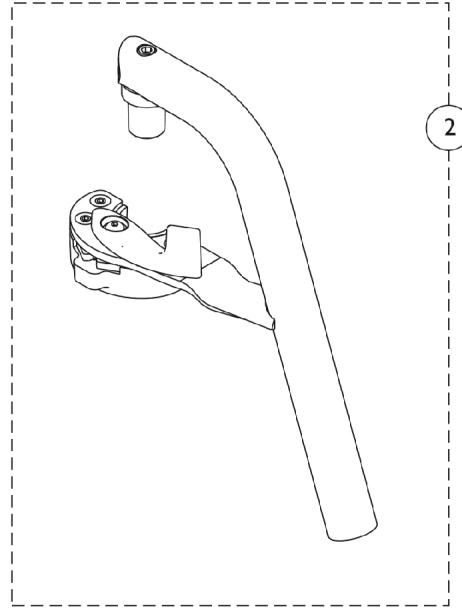

**70° Non-Tapered
Footrest Support Assembly**

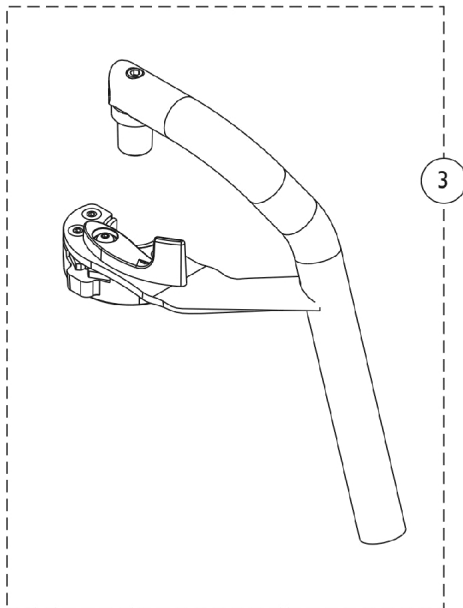

**70° Tapered
Footrest Support Assembly**

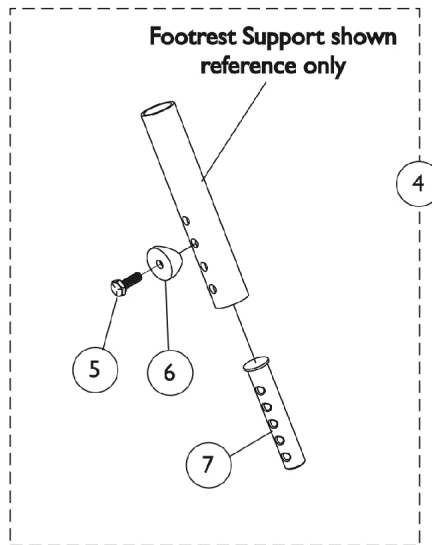

**Slide Tube Mounting
Hardware**

Footrest Support Assemblies 60° and 70°

Item Number	Note	Part Number	Description	Quantity Per	
				Package	Assembly
1	A	8881128078	Footrest Support Assembly, 60 Degree Non-Tapered, Sector, Color - Right	1	1
1	A	8881128079	Footrest Support Assembly, 60 Degree Non-Tapered, Sector, Color - Left	1	1
2	A	8881127737	Footrest Support Assembly, 70 Degree Non-Tapered, Sector, Color - Right	1	1
2	A	8881127738	Footrest Support Assembly, 70 Degree Non-Tapered, Sector, Color - Left	1	1
3	A	8881130500	Footrest Support Assembly, 70 Degree Tapered, Sector, Color - Right	1	1
3	A	8881130501	Footrest Support Assembly, 70 Degree Tapered, Sector, Color - Left	1	1
4	B	1026703	Kit, Pivot/Slide Tube Mounting Hardware (Pair)	1	1
5		1045267	Screw, Hex Head w/ Patch (1/4-20 x 3/4")	1	1
6		1026099	Spacer, Coved (1/4 x 11/16 x 1/2")	1	1
7	C	1020534	Insert, Threaded	1	1

NOTE: A - Specify frame finish when ordering
B - Includes items 5-7
C - As of 8/15/03, the Threaded Insert was revised from 3 to 5 Holes. Threaded Insert is Backward Compatible and does not require ordering in Pairs.