

Motor, Transformer and Pendant AC/DC - U.S.

**Motor AC and Pendant
Before 10/13/97**

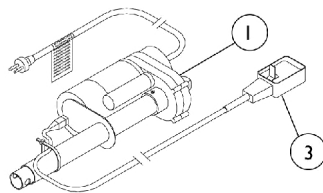

**Motor DC and Pendant
From 10/13/97 thru 11/8/98**

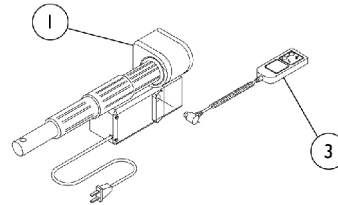

**Motor,Transformer, and Pendant
After 11/8/98**

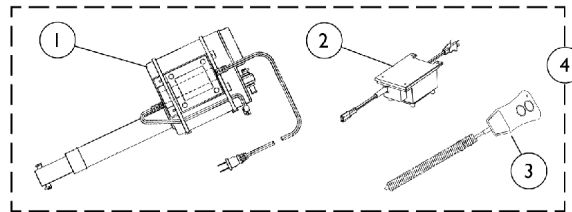

Item Number	Note	Part Number	Description	Quantity Per	
				Package	Assembly
1	H,A	52000M330-NLA	NLA - Motor Assembly Kit, AC (Includes: Motor, Pendant, and Instruction Sheet)	1	1
1	C,B	52000M335-NLA	NLA - Kit, Motor DC	1	1
1	D	52000M345-NLA	NLA - Kit, Motor, DC with Transformer (Includes: Hitch Pin, Clevis Pin, Washers, Cable Ties, and Instruction Sheet)	1	1
2	E	54000M801-NLA	NLA - Transformer, 115V US/Canada	1	1
3	A	54000M644-NLA	NLA - Pendant, AC with Key Switch	1	1
3	C,B	52000M356-NLA	NLA - Pendant, DC Motor	1	1
3	D,I	52000M347-NLA	NLA - Pendant, DC Motor - No Longer Available (Includes: Screws, Cable Ties, and Cable Clamps)	1	1
4		52000M348-NLA	NLA - Kit, Motor, Transformer and Pendant (Includes: Attaching Hardware and Instructions)	1	1
	F,G	52000M359-NLA	NLA - Kit, Transformer Replacement(Includes: Power Supply and Cable Ties)	1	1
	F	52000M354-NLA	NLA - Kit, Transformer Bracket (Includes: Linkage Plate, Washers, Screws, Bolts, Nuts, Cable Ties, and Instruction Sheet)	1	1

NOTE: A - Before 10/13/97
 B - Between 10/14/97 to 11/8/98
 C - Motor and Pendant are NLA, order item 4 Motor, Transformer, and Pendant kit.
 D - After 11/8/98
 E - After 12/15/98
 F - Not Shown
 G - When Ordering a Transformer Replacement Kit on chairs built before 12/15/98, a Transformer Bracket Kit should be ordered as well.
 H - Includes #53000M566.
 I - Pendant is no longer available. Order Item 4 - 52000M347 as replacement.