

9000SL Non-Removable Space Saver Fixed Height Arms

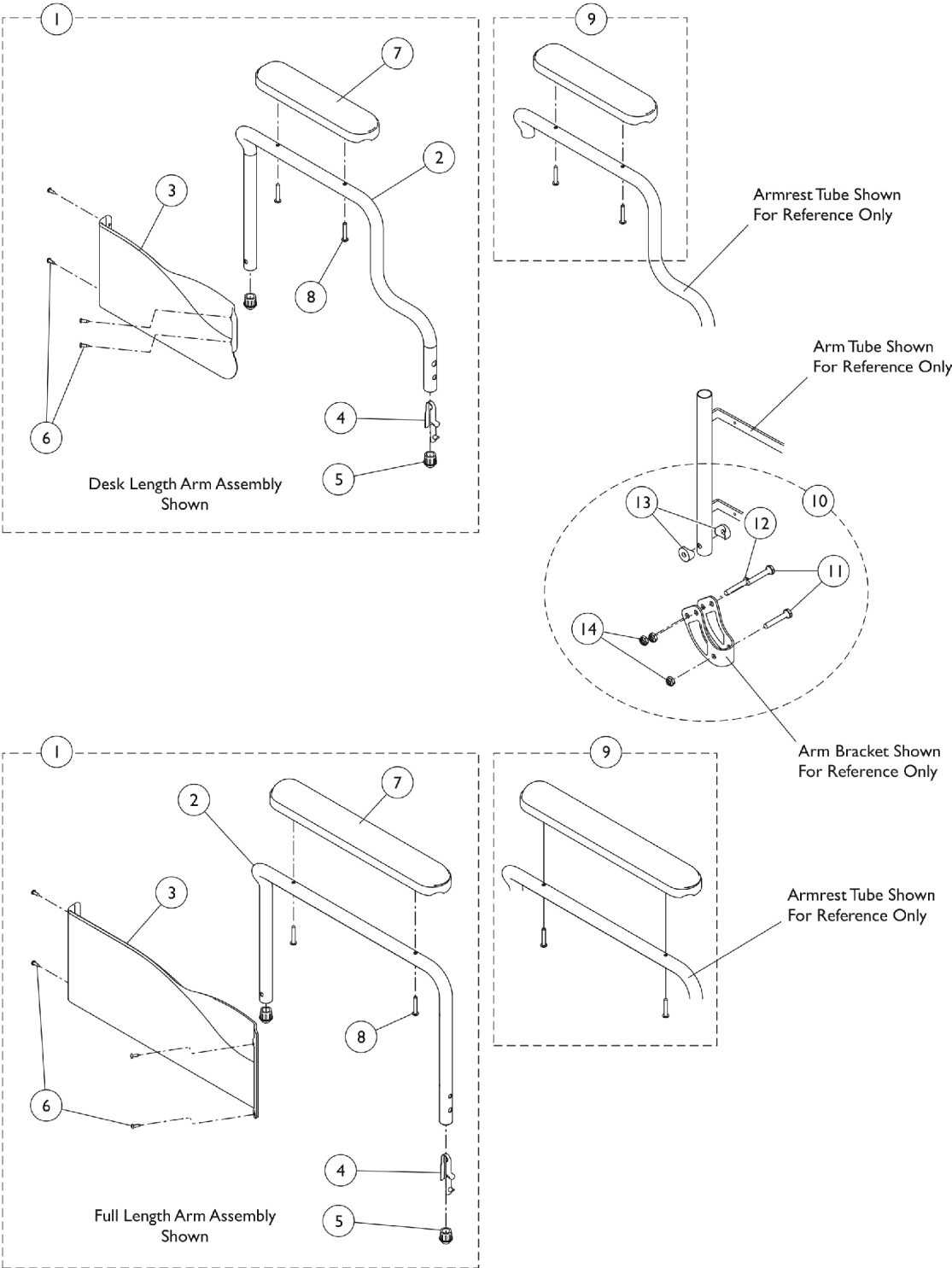

9000SL Non-Removable Space Saver Fixed Height Arms

Item Number	Note	Part Number	Description	Quantity Per	
				Package	Assembly
1	A,G,H	8881130858	Kit, Armrest, Desk Length, Black - Right (Style 88)	1	1
2			Tube, Armrest, Space Saver, Black - Right	1	1
3			Guard, Clothing, Desk Length - Right	1	1
4			Spring, Torsion w/ Button Lock	1	1
5			Plug, Armrest, Black (3/4") (18GA)	1	2
6			Screw, Self Tapping (#6-20 x 1/2")	1	4
7			Arm Pad, Desk Length w/ Law Label	1	1
8			Package, Screw Phillips Pan Head (#10-32 x 1-1/8")	1	2
3	A,G,H	1115269	Guard, Clothing, Desk Length - Right	1	1
6		1116900	Screw, Self Tapping (#6-20 x 1/2")	1	4
1		8881130859	Kit, Armrest, Desk Length, Black - Left (Style 88)	1	1
2			Tube, Armrest, Space Saver, Black - Left	1	1
3			Guard, Clothing, Desk Length - Left	1	1
4			Spring, Torsion w/ Button Lock	1	1
5			Plug, Armrest, Black (3/4") (18GA)	1	2
6			Screw, Self Tapping (#6-20 x 1/2")	1	4
7			Arm Pad, Desk Length w/ Law Label	1	1
8			Package, Screw Phillips Pan Head (#10-32 x 1-1/8")	1	2
3	A,H	1115270	Guard, Clothing, Desk Length - Left	1	1
6		1116900	Screw, Self Tapping (#6-20 x 1/2")	1	4
1		8881137325	Kit, Armrest, Full Length, Black - Right (Style 78)	1	1
2			Armrest, Space-Saver, Full, Black - Right	1	1
3			Guard, Clothing, Full Length - Right	1	1
4			Spring, Torsion w/ Button Lock	1	1
5			Plug, Armrest, Black (3/4") (18GA)	1	2
6			Screw, Self Tapping (#6-20 x 1/2")	1	4
7			NLA - Pad, Arm, Full Length w/ Law Label	1	1
8			Package, Screw Phillips Pan Head (#10-32 x 1-1/8")	1	2
3	A,H	1115271	Guard, Clothing, Full Length - Right	1	1
6		1116900	Screw, Self Tapping (#6-20 x 1/2")	1	4
1		8881137326	Kit, Armrest, Full Length, Black - Left (Style 78)	1	1
2			Armrest, Space-Saver, Full, Black - Left	1	1
3			Guard, Clothing, Full Length - Left	1	1
4			Spring, Torsion w/ Button Lock	1	1
5			Plug, Armrest, Black (3/4") (18GA)	1	2
6			Screw, Self Tapping (#6-20 x 1/2")	1	4
7			NLA - Pad, Arm, Full Length w/ Law Label	1	1
8			Package, Screw Phillips Pan Head (#10-32 x 1-1/8")	1	2
3	B,H	1115272	Guard, Clothing, Full Length - Left	1	1
6		1116900	Screw, Self Tapping (#6-20 x 1/2")	1	4
9		8881127509	Kit, Arm Pad w/Screws - Full Length	1	1
			NLA - Pad, Arm, Full Length w/ Law Label	1	1
			Package, Screw Phillips Pan Head (#10-32 x 1-1/8")	1	2
9		8881127510	Kit, Arm Pad w/Screws - Desk Length	1	1
			Arm Pad, Desk Length w/ Law Label	1	1
			Package, Screw Phillips Pan Head (#10-32 x 1-1/8")	1	2

9000SL Non-Removable Space Saver Fixed Height Arms

Item Number	Note	Part Number	Description	Quantity Per	
				Package	Assembly
10	C,D,E	1123307	Kit, Clothing Guard, Space Saver, Desk Length w/ Screws and Decals (Pair)	2	1
	C,D,E	1123308	Kit, Clothing Guard, Space Saver, Full Length w/ Screws & Decals (Pair)	2	1
	F	1091072	Hardware, Armrest	1	1
			Spacer, Coved (1/4 x 3/4 x 11/32")	1	4
			NLA - Screw, Socket Button Head (1/4-20 x 1-7/16")	1	2
			Screw, Hex Head (1/4-20 x 1-1/2")	1	4
14			Locknut (1/4-20)	1	6
NOTE: A - Includes items 2 - 8 for Desk Length Arms and items 2 - 8 for Full Length Arms. B - Includes Armpad and Screws. C - Not Shown. D - Due to clothing guard change, it is recommended (for chairs built before 11/25/03) when only one arm is requested, the appropriate clothing guard kit (item 7) be ordered also, so the arms will match. E - Includes items 3 and 6. F - Includes items 11 - 14. G - Invacare recommends ordering arm assemblies in pairs to assure uniform appearance on chair. H - Specify upholstery color when ordering. See page titled "Frame Finishes, Upholstery Colors, Decals and Packaging."					