

Vent Tray Assembly (FWD)

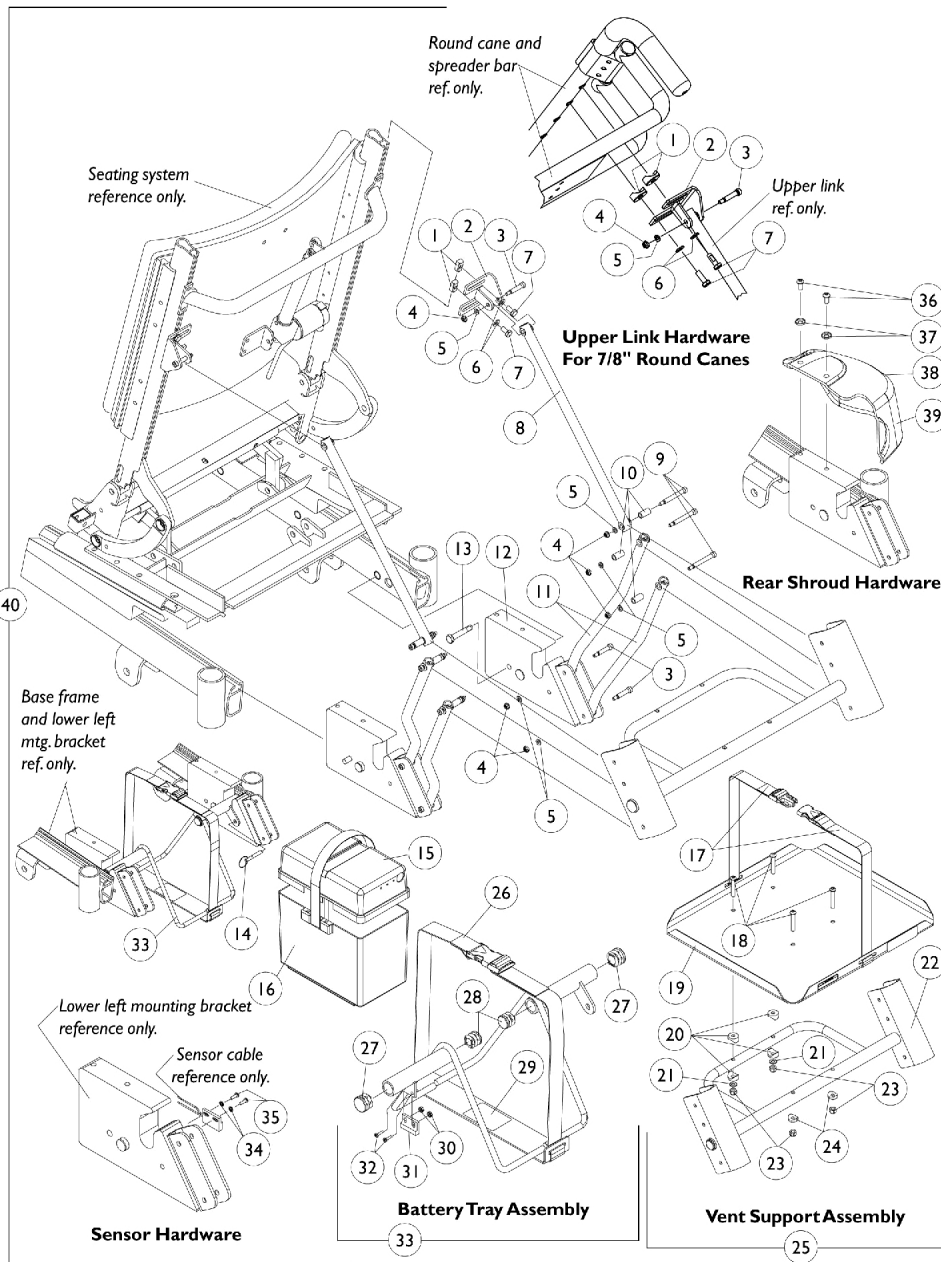

Vent Tray Assembly (FWD)

Item Number	Note	Part Number	Description	Quantity Per	
				Package	Assembly
1	B	1082699	T-Nut (1/4-20)	1	4
1	C	1082908-NLA	NLA - Spacer, Coved (5/16 x 29/32 x 7/16")	1	4
2		1097191-NLA	NLA - Bracket, Upper Link, Black	1	2
3		1098289-NLA	NLA - Screw, Shoulder Hex Socket Head (1/4 x 1", #10-24)	1	6
4		1026035-NLA	NLA - Locknut (#10-24)	1	12
5		1095360-NLA	NLA - Washer, Steel (7/8 x 3/8 x 1/16")	1	12
6		1026907	Washer (1/4 x 1/2 x 1/16")	1	4
7	B	1078214	Screw, Hex Head w/ Patch (1/4-20 x 1/2")	1	4
7	C	1045267	Screw, Hex Head w/ Patch (1/4-20 x 3/4")	1	4
8		1097294-NLA	NLA - Upper Link Assembly, Black	1	2
9		1030957-NLA	NLA - Screw, Shoulder Hex Socket Head (1/4 x 1-3/4", #10-24)	1	6
10		1098553-NLA	NLA - Sleeve (1/4 x 1/16 x 3/4")	1	6
11		1098563-NLA	NLA - Lower Link Assembly, Black	1	4
12		1098699-NLA	NLA - Bracket, Lower Link Mounting, Black - Right	1	1
12		1098700-NLA	NLA - Bracket, Lower Link Mounting, Black - Left	1	1
13		1043627-NLA	NLA - Screw, Hex Head w/ Patch (5/16-18 x 1-3/4")	1	2
14		1071602-NLA	NLA - Pin, Anchor (Captain Seat)	1	2
15		1095747	Top, Battery Box	1	1
16		1057944	Battery Box Bottom with Strap, 22NF	1	1
17		1049846	Strap Assembly, Battery	1	1
18		1008495	Screw, Socket Button Head (1/4-20 x 1-1/2")	1	4
19		1098304-NLA	NLA - Vent Tray w/ Strap	1	1
20		1025457	Spacer, Coved (1/4 x 3/4 x 11/32")	1	4
21		1026907	Washer (1/4 x 1/2 x 1/16")	1	2
22		1098303-NLA	NLA - Support, Vent	1	1
23		7930333	Locknut (1/4-20)	25	1
24		1026099	Spacer, Coved (1/4 x 11/16 x 1/2")	1	2
25	D	1098959-NLA	NLA - Vent Support Assembly	1	1
26		1098875-NLA	NLA - Strap Assembly, Battery	1	1
27		1027095	Plug Button, Black (7/8")	1	2
28		1027097	Plug Button, Black (3/4")	1	2
29		1098335-NLA	NLA - Decal, Warning	1	1
30		P0870X000	Nut, Hex Keps (#4-40)	1	2
31		1024001	Sensor, Actuator Switch	1	1
32		1074128	Screw, Phillips Pan Head (#4-40 x 7/16")	1	2
33	E	1098876-NLA	NLA - Battery Tray w/ Strap Assembly	1	1
34		1008525-NLA	NLA - Washer, Internal Tooth Lock (#4-40)	1	2
35		1025116-NLA	NLA - Screw, Slotted Hex Washer Head Tap (#4-3/8")	1	2
36		1006773-NLA	NLA - Screw, Socket Button Head (1/4-20 x 1/2")	1	2
37		1070581-NLA	NLA - Washer, Nylon Cupped (9/32 x 19/32 x 3/32")	1	2
38		1095489	Decal, Invacare 3-D Logo (2-1/2" L)	1	1
39		1100706-NLA	NLA - Shroud with Decal, Liquid Black - Rear/ Right	1	1
39		1100707-NLA	NLA - Shroud with Decal, Liquid Black - Rear/ Left	1	1
39		1100708-NLA	NLA - Shroud with Decal, Emerald Green - Rear/ Right	1	1

Vent Tray Assembly (FWD)

Item Number	Note	Part Number	Description	Quantity Per	
				Package	Assembly
39		1100709-NLA	NLA - Shroud with Decal, Emerald Green - Rear/ Left	1	1
39		1100710-NLA	NLA - Shroud with Decal, Ocean Blue - Rear/ Right	1	1
39		1100711-NLA	NLA - Shroud with Decal, Ocean Blue - Rear/ Left	1	1
39		1100712-NLA	NLA - Shroud with Decal, Candy Apple Red - Rear/ Right	1	1
39		1100713-NLA	NLA - Shroud with Decal, Candy Apple Red - Rear/ Left	1	1
40	F	1099960-NLA	NLA - Kit, Vent Tray, Liquid Black	1	1
40	F	1099961-NLA	NLA - Kit, Vent Tray, Emerald Green	1	1
40	F	1099962-NLA	NLA - Kit, Vent Tray, Ocean Blue	1	1
40	F	1099963-NLA	NLA - Kit, Vent Tray, Candy Apple Red	1	1
	A,G	1098336-NLA	NLA - Instruction Sheet, Vent Tray Assembly Kit	1	1
<p>NOTE: A - Not Shown B - For Extruded Back Canes C - For 7/8" Round Back Canes D - Includes Items 17-24 E - Includes Items 26-32 F - Includes Items 1-39 and Instruction Sheet G - Item is no longer available from the Invacare Service Parts Department. Refer to the Invacare Website under "Product Literature Search". Enter the part number in the "Keywords" field and download a free PDF version copy.</p>					