

Pull Tube & Crank Handle

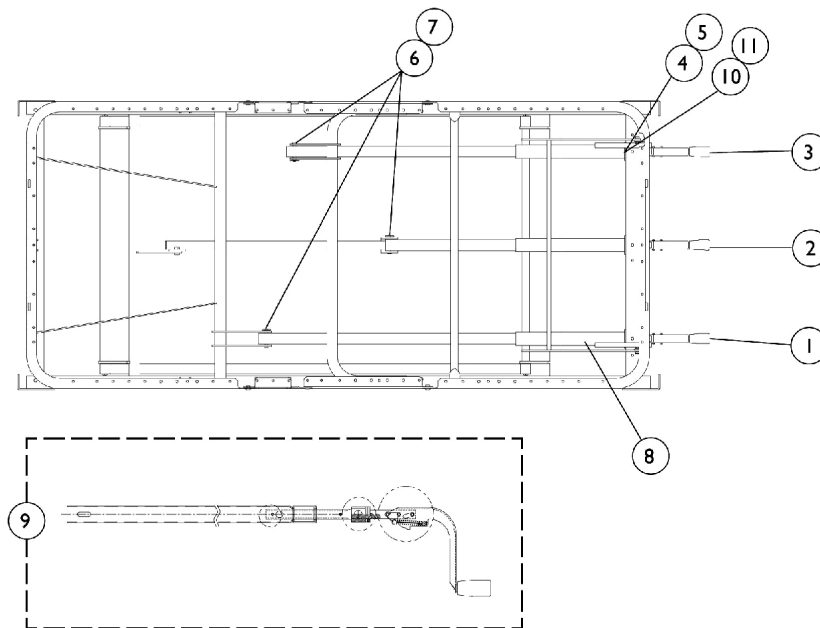

Item Number	Note	Part Number	Description	Quantity Per	
				Package	Assembly
1	A	1113799-NLA	NLA - Head Crank & Pull Tube Assembly, Manual	1	1
2	A,B	026541-NLA	NLA - Hi/Lo Crank & Pull Tube Assembly, Manual	1	1
2	A,C	1113748-NLA	NLA - Hi/Lo Crank & Pull Tube Assembly, Manual	1	1
3	A	1113701-NLA	NLA - Foot Crank & Pull Tube Assembly, Manual	1	1
4		001008	Washer, Split Lock (5/16")	1	6
5		001741	Screw, Hex Head (5/16-18 x 3/4")	1	6
6		005952	Pin, Clevis (5/16 x 2-1/8")	1	3
7		51000M743	Pin, Hitch (3/8 x 1-3/16")	1	3
8		51000M191	Cover, Pull Tube (Head/Foot)	1	3
9		026983	Kit, Crank Handle Includes: 3 ea. Spring Pins (1/4 x 1-1/4"), 1 ea. Spring Retainer, 1 ea. Spring Retainer, 1 ea. Spring Extension, 1 ea. Spring Pin (3/16 x 1"), and 1 ea. Crank Handle Assembly.	1	1
10		001443	Bushing, Shoulder - Pivot	1	6
11		001405	Bushing, Flanged, Nylon	1	6

NOTE: A - Includes: Item 9.
B - Before 7/26/99.
C - After 7/25/99.