

# Back Cane & Spreader Bar Assembly

## Recline Only (2GR) and Tilt/ Recline (2GTR)

**NOTE:** When changing back cane heights, new back assembly attaching hardware may be required.

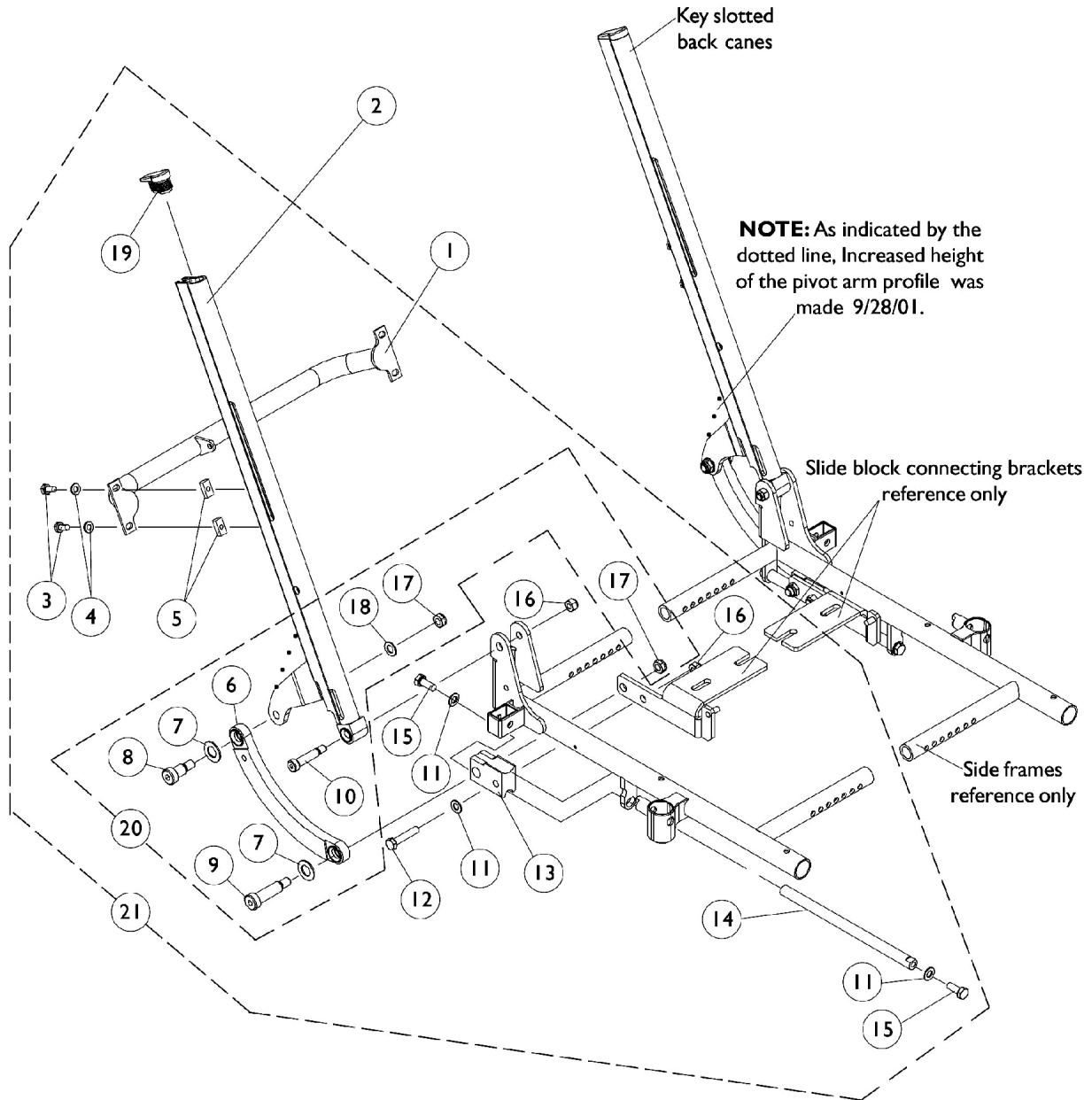

# Back Cane & Spreader Bar Assembly

## Recline Only (2GR) and Tilt/ Recline (2GTR)

**NOTE: When changing back cane heights, new back assembly attaching hardware may be required.**

### #1 Spreader Bar

16"W	17"W	18"W	19"W	20"W	21"W	22"W
1086101-NLA	See Note See Note(s) A	1086103-NLA	See Note See Note(s) A	See Note See Note(s) A	1086106-NLA	See Note See Note(s) A
NOTE: A - Parts are no longer available as a service part.						

### #2 Back Canes

#### Back Height

	20-21"H	22-23"H	24-25"H	26-27"H	28"H
Right	1086948-NLA	1086950-NLA	1086952-NLA	1086954-NLA	1086956-NLA
Left	1086949-NLA	1086951-NLA	1086953-NLA	1086955	1086957-NLA
NOTE: Chairs manufactured between November 2, 1999 and January 31, 2002 were subject to a field correction. Contact your Dealer to make sure this has been done.					

# Back Cane & Spreader Bar Assembly

## Recline Only (2GR) and Tilt/ Recline (2GTR)

**NOTE: When changing back cane heights, new back assembly attaching hardware may be required.**

Item Number	Note	Part Number	Description	Quantity Per	
				Package	Assembly
1		See Chart	#1 Spreader Bar	1	1
2		See Chart	#2 Back Canes	1	2
3		1078214	Screw, Hex Head w/ Patch (1/4-20 x 1/2")	1	4
4		1026907	Washer (1/4 x 1/2 x 1/16")	1	4
5		1082699	T-Nut (1/4-20)	1	4
6	C	1086587-NLA	NLA - Link, Curved, Black	1	2
7		1031673-NLA	NLA - Washer, Nylon (35/64 x 1 x 1/16")	1	4
8		1086323-NLA	NLA - Screw, Shoulder Hex Socket Head (1/2 x 5/8", 3/8-16)	1	2
9		1021851-NLA	NLA - Bolt, Socket Head Shoulder (1/2 x 1-1/2")	1	2
10		1062604	Screw, Shoulder Hex Socket (3/8 x 1-1/4", 5/16-18)	1	2
11		1025704	Washer, Flat (5/16 x 5/8 x 1/16")	1	6
12		1070398-NLA	NLA - Screw, Hex Head (5/16-18 x 1-1/2")	1	2
13		1082725-NLA	NLA - Block, Slide	1	2
14		1082724-NLA	NLA - Rod, Slide	1	2
15		1039860	Screw, Hex Head w/ Patch (5/16-18 x 3/4")	1	2
16		1026158	Locknut (5/16-18)	1	4
17		40363X000	Hex Nut (3/8"-16)	1	4
18		1065214	Washer, Flat (3/8 x 11/16 x 1/16")	1	2
19		1082829-NLA	NLA - Plug Button, Back Cane, Black	1	2
20	B	1099948-NLA	NLA - Kit, Curved Link Upgrade, 2GR and 2GTR	2	1
21	D	1087001-NLA	NLA - Kit, Back Cane and Spreader Bar Mounting Hardware	2	1
	A,E	1098332-NLA	NLA - Instruction Sheet, Curved Link Upgrade Kit	1	1

NOTE: A - Not Shown  
 B - Includes Items 6-9, 17, 18 and Instruction Sheet  
 C - Due to product improvement the curved link changed from aluminum to steel as of 3/20/00. It is recommended that (item 20) curved link upgrade kit be ordered for systems made before 3/20/00.  
 D - Includes items 3-19  
 E - Item is no longer available from the Invacare Service Parts Department. Refer to the Invacare Website under "Product Literature Search". Enter the part number in the "Keywords" field and download a free PDF version copy.