

Back Cane Assembly - Chairs w/ Rocker Back (DROCK) Option

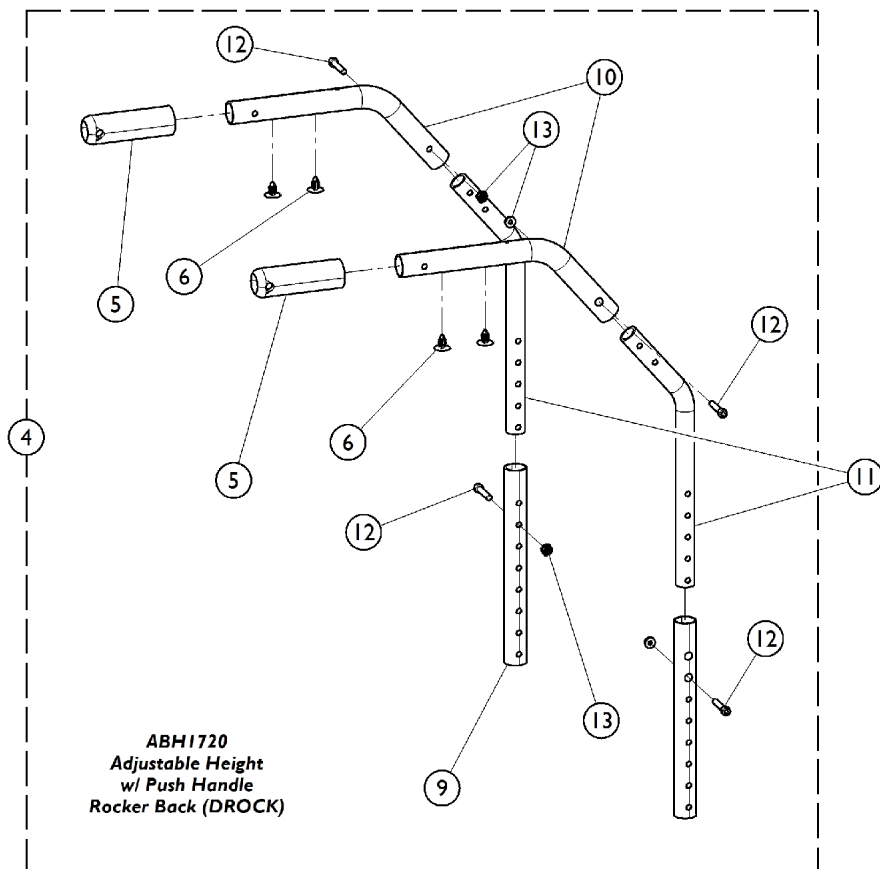
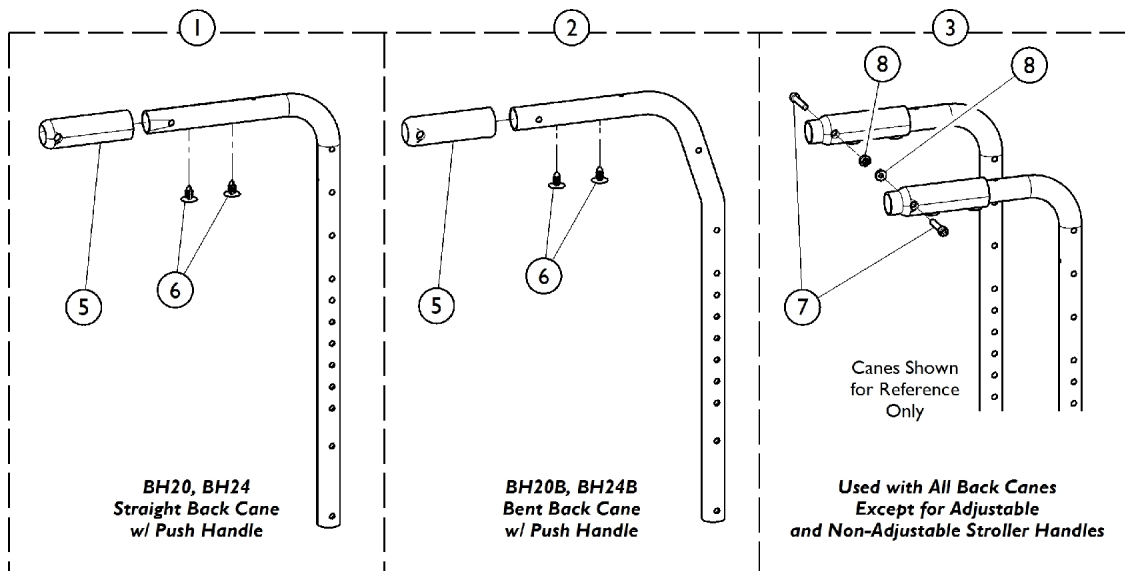

Back Cane Assembly - Chairs w/ Rocker Back (DROCK) Option

Item Number	Note	Part Number	Description	Quantity Per	
				Package	Assembly
1	A	See Chart	#1. Straight Back Cane w/ Push Handle (BH20, BH24)	1	2
2	A	See Chart	#2. Bent Back Cane w/ Push Handle (BH20B, BH24B)	1	2
3	B	1166103	Kit, Grip Retaining Hardware	1	1
7			Screw, Socket Head (1/4-28 x 1-1/4")	1	2
8			Locknut (1/4-28)	1	2
4	C	1170184	Adjustable Height Cane Assembly (Pair)	1	1
5			Grip, Hand, Foam (4")	1	2
6			Panel Fastener, Snap In	1	4
9			Tube, Receiver Cane, Adjustable Height, Black	1	2
10			Handle, Push - Right	1	1
10			Handle, Push - Left	1	1
12			Screw, Socket Head (1/4-28 x 1-1/4")	1	4
13			Locknut, Thin (1/4-28)	1	4
11		1134187	Tube, Cane, Adjustable Height, Black (16 - 20")	1	2
NOTE: A - Includes the Back Cane and items 5 (Grip) and 6 (Snap In Fastener). B - Includes items 7 and 8. Used with all cane assemblies except for Stroller Handles. C - Includes items 5, 6, 9, 10, 12, and 13.					

#1. Straight Back Cane w/ Push Handle (BH20, BH24)

Back Type	BH20 Straight Cane	BH24 Straight Cane
Rocker w/ SCANE (DROCK, SPACK)	1170180	1170181

#2. Bent Back Cane w/ Push Handle (BH20B, BH24B)

Back Type	BH20B Bent Cane	BH24B Bent Cane
Rocker Back w/ SCANE (DROCK, SPACK)	1170182	1170183