

# Back Mounting Hardware

## Metal Curved (16" - 22" Wide)

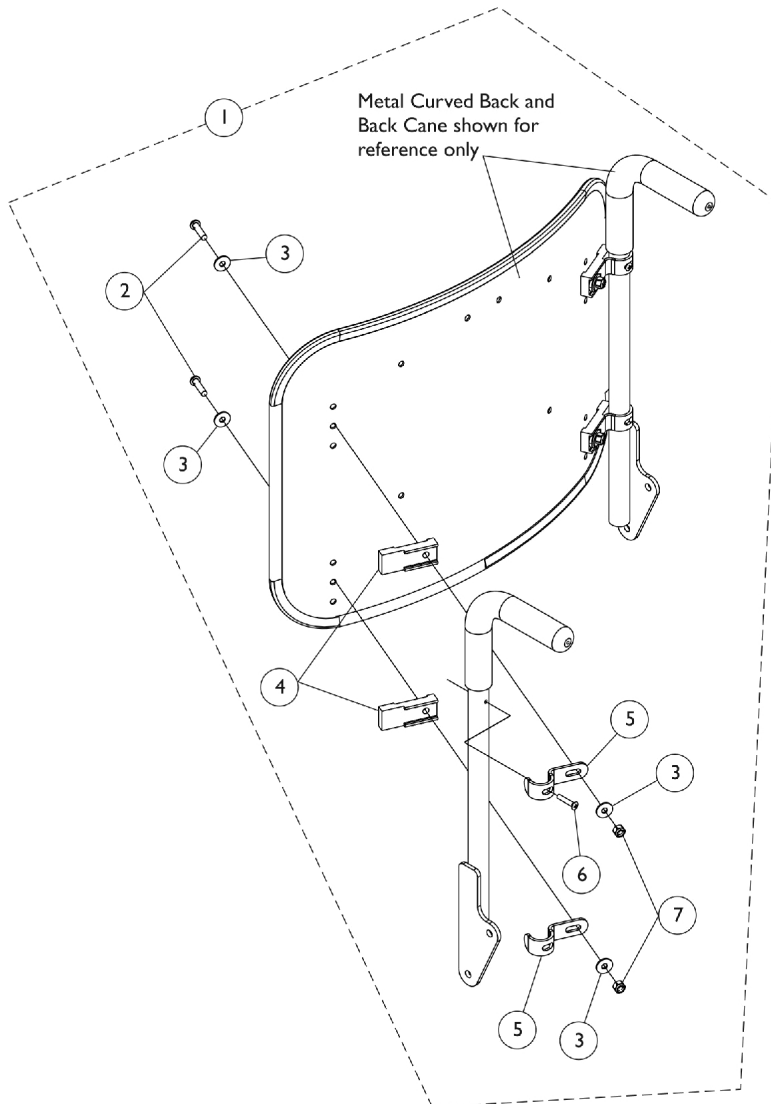

| Item Number | Note | Part Number | Description   | Quantity Per |          |
|-------------|------|-------------|---|--------------|----------|
|             |      |             |   | Package      | Assembly |
| 1           | A    | 1157925     | Kit, Metal Curved and Curve Contoura Back Mounting Hardware | 1            | 1        |
| 2           |      |             | Screw, Socket Button Head (1/4-20 x 1")                     | 1            | 4        |
| 3           |      |             | Washer (1/4 x 23/32 x 1/16")                                | 1            | 8        |
| 4           |      |             | Spacer, Back Pan, Black                                     | 1            | 4        |
| 5           |      |             | Hook, Back Assembly Mounting                                | 1            | 4        |
| 6           |      |             | NLA - Screw, Phillips Oval Head (#10-16 x 7/8")             | 1            | 2        |
| 7           |      |             | Locknut (1/4-20)  | 1            | 4        |

NOTE: A - Includes items 2-7