

Rollator (Three Wheeled)
Model 65400 - Sprint (Discontinued 6/07)

Model 65400 (Sprint)
Blue Finish

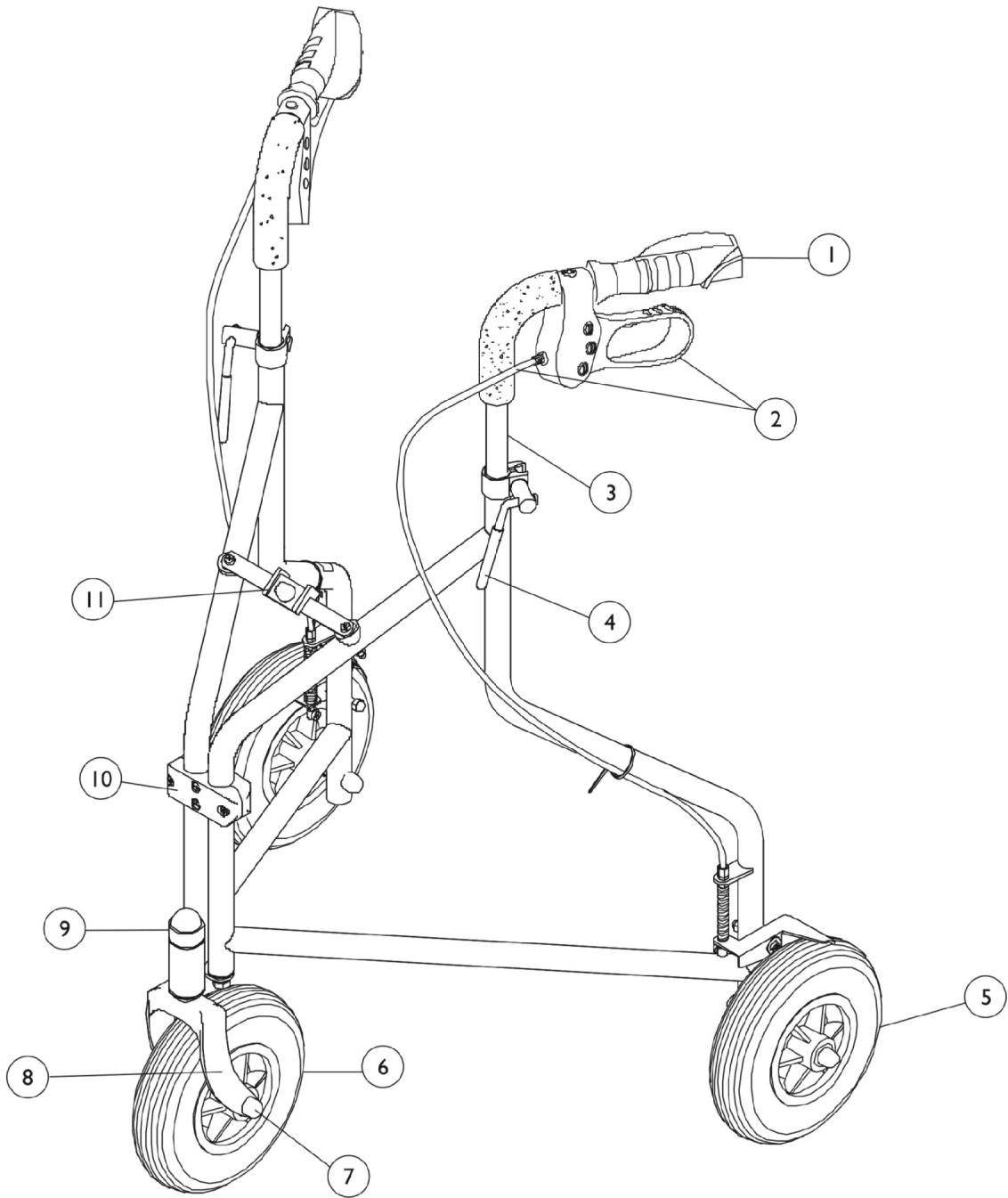

Rollator (Three Wheeled) Model 65400 - Sprint (Discontinued 6/07)

Item Number	Note	Part Number	Description	Quantity Per	
				Package	Assembly
1		1076186	Grips, Hand	2	1
2	A,B,M	1076194-NLA	NLA - Kit, Hand Brake - Left	1	1
2	A,B,M	1076195-NLA	NLA - Kit, Hand Brake - Right	1	1
2	C,D,E, N	1096767-NLA	NLA - Kit, Hand Brake - Right / Left	1	2
3	F	1076192-NLA	NLA - Kit, Cane Assembly - Left	1	1
3	F	1076193-NLA	NLA - Kit, Cane Assembly - Right	1	1
4	G	1076191-NLA	NLA - Lever, Hand, Adjustable	1	2
5	H	1076197-NLA	NLA - Kit, Rear Wheel	1	2
6	I	1076171-NLA	NLA - Kit, Wheel	1	1
7		1082534-NLA	NLA - Cap, Plastic, Black	8	1
8		1094533-NLA	NLA - Fork, Front	1	1
9		1094538-NLA	NLA - Cap, Plastic, Black	1	1
10	J	1094531-NLA	NLA - Brace, Front Lower	1	1
11	K	1094532-NLA	NLA - Link, Pivot	1	1
	L	65404	NLA - Bag, Tote	1	1

NOTE: A - Cable Style.
 B - Before 11/7/00.
 C - Loop Style.
 D - After 11/8/00.
 E - Due to style change, when replacing Hand Brake and Cable "Before 3/7/00" you must also replace Hand Grips.
 F - Includes Cane, Foam Sleeve and Items 1 and 2.
 G - Includes Bolt, Washer and Lever.
 H - Includes Caster, Bearing, Spacer, Screw and Caps.
 I - Includes Caster, Bearing, Spacer, Nut, Screw and Caps.
 J - Includes Front/Back Block, Screws and Nuts.
 K - Includes Top/Bottom Arm, Screw and Washer.
 L - Not Shown.
 M - Includes Hand Brake, Brake Wire, Cable Assembly and Instruction Sheet.
 N - Includes Brake Holder, Cable, Brake Wire, Handle, Hardware and Instruction Sheet.