

Front Rigging Hanger Assembly (Includes Clamp-On Sector Blocks for SCLAMP Option)

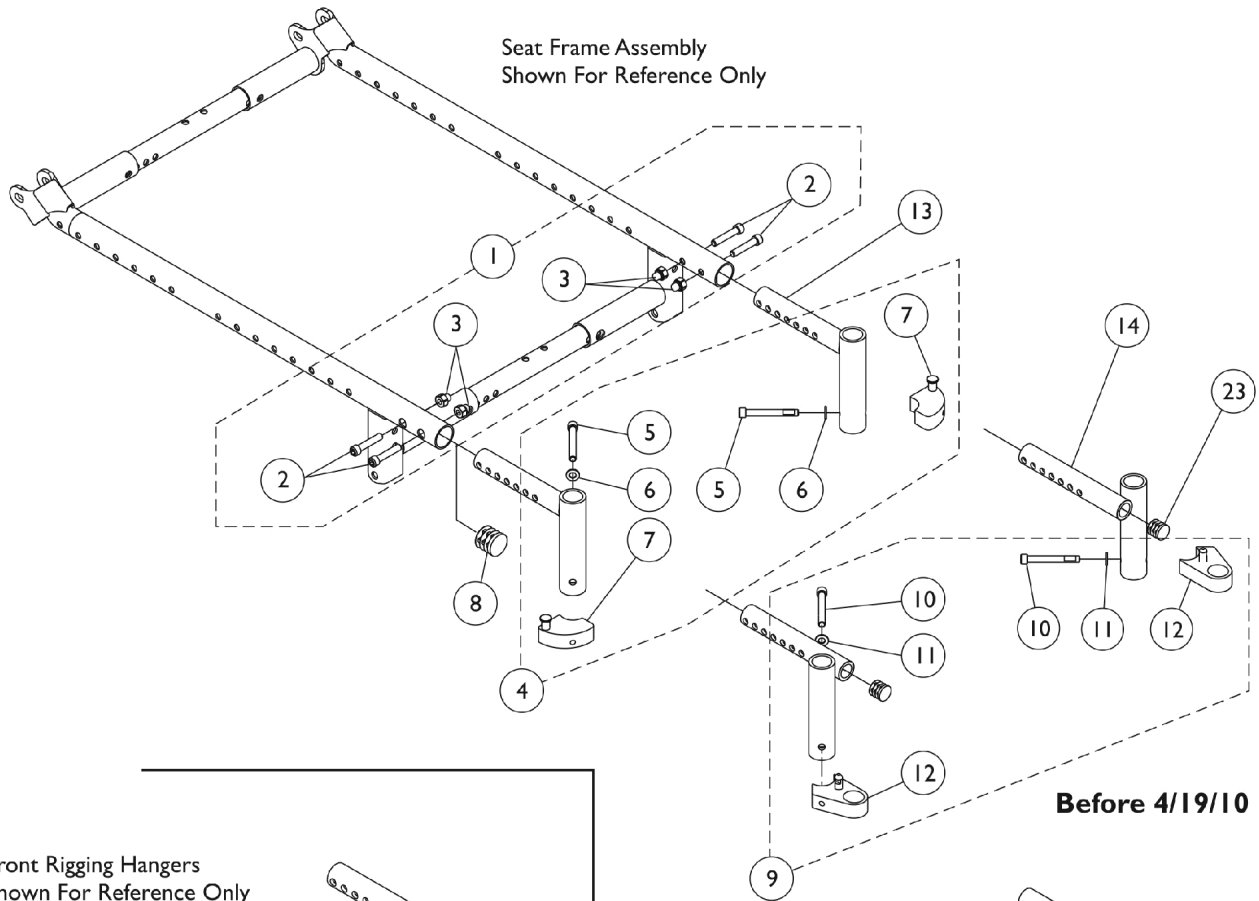

Before 4/19/10

Front Rigging Hangers
Shown For Reference Only

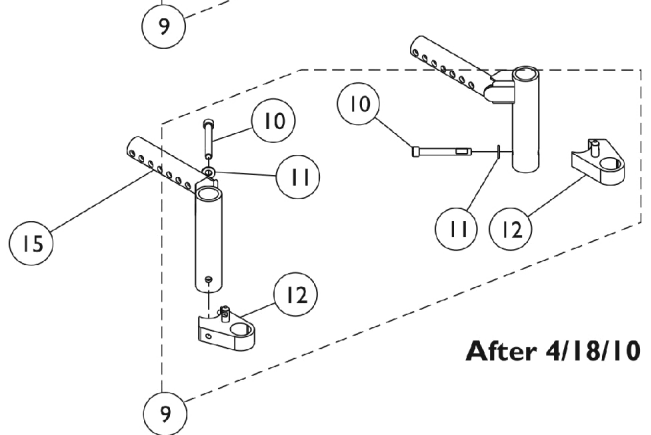
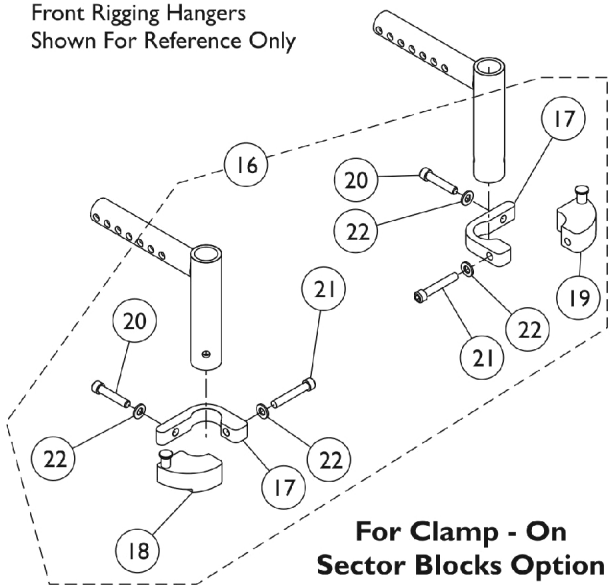

After 4/18/10

Front Rigging Hanger Assembly

(Includes Clamp-On Sector Blocks for SCLAMP Option)

Item Number	Note	Part Number	Description	Quantity Per	
				Package	Assembly
1	A	1164119	Kit, Front Rigging Hanger Mounting Hardware (Pair)	1	1
2			Screw, Socket Head (1/4-28 x 1-1/4")	1	4
3			Nut, Hex Nylon (1/4-28)	1	4
4	B,F	1054866	Kit, Sector Block Hardware (Pair)	1	1
5			Screw, Socket Head w/ Patch (1/4-20 x 2")	1	2
6			NLA - Washer, Steel (1/4 x 1/2 x 3/64")	1	2
7			NLA - Block, Sector - Right	1	1
7			NLA - Block, Sector - Left	1	1
8	C	1127676	Package, Plug Button, Black (1")	10	1
9	D,F	1142975	Kit, Sector Block Hardware, Lift Off (Pair)	1	1
10			Screw, Socket Head (1/4-20 x 1-3/4")	1	2
11			NLA - Washer, Steel (1/4 x 1/2 x 3/64")	1	2
12			Block, Sector - Right	1	1
12			Block, Sector - Left	1	1
13		1150882	Tube, Support, Front Rigging Hanger, Black - Left	1	1
13		1150881	Tube, Support, Front Rigging Hanger, Black - Right	1	1
14	G	1154025	Tube, Support, Front Rigging Hanger, Offset, Black - Right	1	1
14	G	1154026	Tube, Support, Front Rigging Hanger, Offset, Black - Left	1	1
15	H	1165562	Tube, Support, Front Rigging Hanger, Offset, Black - Right	1	1
15	H	1165563	Tube, Support, Front Rigging Hanger, Offset, Black - Left	1	1
16	E,F	1166097	Kit, Clamp-On Sector Blocks w/ Hardware	1	1
17			Clamp, Sector Block	1	2
18			Sector Block, Clamp On - Left	1	1
19			Sector Block, Clamp On - Right	1	1
20			Screw, Socket Head (1/4-28 x 1-1/4")	1	2
21			NLA - Screw, Socket Head (1/4-28 x 1-1/2")	1	2
22			NLA - Washer, Steel (1/4 x 1/2 x 3/64")	1	4
23	C	1130583	Package, Plug Button, Black (5/8")	10	1

NOTE: A - Includes items 2 and 3.
 B - Includes items 5 thru 7.
 C - Plug Button used when Front Rigging Hanger Support Tube is not used.
 D - Includes items 10 thru 12.
 E - Includes items 17 thru 22.
 F - Item numbers 4, 9 or 16 Sector Block Hardware can be assembled to any Front Rigging Hanger Support Tube.
 G - Used on chairs manufactured before 4/12/10.
 H - Used on chairs manufactured after 4/11/10.