

Seat and Chest Positioning Straps Mounting Hardware

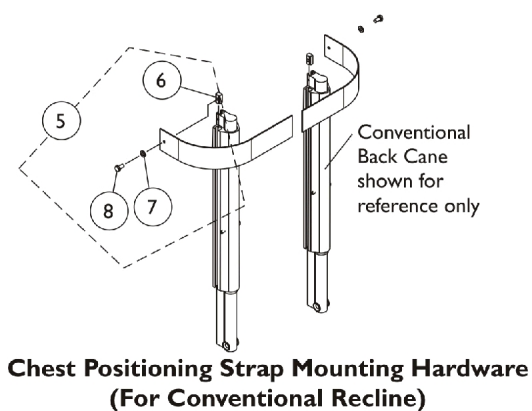
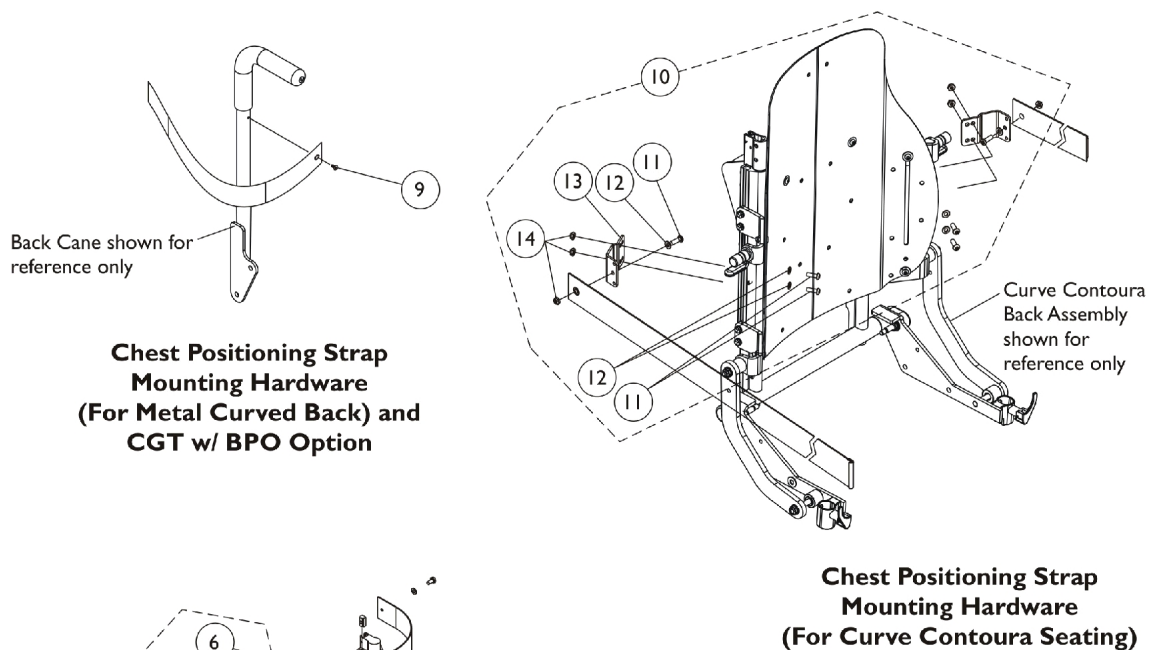
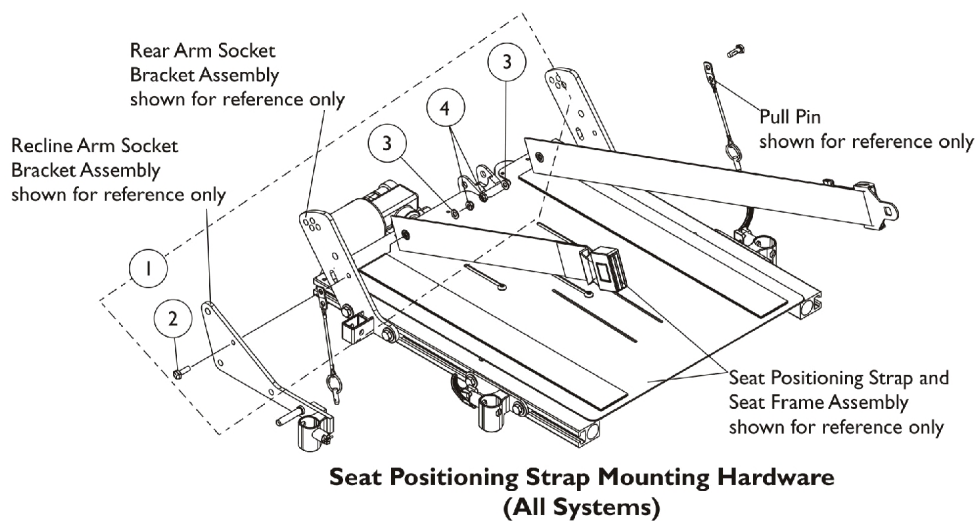

Seat and Chest Positioning Straps Mounting Hardware

Item Number	Note	Part Number	Description	Quantity Per	
				Package	Assembly
1	A	1124385	Kit, Seat Positioning Strap Mounting Hardware (both LT & RT sides)	1	1
2			Screw, Hex Head w/ Patch (1/4-20 x 3/4")	1	2
3			Washer (1/4 x 1/2 x 1/16")	1	2
4			Locknut (1/4-20)	1	2
5	B	1090212	Kit, Chest Positioning Strap Mounting Hardware For Conventional Seating	1	1
6			T-Nut (1/4-20)	1	2
7			Washer (1/4 x 23/32 x 1/16")	1	2
8			Screw, Hex Head w/ Patch (1/4-20 x 1/2")	1	2
9	C	1026298	Package, Screw with Washer (#10 x 7/8") (Pair)	2	1
10	D	1125798	Kit, Chest Positioning Strap's Mounting Hardware For Contoura Seating (both LT & RT sides)	1	1
11			Screw, Socket Button (1/4-20 x 3/4")	1	6
12			Washer (1/4 x 1/2 x 1/16")	1	6
13			Bracket, Positioning Strap, Black	1	2
14			Locknut (1/4-20)	1	6
NOTE: A - Includes items 2-4 B - Includes items 6-8 C - Used for Metal Curve Back and CGT with BPO Option D - Includes items 11-14					