

Crutches

Quick Change, Quick Adjust and Bariatric Crutch

Quick Change

Model 8115-A - Adult
Model 8115-J - Junior
Model 8115-T - Tall Adult

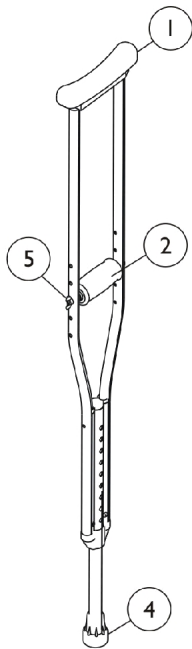

Quick Adjust

Model 8120-A - Adult
Model 8120-J - Junior
Model 8120-T - Tall Adult

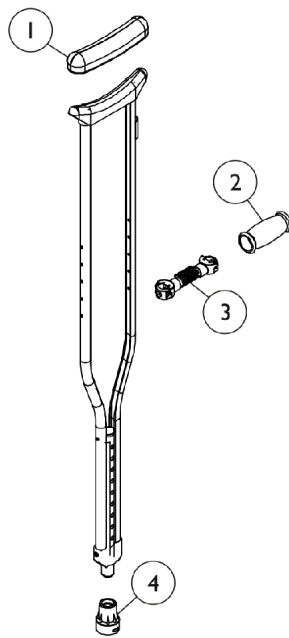

Bariatric Crutch

Model 8130-A - Adult
Model 8130-J - Junior
Model 8130-T - Tall Adult

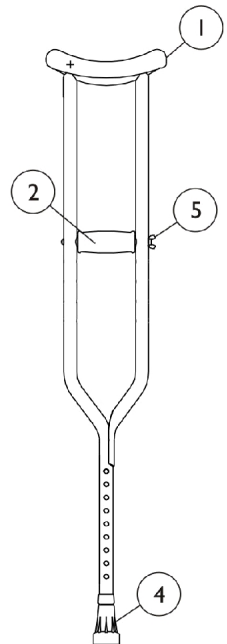

Crutches

Quick Change, Quick Adjust and Bariatric Crutch

Item Number	Note	Part Number	Description	Quantity Per	
				Package	Assembly
1	A,B,F	6131-NLA	NLA - Kit, Arm Pad, Grey Pad, Arm, Grey	1 2	1 1
1	C,F	7131-NLA	NLA - Kit, Arm Pad, Grey Pad, Arm, Grey	1 2	1 1
2	A,G	6119	NLA - Kit, Hand Grip Open, Grey Grip, Hand, Grey, Open	1 2	1 1
2	B,E,G	6124	Kit, Hand Grip Open, Grey Grip, Hand, Grey	1 2	1 1
2	B,G	6125	Kit, Hand Grip Solid, Grey Grip, Hand, Grey	1 2	1 1
2	A,G	6126	Kit, Hand Grip Solid, Grey Grip, Hand, Grey, Closed	1 2	1 1
2	C,G	7126	Kit, Hand Grip Solid, Grey Grip, Hand, Grey	1 2	1 1
3	B	1098970	Kit, Hand Grip, Grey Grip, Hand, Grey Handle, Crutch	1 1 1	1 1 1
4	A,B,D, H	6134-NLA	NLA - Kit, Tips Large Rubber, Grey (1-3/4" O.D. Base) Tip, Crutch, Grey - Large	1 2	1 1
4	C,H	6135-NLA	NLA - Kit, Tips Extra Large Rubber, Grey (2" O.D. Base) Tip, Crutch, Grey - Extra Large	1 2	1 1
5	I	1106801	NLA - Nut, Wing (1/4-20)	1	2
NOTE: A - To be used with Model 8115. B - To be used with Model 8120. C - To be used with Model 8130. D - Large rubber tips are standard for the Crutches. E - Has a slit for easy removal. F - Kit includes (2) Arm Pads. G - Kit includes (2) Hand Grips. H - Kit includes (2) Tips. I - Item no longer available, no replacement is available.					