

Back Canes w/o Push Handles

(LKDWN-Standard) Lock-Down, Folding Height/Angle Adjustable Back

When changing back heights you also need to change the backrest and the back upholstery.

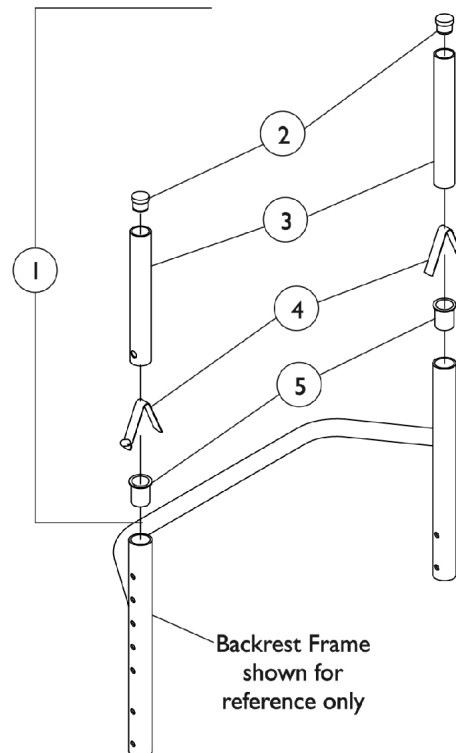

Item Number	Note	Part Number	Description	Quantity Per	
				Package	Assembly
1	A,B	1026971	Back Canes, Adjustable w/o Push Handle (8-11" H)	1	1
2			Plug Button, Black (3/4")	1	2
3			NLA - Tube, Insert, Adjustable Back (8 - 11" H)	1	2
4			Spring, Torsion w/ Button	1	2
5			Bushing, Pivot	1	2
1	A,C	1026972	Back Canes, Adjustable w/o Push Handle (10-14"/16-20" H)	1	1
2			Plug Button, Black (3/4")	1	2
3			NLA - Tube, Insert, Adjustable Back (10 - 20" H)	1	2
4			Spring, Torsion w/ Button	1	2
5			Bushing, Pivot	1	2

NOTE: A - Includes items 2-5
 B - 8-11" High Backs
 C - 10-14", 12-16", 14-18", and 16-20" High Backs