

Casters - 5"

THE PRODUCTION OF THE HTR IS CURRENTLY SUSPENDED AND SOME SERVICE PARTS MAY NOT BE AVAILABLE TO ORDER.

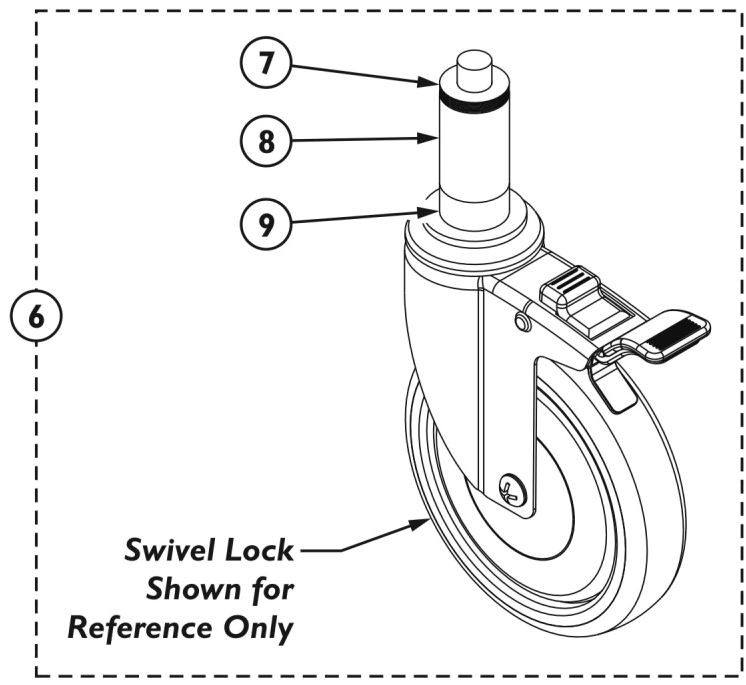
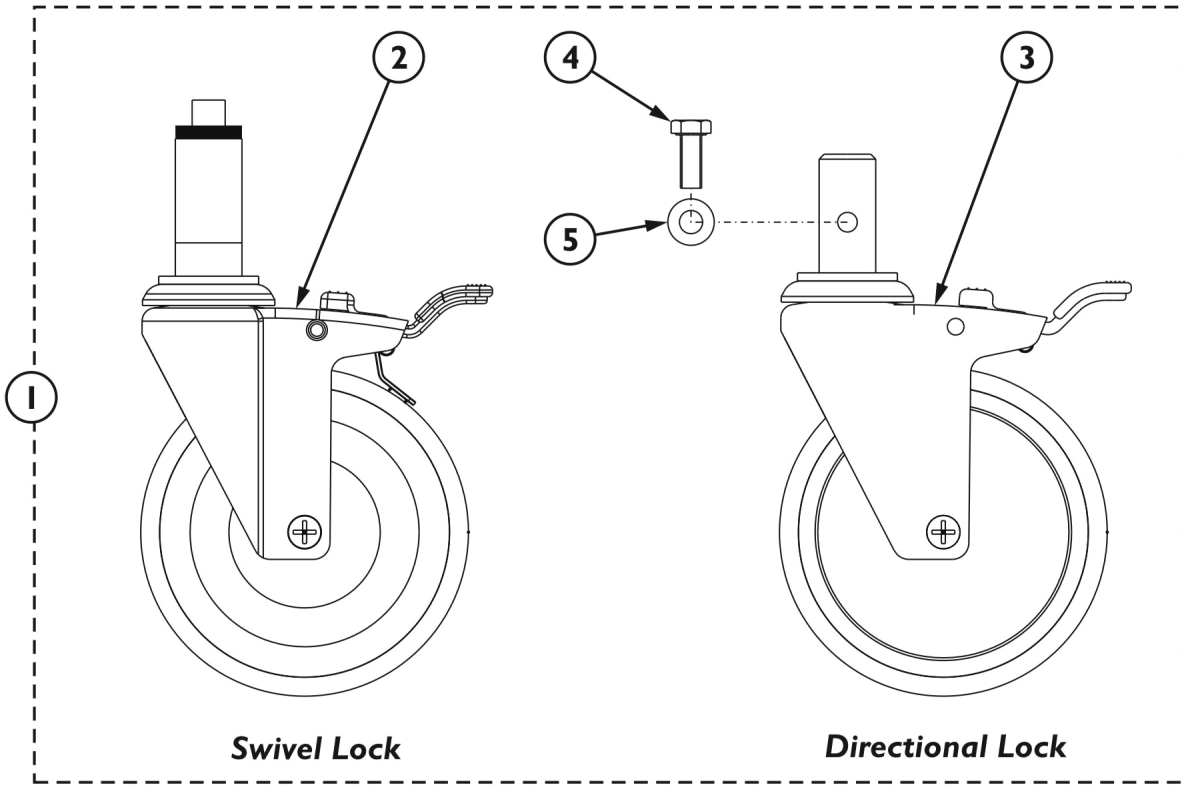

Casters - 5"

THE PRODUCTION OF THE HTR IS CURRENTLY SUSPENDED AND SOME SERVICE PARTS MAY NOT BE AVAILABLE TO ORDER.

Item Number	Note	Part Number	Description	Quantity Per	
				Package	Assembly
1	A	1140793-NLA	NLA - Kit, Wheel - HTR3000	1	1
2			Caster Assembly, Swivel Lock (5")	3	1
3			Caster Assembly, Directional Lock (5")	1	1
4			Screw (M8 x 1.25 x 20mm)	1	1
5			Washer, Flat (5/16 x 11/16 x 1/16")	1	1
6	B	1081492	Kit, Adapter, 3/4 HTR, 5" Caster	1	1
NOTE: A - Kit includes Items 2 thru 5. B - Kit includes Item 7 (Knurled Nut), Item 8 (Sleeve), and Item 9 (Nylon Spacer). Items 7, 8, and 9 come standard with the Swivel Lock Caster shown in Item 1 (1140793) and are not individually resalable.					