

Fixed Height Arms

Non-Flip Back FXDESK and FXFULL

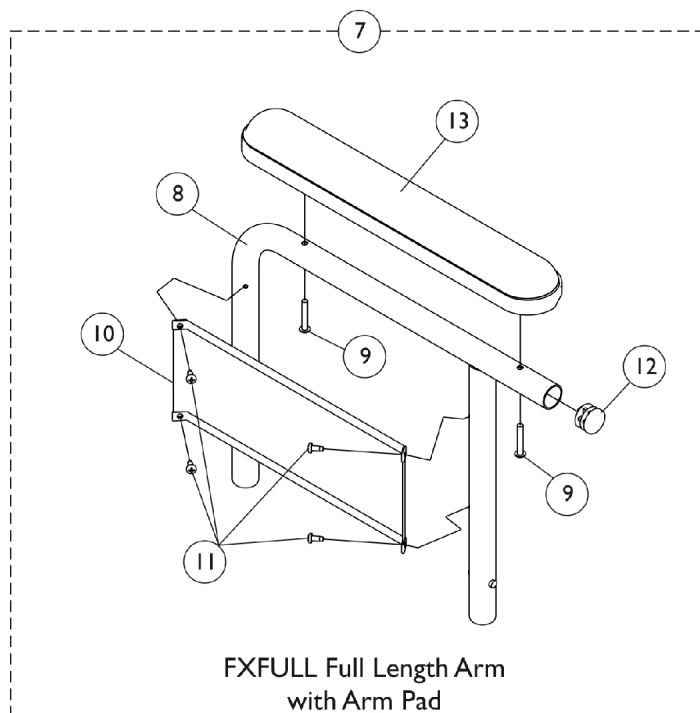
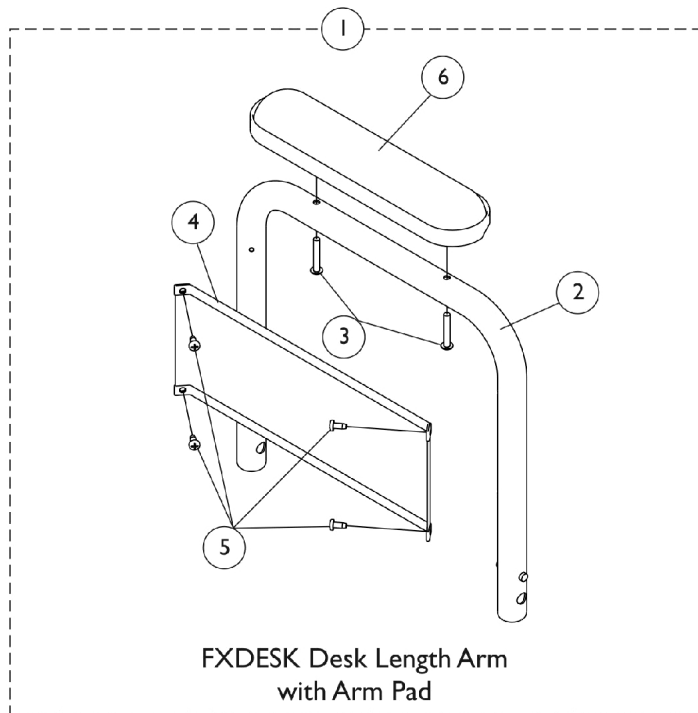

Fixed Height Arms

Non-Flip Back FXDESK and FXFULL

Item Number	Note	Part Number	Description	Quantity Per		
				Package	Assembly	
1	A,B	8881159491	Kit, Armrest, Desk Length, Black, FXDESK - Right	1	1	
2			Tube, Arm, Desk Length, Black - Right/Left	1	1	
3			Screw, Phillips Pan Head (#10-32 x 1-1/8")	1	2	
4			NLA - Guard, Clothing, Desk Length	1	1	
5			Screw, Phillips Pan Head Tap (#8-32 x 3/8")	1	4	
6			Pad, Arm, Desk Length	1	1	
6		8881053578	Kit, Arm Pad w/ Screws, Desk Length (9" L x 2" W) (Pair)	1	1	
1	A,B	8881159492	Kit, Armrest, Desk Length, Black, FXDESK - Left	1	1	
2			Tube, Arm, Desk Length, Black - Right/Left	1	1	
3			Screw, Phillips Pan Head (#10-32 x 1-1/8")	1	2	
4			NLA - Guard, Clothing, Desk Length	1	1	
5			Screw, Phillips Pan Head Tap (#8-32 x 3/8")	1	4	
6			NLA - Arm Pad, Desk Length w/ Law Label	1	1	
6		8881053578	Kit, Arm Pad w/ Screws, Desk Length (9" L x 2" W) (Pair)	1	1	
7	A,C	8881159488	Kit, Armrest, Full Length, Black, FXFULL - Right	1	1	
8			Tube, Arm, Full Length, Black - Right	1	1	
9			Screw, Phillips Pan Head (#10-32 x 1-1/8")	1	2	
10			NLA - Guard, Clothing, Desk Length	1	1	
11			Screw, Phillips Pan Head Tap (#8-32 x 3/8")	1	4	
12			Plug Button, Black (7/8")	1	1	
13			NLA - Pad, Arm, Full Length	1	1	
13		8881053577	Kit, Arm Pad w/ Screws, Full Length (14" L x 2" W) (Pair)	1	1	
7		A,C	8881159489	Kit, Armrest, Full Length, Black, FXFULL - Left	1	1
8				Tube, Arm, Full Length, Black - Left	1	1
9	Screw, Phillips Pan Head (#10-32 x 1-1/8")			1	2	
10	NLA - Guard, Clothing, Desk Length			1	1	
11	Screw, Phillips Pan Head Tap (#8-32 x 3/8")			1	4	
12	Plug Button, Black (7/8")			1	1	
13	NLA - Pad, Arm, Full Length w/ Law Label		1	1		
13		8881053577	Kit, Arm Pad w/ Screws, Full Length (14" L x 2" W) (Pair)	2	1	
NOTE: A - Specify upholstery color U67 when ordering B - Includes items 2-6 C - Includes items 8-13						