

# Steel & Frame Parts - Arro Beds

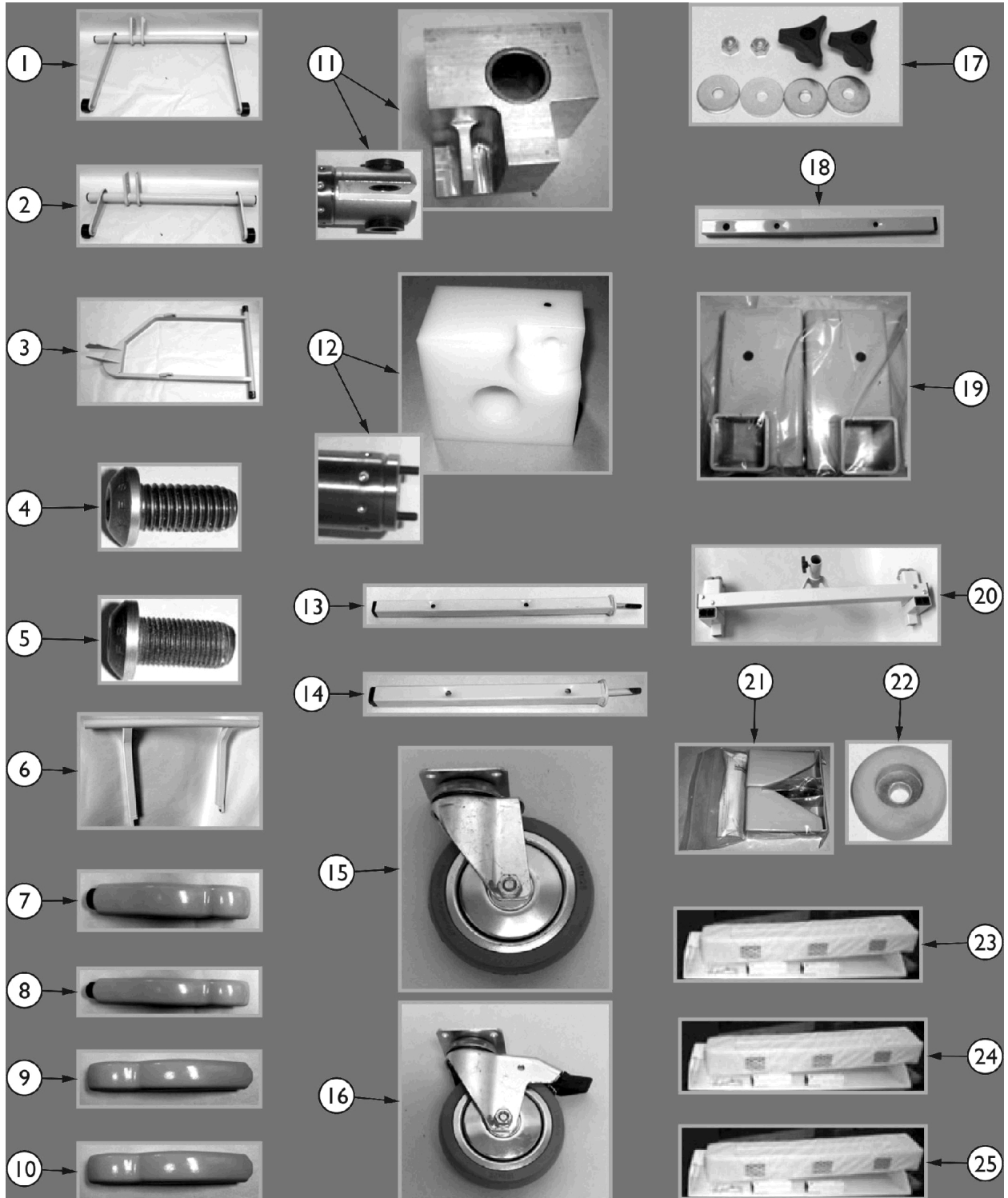

## Steel & Frame Parts - Arro Beds

Item Number	Note	Part Number	Description	Quantity Per	
				Package	Assembly
1	K	GATHEADASSY 1-NLA	NLA - Head Gatch Assembly	1	1
1		1185149-NLA	NLA - Head Gatch Assembly (Black Insert w/ Steel Pin)	1	1
2		GATFOOTASSY 1-NLA	NLA - Foot Gatch (Black Insert with Steel Pin)	1	1
3	A	LEG0022PNT-N LA	NLA - Arro Bed Leg (BA3180)	1	1
3	B	LEG0022SE2AS M-NLA	NLA - Arro Bed Leg (BA2180-BA3180)	1	1
3		LEG0022SE1AS M-NLA	NLA - Arro Bed Leg (BA0780-BA1180)	1	1
4	A	BLT121BSHCSC -NLA	NLA - Foot Bolt	1	1
5	B	BLT121BSHCSB -NLA	NLA - Foot Bolt	1	1
6		LEG0023ASSY- NLA	NLA - Arro Bed Stabilizer Leg	1	1
7		GLDARROFOTL HA-NLA	NLA - Arro Caster Foot, Head End - Left Side	1	1
8		GLDARROFOTR HA-NLA	NLA - Arro Caster Foot, Head End - Right Side	1	1
9		GLDARROFOTL FA-NLA	NLA - Arro Caster Foot, Foot End - Left Side	1	1
10		GLDARROFOTR FA-NLA	NLA - Arro Caster Foot, Foot End - Right Side	1	1
11	C	BRGGUIDESER- NLA	NLA - Linear Guide Block	1	1
12	D	BRGGUIDEA-NL A	NLA - Linear Guide Block	1	1
13		1186525	Post, Head	1	1
14		1186524	Post, Foot	1	1
15		WHLRHOM4	Caster Wheel, Non-Locking (Head End)	2	1
16		WHLRHOM4TL	Caster Wheel, Locking (Foot End)	2	1
17		KIT78	Kit, Head & Foot Board Mounting Hardware Knob, Three Arm	1	2
18		PST0029HASY- NLA	NLA - Removable Head/Foot Post	1	1
19		KIT64-NLA	NLA - Removable Head Board Brackets	1	1
20		TRAPEZEASSY 4I	Trapeze Adapter	1	1
21		MATTKPRKIT	Kit, Mattress Keeper, Left and Right Corners Mattress Keeper, Left Corner Mattress Keeper, Right Corner	1 1 1	1 2 2
22		GLDBUMPER	Rubber Bed Foot & Wall Bumper (Optional, 2 per Wireform)	1	1
23	E	KIT19EARRO-N LA	NLA - Extension Kit - 4"	1	1
24	F,G,I	KIT19EARRO5- NLA	NLA - Extension Kit - 4"	1	1

## Steel & Frame Parts - Arro Beds

Item Number	Note	Part Number	Description	Quantity Per	
				Package	Assembly
25	H,J,I	KIT19EARRO-N LA	NLA - Extension Kit - 4"	1	1
<p>NOTE: A - Used as of November 8, 2007.            B - Used prior to November 8, 2007.            C - For hole mount motors, matches HiLo motor with mounting bracket shown. Used only on small amount of original Arros 0780 Style.            D - For current style HiLo motors with the mounting bracket shown.            E - For Model BA0780-111 only, includes DECK00-05K-IT-1 also (not shown).            F - For Arro 151/171's built between 2/4/2003 and 4/11/2004. Includes a phone cord and phone coupler.            G - Bed code BA1180, order DECK00-05K-IT-1 for BA0780 models.            H - All Arro 111 (except 0780) and Linak System Arro 151/171's built after 4/12/2004.            I - Order through SFI Medical            J - Bed codes BA2180, BA3180.            K - Item #1 GATHEADASSY1 is No Longer Available. Order part number 1185149 as a replacement.</p>					