

Electronics - MK5 SPJ/SPJ+/ACC and MK6i SPJ+ ACC

Joysticks and Mounting Hardware

The SPJ+ Joystick plus Cable Kit replaces the SPJ Joystick after 10/31/07.

Note: For Joystick & Hardware used on the M51 w/ Formula CG Tilt, refer to MK6i parts catalog Form # 06-110.

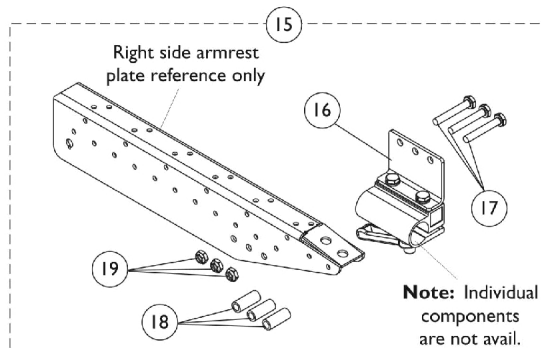
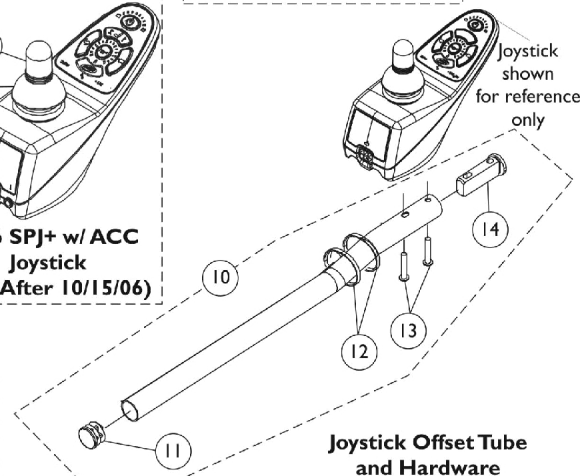
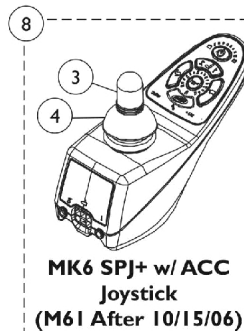
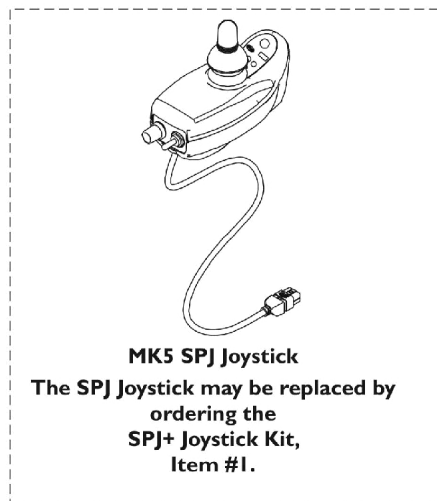
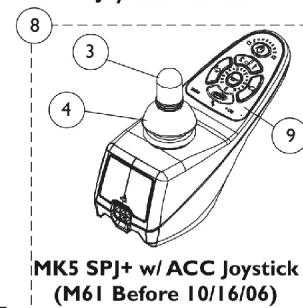
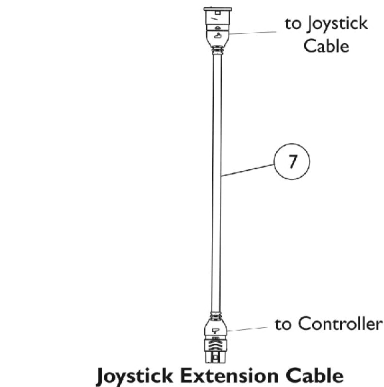
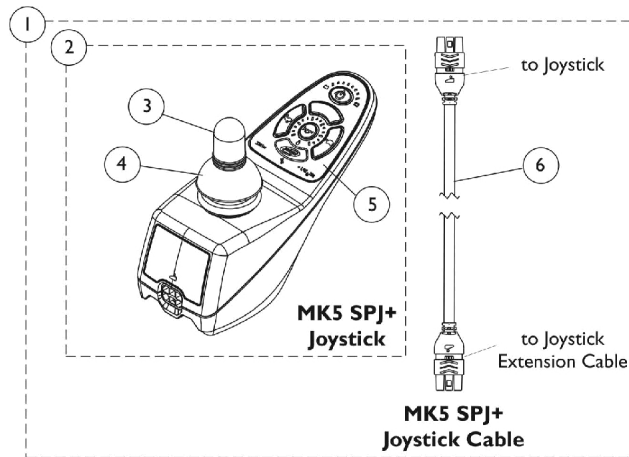

Van Seat Joystick Offset Tube Mounting Hardware

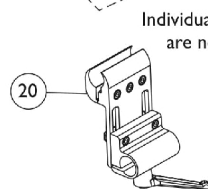

ASBA Seat, Adjustable Height Joystick Offset Tube Clamp Assembly

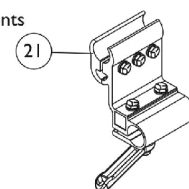

ASBA Seat, Fixed Height Joystick Offset Tube Clamp Assembly

Electronics - MK5 SPJ/SPJ+/ACC and MK6i SPJ+ ACC

Joysticks and Mounting Hardware

The SPJ+ Joystick plus Cable Kit replaces the SPJ Joystick after 10/31/07.

Note: For Joystick & Hardware used on the M51 w/ Formula CG Tilt, refer to MK6i parts catalog Form # 06-110.

| Item Number | Note | Part Number | Description | Quantity Per | |
|-------------|----------|--------------|---|--------------|----------|
| | | | | Package | Assembly |
| 1 | A,B,J,O | 1153650 | Kit, SPJ+ Joystick w/ Cable | 1 | 1 |
| 2 | | | Joystick, SPJ+ | 1 | 1 |
| 3 | | | Knob, Joystick Rubber, Black | 1 | 1 |
| 4 | | | Skirt, Joystick Rubber, Black | 1 | 1 |
| 5 | | | NLA - Overlay, SPJ+ Joystick | 1 | 1 |
| 6 | | | Cable, Joystick SPJ+ | 1 | 1 |
| 7 | | 1116404 | Cable, Joystick Extension | 1 | 1 |
| | N,P | See Note-NLA | See Footnote | 1 | 1 |
| 8 | C,K,K1,L | 1127289-NLA | NLA - Joystick, MK5/MK6i SPJ+ w/ ACC | 1 | 1 |
| 8 | C,O | 1136938 | Joystick, MK6i SPJ+ with ACC (SPJAPM) | 1 | 1 |
| 8 | C,O | 1136938E | WARR RPLMT - Joystick, MK6i SPJ+ with ACC (SPJAPM) | 1 | 1 |
| 3 | | 1040217 | Knob, Joystick Rubber, Black | 1 | 1 |
| 4 | | 1040218 | Skirt, Joystick Rubber, Black | 1 | 1 |
| 5 | J | 1165094 | Kit, Overlay, SPJ+ Joystick (MK5/MK6) | 1 | 1 |
| | | | NLA - Overlay, SPJ+ Joystick | 1 | 1 |
| | | | Instruction Sheet, MK5/MK6 Overlay | 1 | 1 |
| 6 | | 1127293 | Cable, Joystick SPJ+ | 1 | 1 |
| 7 | | 1116404 | Cable, Joystick Extension | 1 | 1 |
| 8 | | 1127289-NLA | NLA - Joystick, MK5/MK6i SPJ+ w/ ACC | 1 | 1 |
| 8 | | 1136938 | Joystick, MK6i SPJ+ with ACC (SPJAPM) | 1 | 1 |
| 9 | G | 1165093 | NLA - Kit, Overlay, SPJ+ w/ ACC Joystick, MK5/MK6 | 1 | 1 |
| | | | Overlay, SPJ+ w/ACC Joystick | 1 | 1 |
| | | | Instruction Sheet, MK5/MK6 Overlay | 1 | 1 |
| 10 | E | 1161733 | Kit, 2" Offset Joystick Tube w/ Hardware | 1 | 1 |
| 11 | | | Plug Button, Black (7/8") | 1 | 1 |
| 12 | | | Tie Wrap (11-1/2" L) | 1 | 2 |
| 13 | | | Screw, Phillips Pan Head (#10-32 x 1-1/8") | 1 | 2 |
| 13 | | | Screw, Phillips Pan Head (M5 x .8 x 30mm) | 1 | 2 |
| 14 | | | Spacer, Joystick Tube, Black | 1 | 1 |
| | | | Tube, Joystick Offset (2") | 1 | 1 |
| 10 | H | 1093069 | Kit, 1/2" Offset Joystick Tube with Hardware | 1 | 1 |
| 11 | | 1130582 | Package, Plug Button, Black (7/8") | 10 | 1 |
| 12 | | 1095502-NLA | NLA - Package, Tie Wrap (11-1/2" L) | 10 | 1 |
| 13 | | 1025714 | Screw, Phillips Pan Head (#10-32 x 1-1/8") | 1 | 2 |
| 14 | | 1093063 | Spacer, Joystick Tube, Black | 1 | 1 |
| 15 | M | 1115000 | Kit, Joystick Tube Mounting Hardware - Captain Seat | 1 | 1 |
| 16 | | 1105049 | Clamp Assembly, Fixed Height, Captain/ Van Seat | 1 | 1 |
| 17 | | 1037610 | Screw, Hex Head (1/4-20 x 1-5/8") | 1 | 3 |
| 18 | | 1087219 | Spacer (1/4 x 3/8 x 1") | 1 | 3 |
| 19 | | 1025195 | Locknut (1/4-20) | 1 | 3 |

Electronics - MK5 SPJ/SPJ+/ACC and MK6i SPJ+ ACC

Joysticks and Mounting Hardware

The SPJ+ Joystick plus Cable Kit replaces the SPJ Joystick after 10/31/07.

Note: For Joystick & Hardware used on the M51 w/ Formula CG Tilt, refer to MK6i parts catalog Form # 06-110.

| Item Number | Note | Part Number | Description | Quantity Per | |
|--|------|-------------|---|--------------|----------|
| | | | | Package | Assembly |
| 20 | I | 1139422 | Clamp, Height Adjustable Joystick Tube (ARM250) | 1 | 1 |
| 21 | | 1093071 | Clamp, Fixed Height Joystick Tube | 1 | 1 |
| | D | 1006270 | Extension, Joystick, "T" Style (1560) (4" W x 5-1/2" L) | 1 | 1 |
| | D | 1006271 | Extension, Joystick, Straight Style (1561) (1/2" W x 5" L) | 1 | 1 |
| <p>NOTE:</p> <p>A - Used on M50 and M51 models.</p> <p>B - Includes joystick and items 2 thru 6.</p> <p>C - Used on M61 models only.</p> <p>D - Not Shown.</p> <p>E - Used on chairs with Van Seats. Includes item 11 thru 14. Kit contains Standard (#10-32) and Metric (M5) screws. Customer selects the screw that applies to their application.</p> <p>G - Used on SPJ+ w/ ACC only.</p> <p>H - Used on chairs with A.S.B.A. seats. Includes items 6 thru 10.</p> <p>I - Introduced as an option (ARM250) and can be used to replace a Fixed Height Joystick Clamp.</p> <p>J - SPJ+ joystick was introduced to the M51 models on 8/16/05.</p> <p>K - MK5 SPJ+ w/ ACC Before 10/16/06 did not contain phono ports. After 10/15/06 part # 1127289 Joystick was revised to function MK5 and MK6i applications. Phono ports were added and the Decal Overlay was revised to say MK6i SPJ+ w/ACC.</p> <p>K1 - The revised MK5/MK6i SPJ+ w/ACC Joystick is backward compatible for chairs manufactured before 10/16/06 equipped with MK5 electronics.</p> <p>L - Includes Joystick and items 2, 3 and 21.</p> <p>M - Includes items 16 thru 19.</p> <p>N - Used on M51 models Before 8/16/05</p> <p>O - Before replacing your joystick, verify with Invacare Technical Service Phone Support first to see if only a Joystick Overlay Kit is needed</p> <p>P - MK5 SPJ Joystick part number is no longer available as a service part. Use item #1 1153650 as the replacement.</p> | | | | | |