

# MKIV RII and MKIV A Joysticks & Mounting Hardware

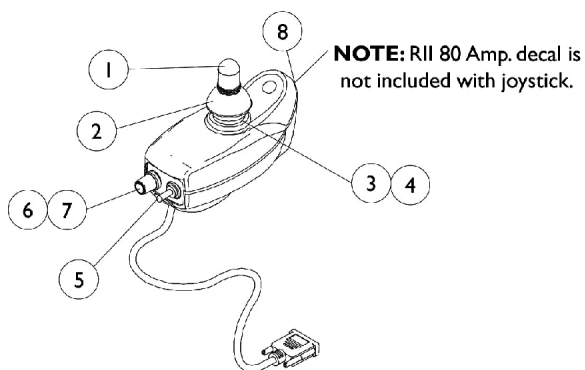

**1107267**  
**RII Joystick**

**NOTE:** RII 80 Amp. decal is not included with joystick.

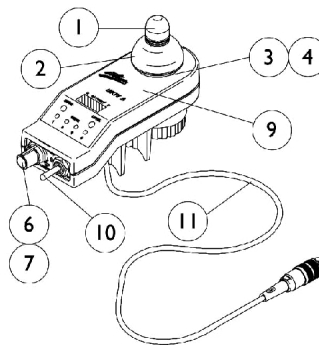

**1065944**  
**A Joystick**

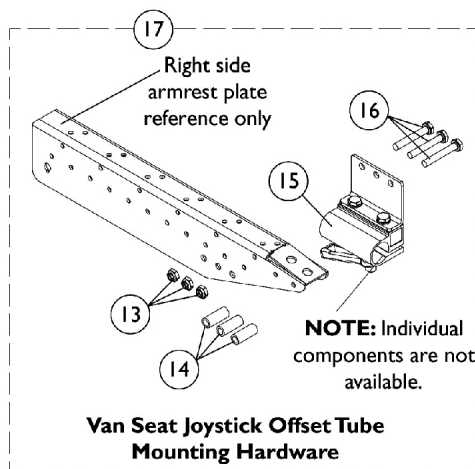

**Van Seat Joystick Offset Tube Mounting Hardware**

**NOTE:** Individual components are not available.

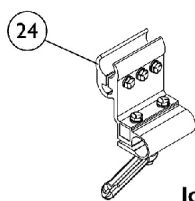
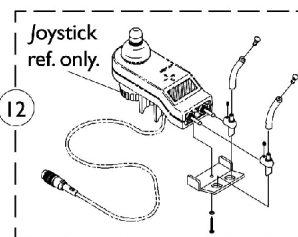

**NOTE:** Individual components are not available.

**Fixed Height Joystick Offset Tube Clamp Assembly**

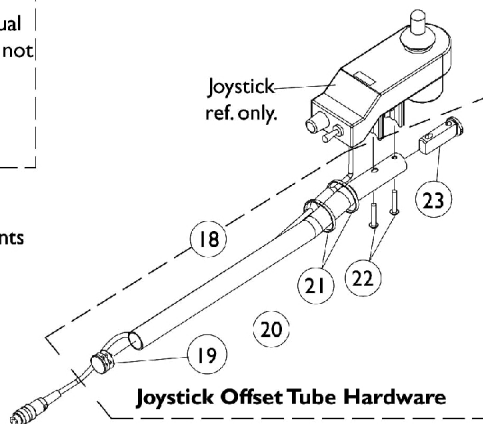

**Joystick Offset Tube Hardware**

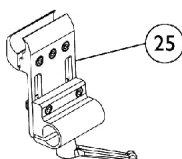

**Adjustable Height Joystick Offset Tube Clamp Assembly**

# MKIV RII and MKIV A Joysticks & Mounting Hardware

Item Number	Note	Part Number	Description	Quantity Per	
				Package	Assembly
1		1040217	Knob, Joystick Rubber, Black	1	1
2		1040218	Skirt, Joystick Rubber, Black	1	1
3	L	1036764-NLA	NLA - Inductive, Joystick	1	1
3	F	1104397-NLA	NLA - Inductive, Joystick	1	1
4		50000X364-NLA	NLA - Boot, Joystick	1	1
5	K	1010042-NLA	NLA - Switch, Toggle SPDT	1	1
6	L	1040225-NLA	NLA - Potentiometer, Speed	1	1
6	F	1115518-NLA	NLA - Potentiometer, Speed	1	1
7		1025516-NLA	NLA - Knob, Speed Control	1	1
8		1108692-NLA	NLA - Decal, RII 80 Amp	1	1
9		1040190-NLA	NLA - Overlay, Joystick Decal A Joystick	1	1
10	F	1115523-NLA	NLA - Switch, On/ Off Momentary	1	1
11	F	1104205-NLA	NLA - Cable Assembly	1	1
12	B	1055736-NLA	NLA - Kit, Toggle Switch Extension	1	1
13		1025195	Locknut (1/4-20)	1	3
14		1087219	Spacer (1/4 x 3/8 x 1")	1	3
15	H	1105049	Clamp Assembly, Fixed Height, Captain/ Van Seat	1	1
16		1037610	Screw, Hex Head (1/4-20 x 1-5/8")	1	3
17	A,H	1115000	Kit, Joystick Tube Mounting Hardware - Captain Seat	1	1
18	C	1093069	Kit, 1/2" Offset Joystick Tube with Hardware	1	1
18	G	1161733	Kit, 2" Offset Joystick Tube w/ Hardware	1	1
19			Plug Button, Black (7/8")	1	1
20			Tube, Joystick Offset (2")	1	1
21			Tie Wrap (11-1/2" L)	1	2
22			Screw, Phillips Pan Head (#10-32 x 1-1/8")	1	2
22			Screw, Phillips Pan Head (M5 x .8 x 30mm)	1	2
23			Spacer, Joystick Tube, Black	1	1
19		1027095	Plug Button, Black (7/8")	1	1
21		1095502-NLA	NLA - Package, Tie Wrap (11-1/2" L)	10	1
24		1093071	Clamp, Fixed Height Joystick Tube	1	1
25	M	1139422	Clamp, Height Adjustable Joystick Tube (ARM250)	1	1
	D,E,I,J	1107267-NLA	NLA - Joystick, MKIV RII	1	1
	D,J	1065944-NLA	NLA - Joystick, "A"	1	1

NOTE:

- A - Includes items 13 thru 16.
- B - MKIV A joystick only
- C - Used for A.S.B.A. seats and Includes items 19 thru 23.
- D - See pictorial for reference
- E - Item 8 RII 80 amp. decal is not included
- F - MKIV A - item has a non-solder connector
- G - Used for Van Seats and includes items 19 thru 23. Kits contains Standard (#10-32) and Metric (M5) screws. Customer selects screw that applies to their application.
- H - Due to product improvement, the joystick mounting bracket with a separate adjustment lock were replaced with the clamp assembly shown as of 2/20/03 and is backward compatible.
- I - As of 1/31/03 MKIV RII joystick was made with a longer cable and serves as a direct replacement for chairs made before 1/31/03
- J - When upgrading MKIV RII electronics to "A" electronics also order wiring harness part no. 1116609. This harness allows charging capabilities since "A" joystick does not have this.
- K - Item requires soldering.
- L - MKIV RII - item requires soldering.
- M - Introduced as an option (ARM250) and can be used to replace a Fixed Height Joystick Clamp.