

MKIV RII Joystick and Mounting Hardware

Before 6/27/03

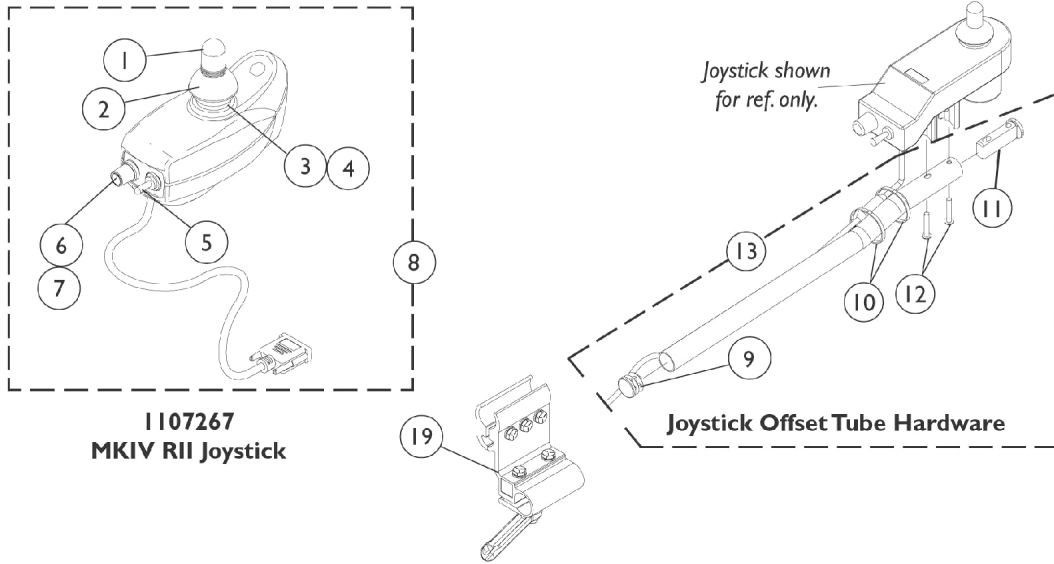

Joystick Offset Tube Clamp Assembly

NOTE: Individual components are not available.

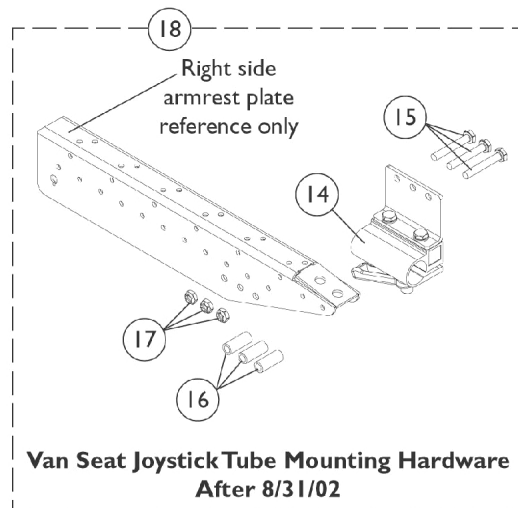
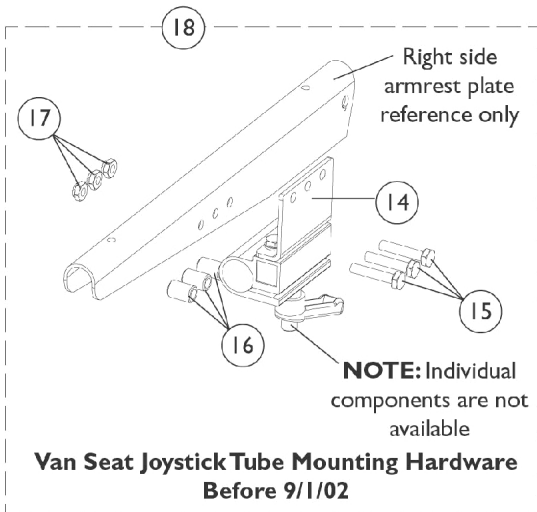

MKIV RII Joystick and Mounting Hardware Before 6/27/03

Item Number	Note	Part Number	Description	Quantity Per	
				Package	Assembly
1		1040217	Knob, Joystick Rubber, Black	1	1
2		1040218	Skirt, Joystick Rubber, Black	1	1
3		1036764-NLA	NLA - Inductive, Joystick	1	1
4		50000X364-NLA	NLA - Boot, Joystick	1	1
5		1010042-NLA	NLA - Switch, Toggle SPDT	1	1
6		1040225-NLA	NLA - Potentiometer, Speed	1	1
7		1025516-NLA	NLA - Knob, Speed Control	1	1
8		1107267-NLA	NLA - Joystick, MKIV RII	1	1
9		1027095	Plug Button, Black (7/8")	1	1
10		1095502-NLA	NLA - Package, Tie Wrap (11-1/2" L)	10	2
11		1093063	Spacer, Joystick Tube, Black	1	1
12		1025714	Screw, Phillips Pan Head (#10-32 x 1-1/8")	1	2
13	F,B	1093069	Kit, 1/2" Offset Joystick Tube with Hardware	1	1
13	B	1161733	Kit, 2" Offset Joystick Tube w/ Hardware	1	1
9			Plug Button, Black (7/8")	1	1
10			Tie Wrap (11-1/2" L)	1	2
11			Screw, Phillips Pan Head (#10-32 x 1-1/8")	1	2
11			Screw, Phillips Pan Head (M5 x .8 x 30mm)	1	2
12			Spacer, Joystick Tube, Black	1	1
			Tube, Joystick Offset (2")	1	1
14	G	1105049	Clamp Assembly, Fixed Height, Captain/ Van Seat	1	1
15	D	1057955	Screw, Hex Head (1/4-20 x 1-1/4")	1	3
15	E	1037610	Screw, Hex Head (1/4-20 x 1-5/8")	1	3
16	D	1101524-NLA	NLA - Spacer (1/4 x 7/16 x 5/8")	1	3
16	E	1087219	Spacer (1/4 x 3/8 x 1")	1	3
17		1025195	Locknut (1/4-20)	1	3
18	C,D,G	1105050-NLA	NLA - Kit, Joystick Tube Mounting Hardware - Captain/ Van Seat	1	1
18	C,E,G	1115000	Kit, Joystick Tube Mounting Hardware - Captain Seat	1	1
19	F	1093071	Clamp, Fixed Height Joystick Tube	1	1
	A	1006270	Extension, Joystick, "T" Style (1560) (4" W x 5-1/2" L)	1	1
	A	1006271	Extension, Joystick, Straight Style (1561) (1/2" W x 5" L)	1	1

NOTE: A - Not Shown.
B - For Van seats, includes items 9 thru 12. Kit contains Standard (#10-32) and Metric (M5) screws. Customer selects the screw that applies to their application.
C - Includes items 14 thru 17.
D - Before 9/1/02.
E - After 8/31/02.
F - For A.S.B.A. seats.
G - Due to product improvement, the joystick mounting bracket with a separate adjustment lock were replaced with the clamp assembly shown as of 2/20/03 and is backward compatible.