

Heel Loop Hardware

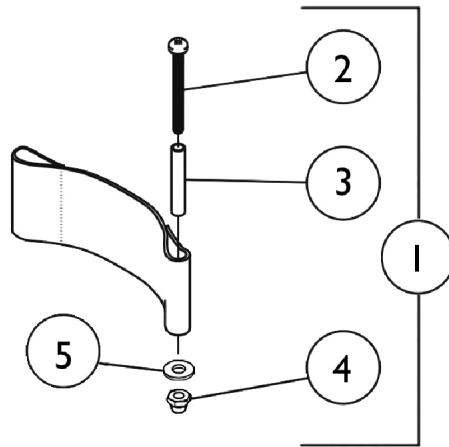

**Heel Loop
for 1651 - A1562 - A1564**

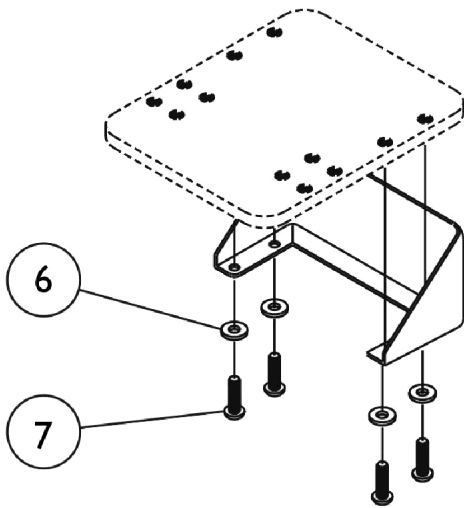

**Heel Loop
for AT5543 (Before 9/2/08)**

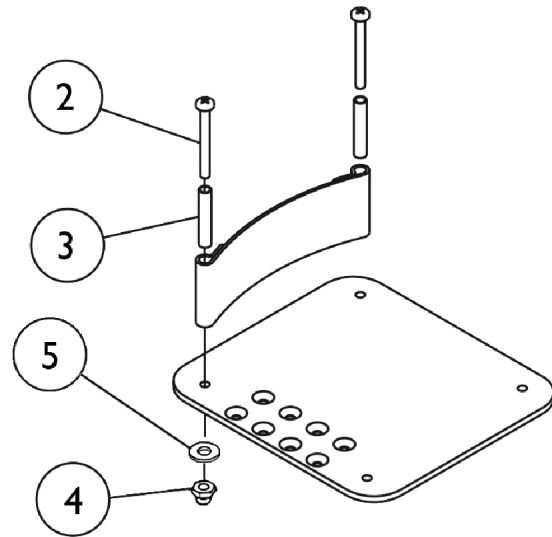

**Heel Loop
for AT5543 (After 9/2/08)**

Heel Loop Hardware

Heel Loop Hardware

Item Number	Note	Part Number	Description	Quantity Per	
				Package	Assembly
1		1035931	Kit, Heel Loop Attaching Hardware (Pair)	2	1
6		1028516	Washer, Steel (3/16 x 7/16 x 1/16")	1	4
7		1026115-NLA	NLA - Screw, Phillips Pan Head (#10-32 x 5/16")	1	4
	A	See Chart	Heel Loops - A5543 Adjustable Angle Footplates	1	1
	A	See Chart	Heel Loops - A1562 Aluminum Footplates	1	1
	A	See Chart	Heel Loops - A1564 Extra Large Footplates	1	1
	A	See Chart	Accessories - Heel Loops - 1651 Composite Footplates	1	1

NOTE: A - Not Shown. Includes items 2-5

Heel Loops - A5543 Adjustable Angle Footplates

Chair Width/Type	Heel Loop Single	Heel Loop Pair	Attaching Hardware Pair
14" Small 60 Degree, 70 Degree Non-Tapered	1030958-NLA	1036101	1035931
16-17" Medium 60 Degree, 70 Degree Non-Tapered	99816X024	1069037	1035931
18-20" Large 60 Degree, 70 Degree Non-Tapered	99816X024	1068624	1035931
16-18" Medium 70 Degree Tapered	1017621	1035917-NLA	1035931
20" Large 70 Degree Tapered	1027000	1035929	1035931

Heel Loops - A1562 Aluminum Footplates

Chair Width/Type	Heel Loop Single	Heel Loop Pair	Attaching Hardware Pair
14" Small 60 Degree, 70 Degree Non-Tapered	1017621	1035917-NLA	1035931
16-20" Large 60 Degree, 70 Degree Non-Tapered	1027000	1035929	1035931
16-18" Medium 70 Degree Tapered	1017621	1035917-NLA	1035931
20" Large 70 Degree Tapered	1027000	1035929	1035931

Heel Loop Hardware

Heel Loops - A1564 Extra Large Footplates

Chair Width/Type	Heel Loop Single #	Heel Loop Pair #	Attaching Hardware Pair
16-20" Large 60 Degree, 70 Degree Non-Tapered	1027000	1035929	1035931

Heel Loop Hardware

1651 Composite Footplates

Chair Width/Type	Heel Loop Single	Heel Loop Pair	Attaching Hardware Pair
14" Special 60 Degree, 70 Degree Non-Tapered	1025234-NLA	1035905	1035931
16" Medium 60 Degree, 70 Degree Non-Tapered	1017621	1035917-NLA	1035931
18-20" Large 60 Degree, 70 Degree Non-Tapered	1027000	1035929	1035931
14-16" Special 70 Degree Tapered	1025234-NLA	1035905	1035931
18" Medium 70 Degree Tapered	1017621	1035917-NLA	1035931
20" Large 70 Degree Tapered	1027000	1035929	1035931