

One Piece Adjustable Angle Flip-Up Footplate - AT5545

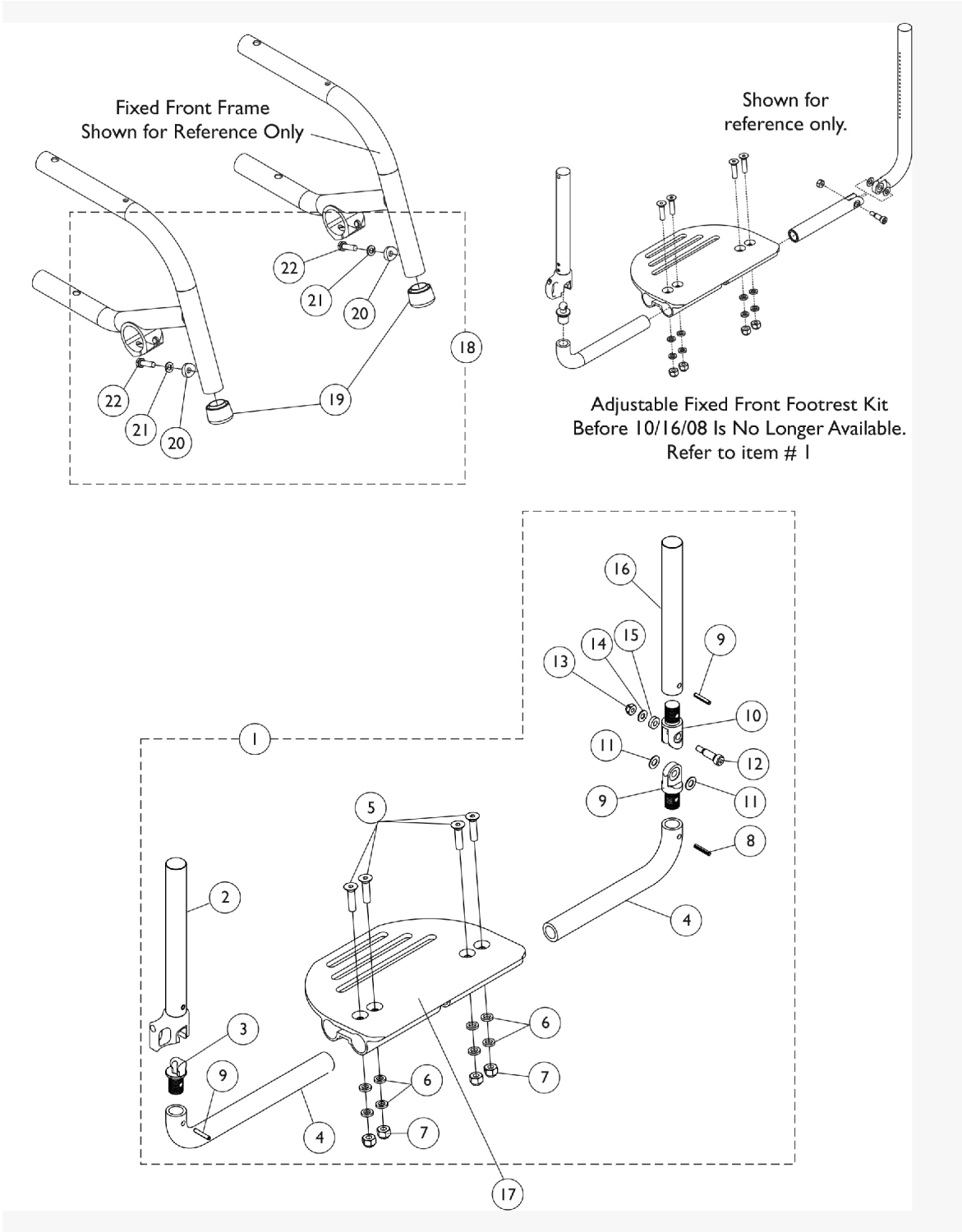

One Piece Adjustable Angle Flip-Up Footplate - AT5545

Item Number	Note	Part Number	Description	Quantity Per	
				Package	Assembly
1	A,B,E	1161928	Kit, Adjustable Fixed Front Footrest, Silver (14 - 17" W)	1	1
2			Footrest Tube Assembly	1	1
3			Pin, Threaded Ball	1	1
4			Tube, Footrest Lower Support (14 - 17" W)	1	2
5			Screw, Socket Flat Head (1/4-28 x 1")	1	4
6			Washer, Nylon (1/4 x 7/16 x 5/64")	1	8
7			Locknut (1/4-28)	1	4
8			NLA - Pin, Roll (3/16 x 3/4")	1	3
9			Pin, Threaded Pivot Joint - Male	1	1
10			Pin, Threaded Pivot Joint - Female	1	1
11			NLA - Washer (1/4 x 1/2 x 1/16")	1	2
12			Screw, Shoulder Hex Socket Head (1/4 x 5/8", #10-24)	1	1
13			Locknut, Stainless Steel (10-24)	1	1
14			Washer, Stainless Steel (3/16 x 7/16 x 1/32")	1	1
15			NLA - Washer, Nylon (3/16 x 7/16 x 1/8")	1	1
16			Insert, Adjustable Handle	1	1
1	B,C,E	1161929	Kit, Adjustable Fixed Front Footrest, Silver (18 - 20" W)	1	1
2			Footrest Tube Assembly	1	1
3			Pin, Threaded Ball	1	1
4			Tube, Footrest Lower Support (18 - 20" W)	1	2
5			Screw, Socket Flat Head (1/4-28 x 1")	1	4
6			Washer, Nylon (1/4 x 7/16 x 5/64")	1	8
7			Locknut (1/4-28)	1	4
8			NLA - Pin, Roll (3/16 x 3/4")	1	3
9			Pin, Threaded Pivot Joint - Male	1	1
10			Pin, Threaded Pivot Joint - Female	1	1
11			NLA - Washer (1/4 x 1/2 x 1/16")	1	2
12			Screw, Shoulder Hex Socket Head (1/4 x 5/8", #10-24)	1	1
13			Locknut, Stainless Steel (10-24)	1	1
14			Washer, Stainless Steel (3/16 x 7/16 x 1/32")	1	1
15			NLA - Washer, Nylon (3/16 x 7/16 x 1/8")	1	1
16			Insert, Adjustable Handle	1	1
17		See Chart	#17 Footplate, Adjustable Angle Flip-Up (Silver) 14"-17" W Chairs	1	1
17		See Chart	#17 Footplate, Adjustable Angle Flip-Up (Silver) 18"-20" W Chairs	1	1
18	D	1142122	Hardware Kit, Footrest, Flip-Up	1	1
19			Collar, Anti-Rattle	1	2
20			Spacer, Coved (1/4 x 11/16 x 1/2")	1	2
21			Lockwasher, Split (1/4")	1	2
22			Screw, Hex Head (1/4-20 x 7/8")	1	2

One Piece Adjustable Angle Flip-Up Footplate - AT5545

NOTE: A - 14-17" wide chairs. Includes items 2-16, footplate is Not included.
 B - Includes footrest tube, ball socket, pins, release handle, spring, and screws.
 C - 18-20" wide chairs. Includes items 2-16, footplate is Not included.
 D - Includes items 19-22.
 E - Adjustable Fixed Front Footrest Kit was revised 10/16/08 and is backward compatible for chairs built before 10/16/08

#17 Adjustable Angle Flip-Up Footplate (Silver) 14"-17" W Chairs

14"-15" W	16"-17" W
1161924	1161925
See Note(s) A	See Note(s) B
NOTE: A - As of 10/16/08 14"-15" wide chairs use the same Adjustable Angle Flip-Up Footplate. Footplate is backward compatible for all 15" wide models built before 10/16/08 as well. B - As of 10/16/08 16"-17" wide chairs use the same Adjustable Angle Flip-Up Footplate. Footplate is backward compatible for all 17" wide models built before 10/16/08 as well.	

#17 Adjustable Angle Flip-Up Footplate (Silver) 18"-20" W Chairs

18" W	19" W	20" W
1161926-NLA	1161926-NLA	1161926-NLA