

## Conventional Back without Mounting Hardware (16" Wide) Non-Manual Tilt - TDX SPREE

Only the Back Assembly needs to be replaced when changing back heights.

**NOTE:** Hook Fastener w/ Adhesive Back Kit must be ordered when a Back Pan or Back Assembly is requested. This will allow the Loop Fastener w/ Adhesive on the Back Cover to attach properly.

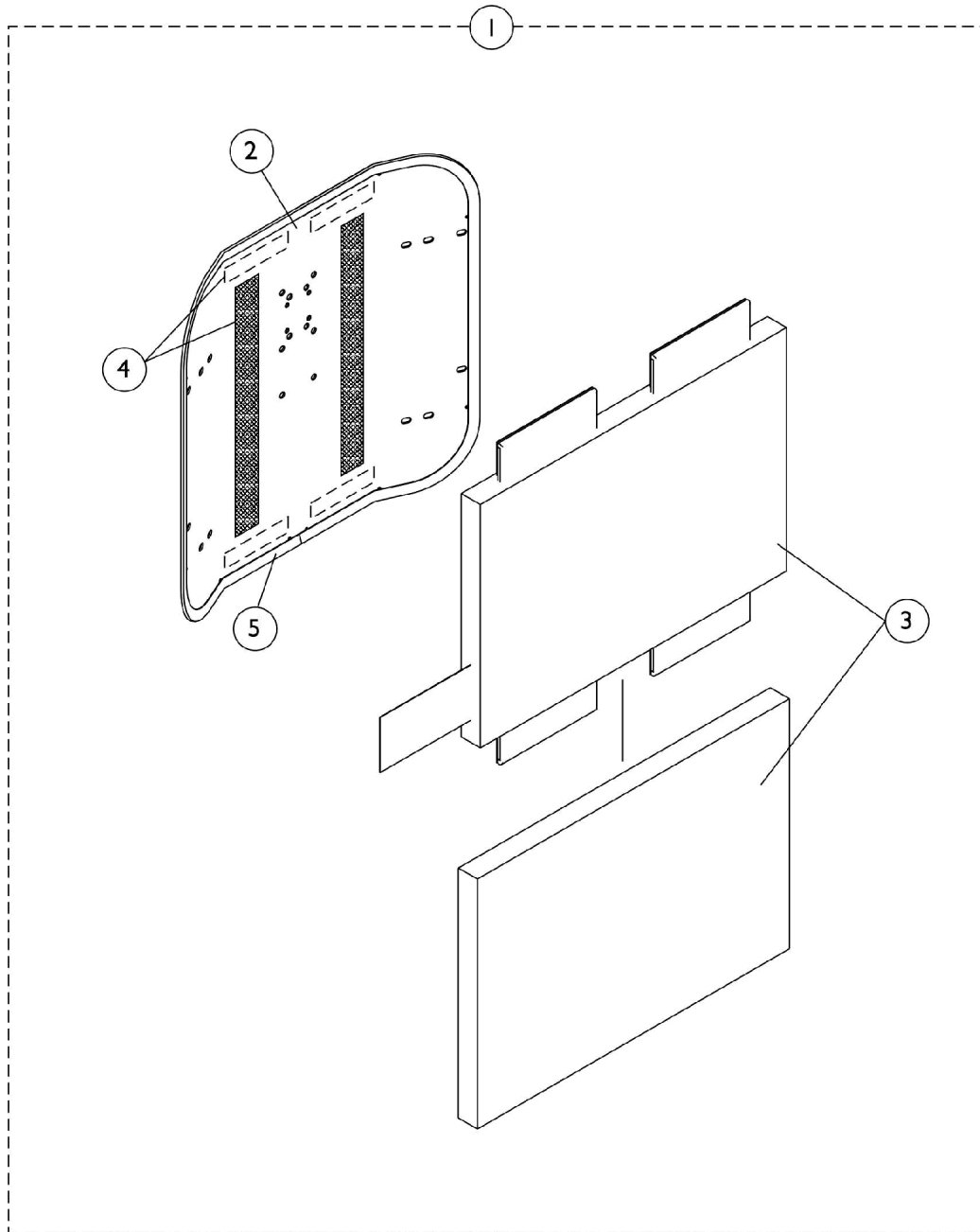

## Conventional Back without Mounting Hardware (16" Wide) Non-Manual Tilt - TDX SPREE

Only the Back Assembly needs to be replaced when changing back heights.

**NOTE:** Hook Fastener w/ Adhesive Back Kit must be ordered when a Back Pan or Back Assembly is requested. This will allow the Loop Fastener w/ Adhesive on the Back Cover to attach properly.

Item Number	Note	Part Number	Description	Quantity Per	
				Package	Assembly
1	A	1125564	Back Assembly w/o Hardware (16" W x 20" H)	1	1
2	A	1124578	Pan, Back (16" W x 15" H)	1	1
3	B	1097397	Back Cushion Assembly (17" W x 15" H)	1	1
4	C	1125723	Kit, Hook Fastener w/ Adhesive Back	1	1
5		1125724-NLA	NLA - Trim, Edge, Cut-To-Length, Vinyl Black (96" L)	1	1
<p><b>NOTE:</b> A - Description reflects materials actual width x height. Item is used for a 16" wide chair with an overall back height of 20"</p> <p>B - Back cover and foam are sold as a back cushion assembly only. Description reflects actual back cushion material width x Height. Back Cushion will be 1" wider than the chair width and used for a chairs overall back height of 20".</p> <p>C - Hook Fastener w/ Adhesive Back Kit is used to attach the Back Cover to the Back Pan and must be ordered when a new Back Pan or Back Assembly is requested.</p>					