

Controller - Programmer w/ Mtg. Hdwr. - Pronto M71/Pronto M71jr

MK6i electronics are only used on Pronto M71 chairs with Rehab seats. Chairs that have Van seats use MK5 electronics. See Pronto M71 parts catalog for parts information.

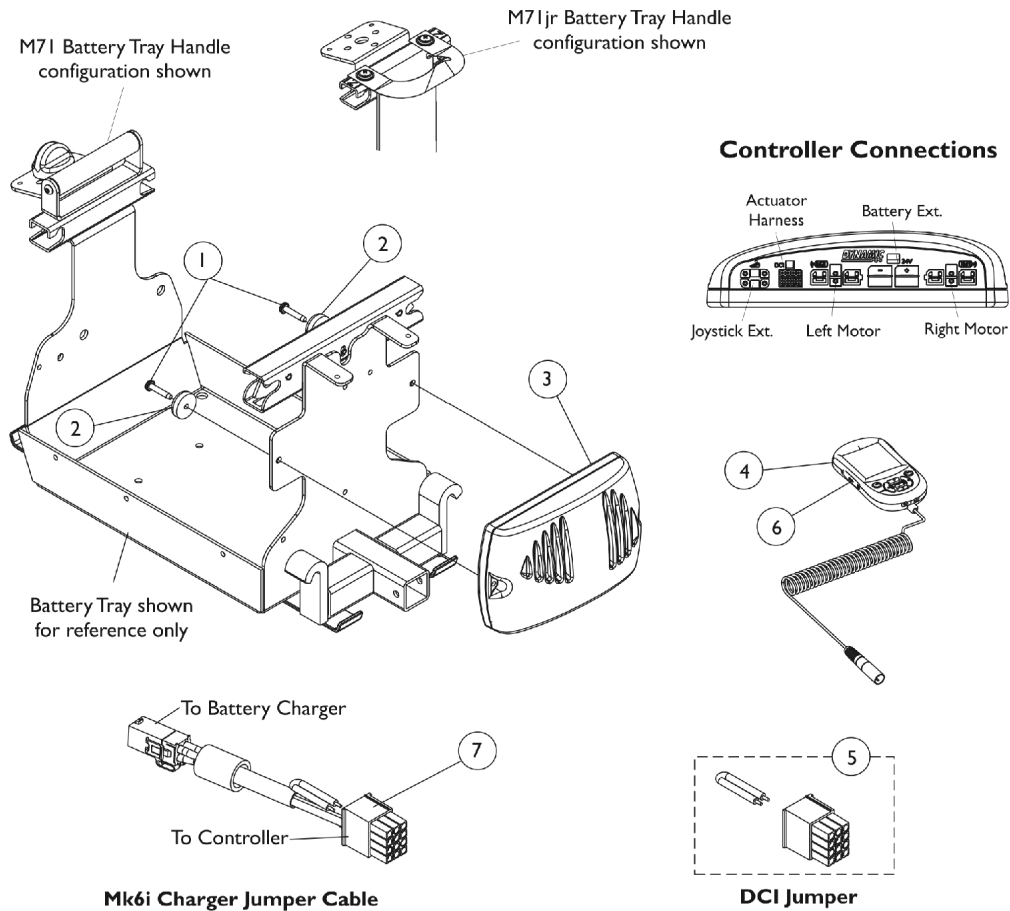

Controller - Programmer w/ Mtg. Hdwr. - Pronto M71/Pronto M71jr

MK6i electronics are only used on Pronto M71 chairs with Rehab seats. Chairs that have Van seats use MK5 electronics. See Pronto M71 parts catalog for parts information.

Item Number	Note	Part Number	Description	Quantity Per	
				Package	Assembly
1		1113439-NLA	NLA - Screw, Phillips Pan Head Tap (#10-32 x 1")	1	2
2		1109471-NLA	NLA - Bumper with Washer	1	2
3	B,B1,E, E1	1127270	Controller, MK5 NX w/ ACC/ MK660 w/ ACC	1	1
3	F	1148361-NLA	NLA - Controller, MK660 w/ ACC	1	1
4	G	1139985	Programmer, MK6i Remote	1	1
4	G	1142215	Kit, MK6i Remote Programmer w/ SD Professional Card & Card Holder (1813M6)	1	1
5	D	1140125-NLA	NLA - Jumper, DCI	1	1
6		1139997	Cover, SD Card Slot	1	1
7	C	1134169-NLA	NLA - Cable, MK6i Charger Jumper	1	1
	A	1095502-NLA	NLA - Package, Tie Wrap (11-1/2" L)	10	1

NOTE: A - Not Shown
 B - After 10/8/06 the MK5 NX w/ ACC controller was revised to function as a MK660 w/ ACC or MK5 NX w/ ACC controller. The part # did not change and the label was revised to only show MK660 w/ ACC.
 B1 - Revised controller is backward compatible with MK5 Driver Controls manufactured Before 10/9/06. Controllers in the field that show the MK5 NX w/ ACC label and serial # dated Before 10/9/06 will not have revised software to work with MK6i Driver Controls.
 C - Jumper Cable used on Pronto M71 (ADJASBA) Seating with an ON-Board Battery Charger and Pronto M71jr. (ASBA) models with an ON-Board Battery Charger and NON-Tilt Seating
 D - DCI Jumper is used when an MPJ+ Joystick is used
 E - Part #1148361 controller is no longer required as a replacement for a chair ordered with Manual Tilt Option before 1/19/07.
 E1 - because the software for part #1127270 was revised 8/31/07 to version 2.61a and now accommodates all Manual Tilt optioned chairs shipped before 1/19/07 as well.
 F - Used for Chairs with Manual Tilt Option only. Discontinued 8/31/07, see part #1127270 as a direct replacement.
 G - The MK6i Programmer Manual (1141471) is not included and is strongly recommended the guide be ordered or downloaded from Literature Fulfillment.