

Orbit Seat Option

Tilt and Non-Tilt Hardware

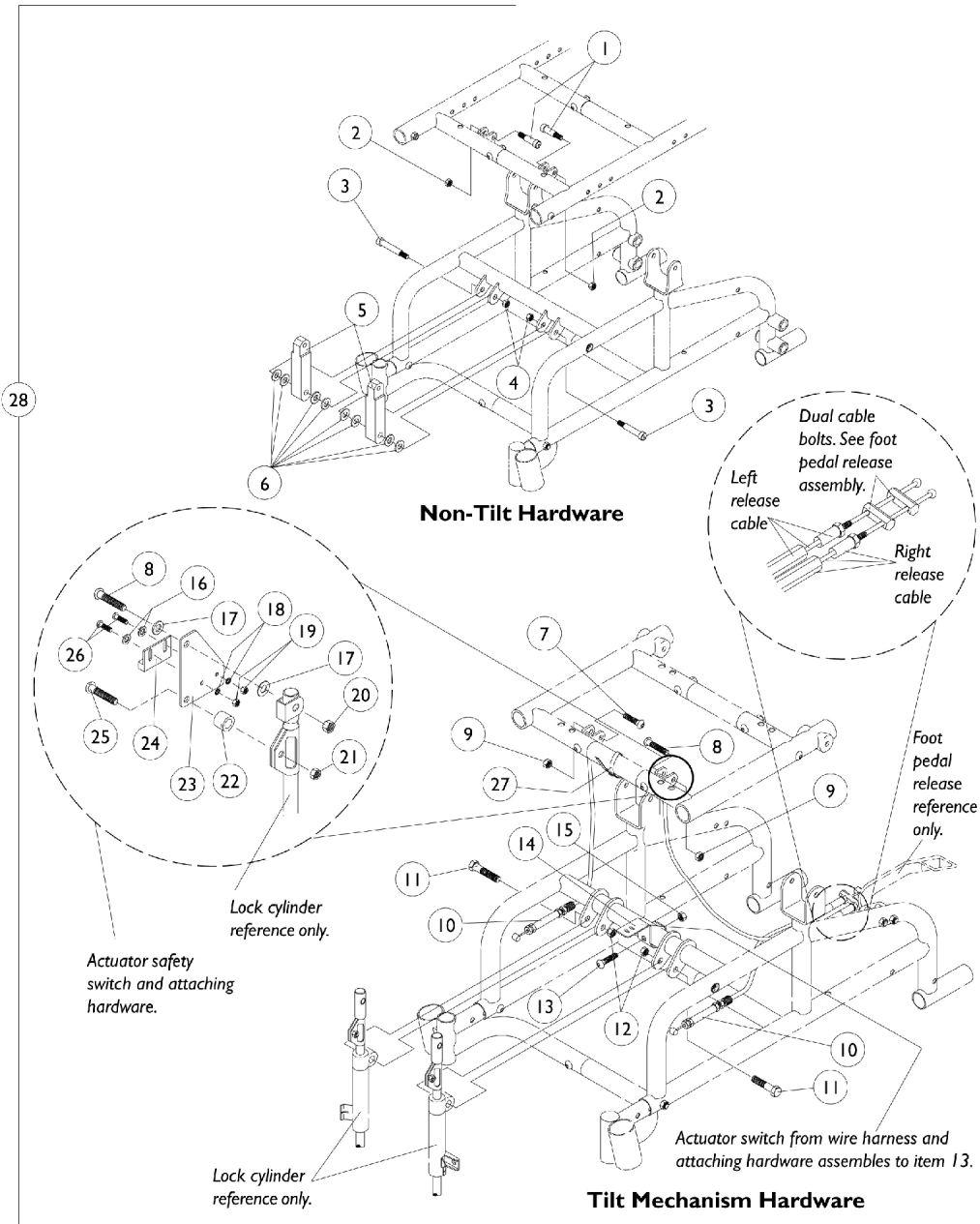

Orbit Seat Option Tilt and Non-Tilt Hardware

Item Number	Note	Part Number	Description	Quantity Per	
				Package	Assembly
1		1029966-NLA	NLA - Bolt, Shoulder (1/4 x 3/4")	1	2
2		1026035-NLA	NLA - Locknut (#10-24)	1	2
3		1025351-NLA	NLA - Screw, Shoulder Hex Socket Head (5/16" x 1-1/4", 1/4-20)	1	2
4		7930333	Locknut (1/4-20)	25	2
5		1030263-NLA	NLA - Link	1	2
6		1012371	Washer, Nylon (3/8 x 7/8 x 1/16")	1	2
7		1009837	Screw, Socket Button Head (1/4-20 x 1")	1	6
8		1008432	Screw, Socket Button Head (1/4-20 x 1-1/4")	1	1
9		7930323-NLA	NLA - Package, Locknut (1/4-20)	25	1
10		1073876	Cable, Tilt Release	1	1
10		1083061-NLA	NLA - Cable, Tilt - Left	1	1
11		1013560-NLA	NLA - Screw, Hex Head (5/16-18 x 1-1/2")	1	1
12		60290X002	Locknut (5/16-18)	1	2
13	D	1008432	Screw, Socket Button Head (1/4-20 x 1-1/4")	1	1
	B	1027704-NLA	NLA - Screw, Phillips Pan Head (#4-40 x 3/8")	1	1
	B	1011011-NLA	NLA - Washer, Plain (1/8 x 5/16 x 1/32")	1	1
	B	P0870X000	Nut, Hex Keps (#4-40)	1	2
14		1037898-NLA	NLA - Bracket, Actuator Switch Mounting, Black	1	2
15		7930323-NLA	NLA - Package, Locknut (1/4-20)	25	3
16		1011011-NLA	NLA - Washer, Plain (1/8 x 5/16 x 1/32")	1	1
17		1026033	Washer, Nylon (1/4 x 1/2 x 1/16")	1	2
18		1008525-NLA	NLA - Washer, Internal Tooth Lock (#4-40)	1	2
19		1005889	NLA - Locknut (#4-40)	1	2
20		7930323-NLA	NLA - Package, Locknut (1/4-20)	25	2
21		7930332-NLA	NLA - Locknut, High Profile (#10-32)	25	2
22		47330X003	Spacer (5/16 x 1/2 x 3/8")	1	1
23		1037897-NLA	NLA - Plate, Actuator Mounting	1	1
24		1024001	Sensor, Actuator Switch	1	1
25		1005383	Screw, Socket Button Head (#10-32 x 1")	1	1
26		1027704-NLA	NLA - Screw, Phillips Pan Head (#4-40 x 3/8")	1	2
27		1095503-NLA	NLA - Package, Tie Wrap (5-5/8" L)	10	1
28	C	1083065-NLA	NLA - Hardware, Tilt Mechanism	1	1
28	A	1030273-NLA	NLA - Hardware, Non-Tilt	1	1

NOTE: A - Includes Items 1-6
 B - Not Shown
 C - Includes items 7-12 and 16-27
 D - Attaching hardware for the Actuator Switch Mounting Bracket consists of part numbers 1027704, 1011011, and P0870X000.