

Tilt and Non-Tilt Hardware

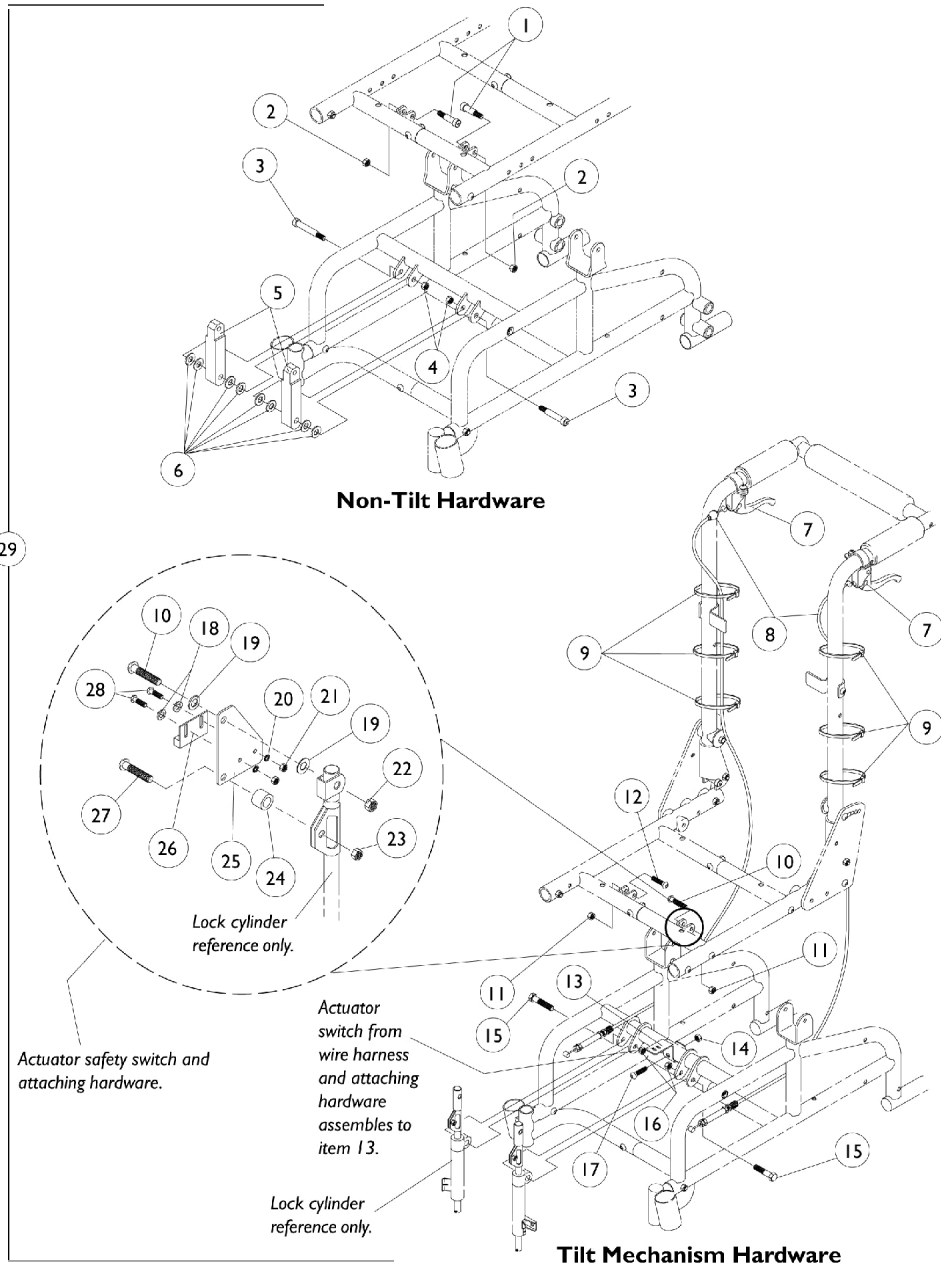

Tilt and Non-Tilt Hardware

Item Number	Note	Part Number	Description	Quantity Per	
				Package	Assembly
1		1029966-NLA	NLA - Bolt, Shoulder (1/4 x 3/4")	1	2
2		1026035-NLA	NLA - Locknut (#10-24)	1	2
3		1025351-NLA	NLA - Screw, Shoulder Hex Socket Head (5/16" x 1-1/4", 1/4-20)	1	2
4		7930333	Locknut (1/4-20)	25	2
5		1030263-NLA	NLA - Link	1	2
6		1012371	Washer, Nylon (3/8 x 7/8 x 1/16")	1	6
7	E	1023998-NLA	NLA - Lever, Tilt, Black - Right	1	1
7	E	1023999-NLA	NLA - Lever, Tilt, Black - Left	1	1
8		1025352-NLA	NLA - Cable	1	2
9		1095503-NLA	NLA - Package, Tie Wrap (5-5/8" L)	10	6
10		1008432	Screw, Socket Button Head (1/4-20 x 1-1/4")	1	1
11		7930323-NLA	NLA - Package, Locknut (1/4-20)	25	3
12		1009837	Screw, Socket Button Head (1/4-20 x 1")	1	1
13	A	1037898-NLA	NLA - Bracket, Actuator Switch Mounting, Black	1	1
	B	1027704-NLA	NLA - Screw, Phillips Pan Head (#4-40 x 3/8")	1	2
	B	1011011-NLA	NLA - Washer, Plain (1/8 x 5/16 x 1/32")	1	2
	B	P0870X000	Nut, Hex Keps (#4-40)	1	2
14		7930323-NLA	NLA - Package, Locknut (1/4-20)	25	1
15		1013560-NLA	NLA - Screw, Hex Head (5/16-18 x 1-1/2")	1	2
16		60290X002	Locknut (5/16-18)	1	2
17		1008432	Screw, Socket Button Head (1/4-20 x 1-1/4")	1	1
18		1011011-NLA	NLA - Washer, Plain (1/8 x 5/16 x 1/32")	1	2
19		1026033	Washer, Nylon (1/4 x 1/2 x 1/16")	1	2
20		1008525-NLA	NLA - Washer, Internal Tooth Lock (#4-40)	1	2
21		1005889	NLA - Locknut (#4-40)	1	2
22		7930323-NLA	NLA - Package, Locknut (1/4-20)	25	2
23		7930332-NLA	NLA - Locknut, High Profile (#10-32)	25	1
24		47330X003	Spacer (5/16 x 1/2 x 3/8")	1	1
25		1037897-NLA	NLA - Plate, Actuator Mounting	1	1
26		1024001	Sensor, Actuator Switch	1	1
27		1005383	Screw, Socket Button Head (#10-32 x 1")	1	1
28		1027704-NLA	NLA - Screw, Phillips Pan Head (#4-40 x 3/8")	1	2
29	C	1036832-NLA	NLA - Hardware, Tilt Mechanism	1	1
29	D	1030273-NLA	NLA - Hardware, Non-Tilt	1	1

NOTE: A - Attaching hardware for the Actuator Switch Mounting Bracket consists of part numbers 1027704, 1011011, and P0870X000.

B - Not Shown

C - Includes Items 7-12, 15, 16, and 18-28

D - Includes Items 1-6

E - Part #'s 1023998 and 1023999 Tilt Lever is no longer available. Item #7 has been replaced with part #1060209, available from Top End. Please contact Top End directly for this part that can be used on the right or left side of the wheelchair.