

Seat Frame, Seat Pan and Hardware **(16"-20" Wide) x (16"-22" Deep) (CGE) For TDX SP/SP-GT/SR**

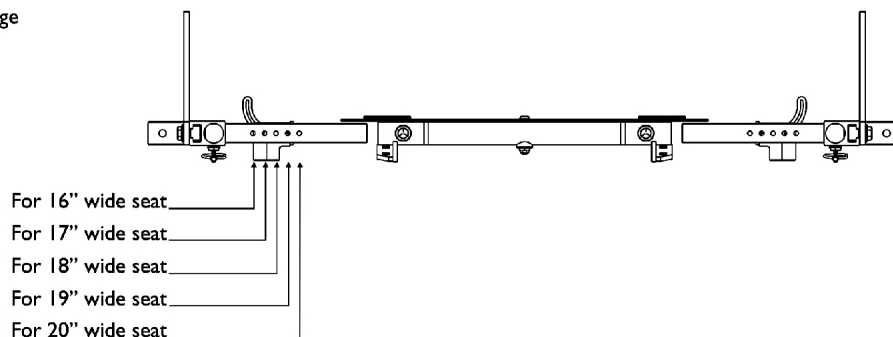
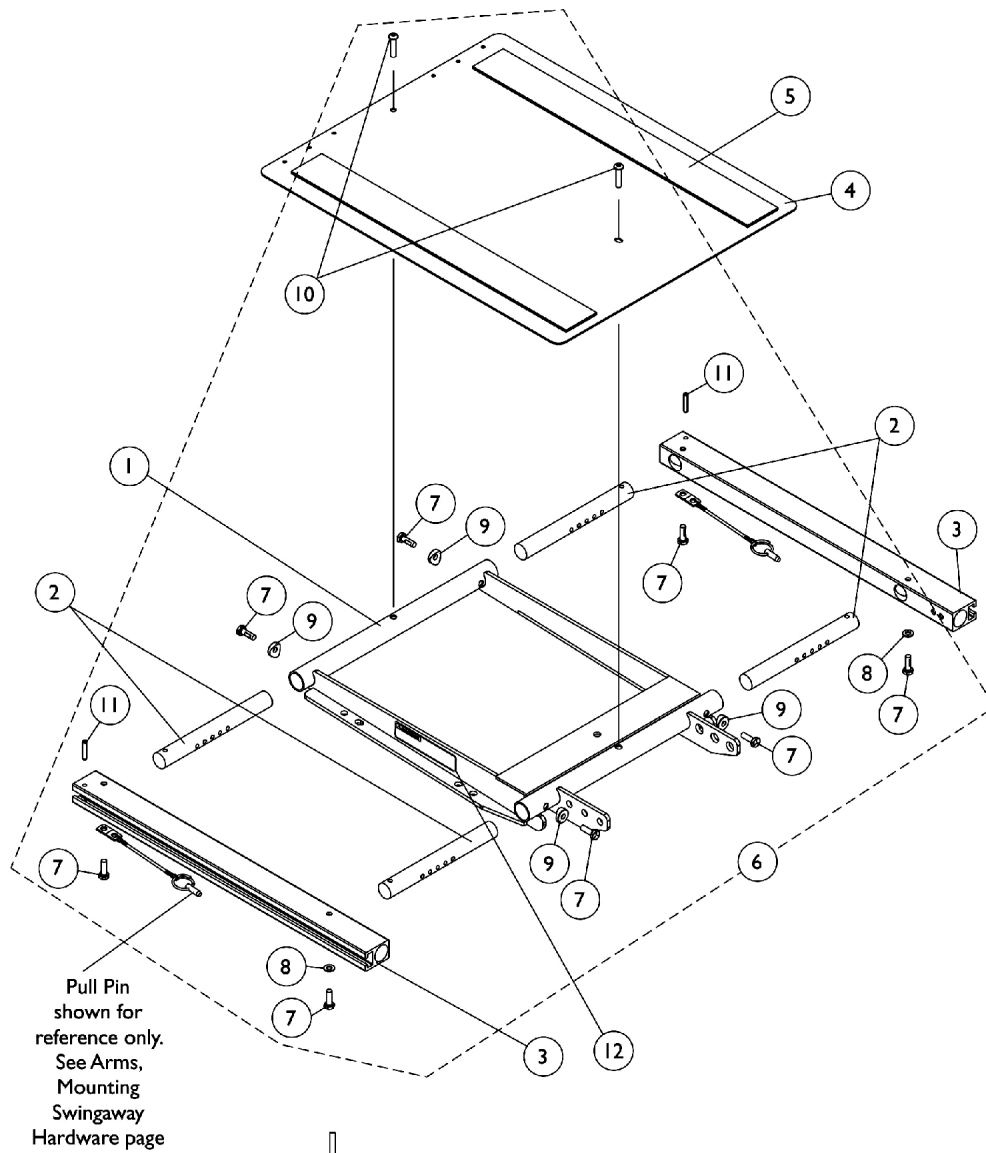

Seat Frame Width Settings

Seat Frame, Seat Pan and Hardware (16"-20" Wide) x (16"-22" Deep) (CGE) For TDX SP/SP-GT/SR

Item Number	Note	Part Number	Description	Quantity Per		
				Package	Assembly	
1	D	1120288	Frame, Center Seat, Black	1	1	
2		1122475	Crossbar, Seat Frame (16" - 20" W)	1	4	
3		1122647	Rail, Seat Frame (16 - 20" D For Formula TRE and 16 - 19" D For ADJASBA)	1	2	
3		1122677	Rail, Seat Frame (20 - 22" D Formula TRE) (19 - 22" D ADJASBA)	1	2	
4		1124386	Pan, Seat with Hook and Loop Fasteners (16 - 20" W) x (16 - 20" D For Formula TRE) & (16 - 19" D For ADJASBA)	1	1	
4		1124666	Pan, Seat, with Hook and Loop Fasteners (16 - 20" W) x (20 - 22" D For Formula TRE) & (19 - 22" D For ADJASBA)	1	1	
5		A	1043082	Hook Fastener with Adhesive Back (2" W x 18" L)	1	2
5		A	1044580	Loop Fastener with Adhesive Back (2" W x 18" L)	1	2
5		B	1043084	Hook Fastener with Adhesive back (2" W x 22" L)	1	2
5		B	1044584	Loop Fastener with Adhesive back (2" W x 22" L)	1	2
6		C	1135501	Kit, Seat Frame Assembly Hardware	1	1
7				Screw, Hex Head w/ Patch (1/4-20 x 3/4")	1	8
8				Washer (1/4 x 1/2 x 1/16")	1	2
9				Spacer, Coved (1/4 x 11/16 x 1/2")	1	4
10				Screw, Socket Button (1/4-20 x 3/4")	1	2
11				NLA - Pin, Roll (3/16 x 1")	1	2
12			1114823	Decal, Seat Adjustment Warning	1	2
NOTE: A - For 16"-19" deep seats B - For 19"-22" deep seats C - Includes items 7-11 D - When ordering Center Seat Frame (item 1), also order 2 ea. Seat Adjustment Warning Decal (item 12).						