

90 WSBT Footboard Assembly, 19"- 22" Deep Pronto R2 Made After 9/24/00 Only

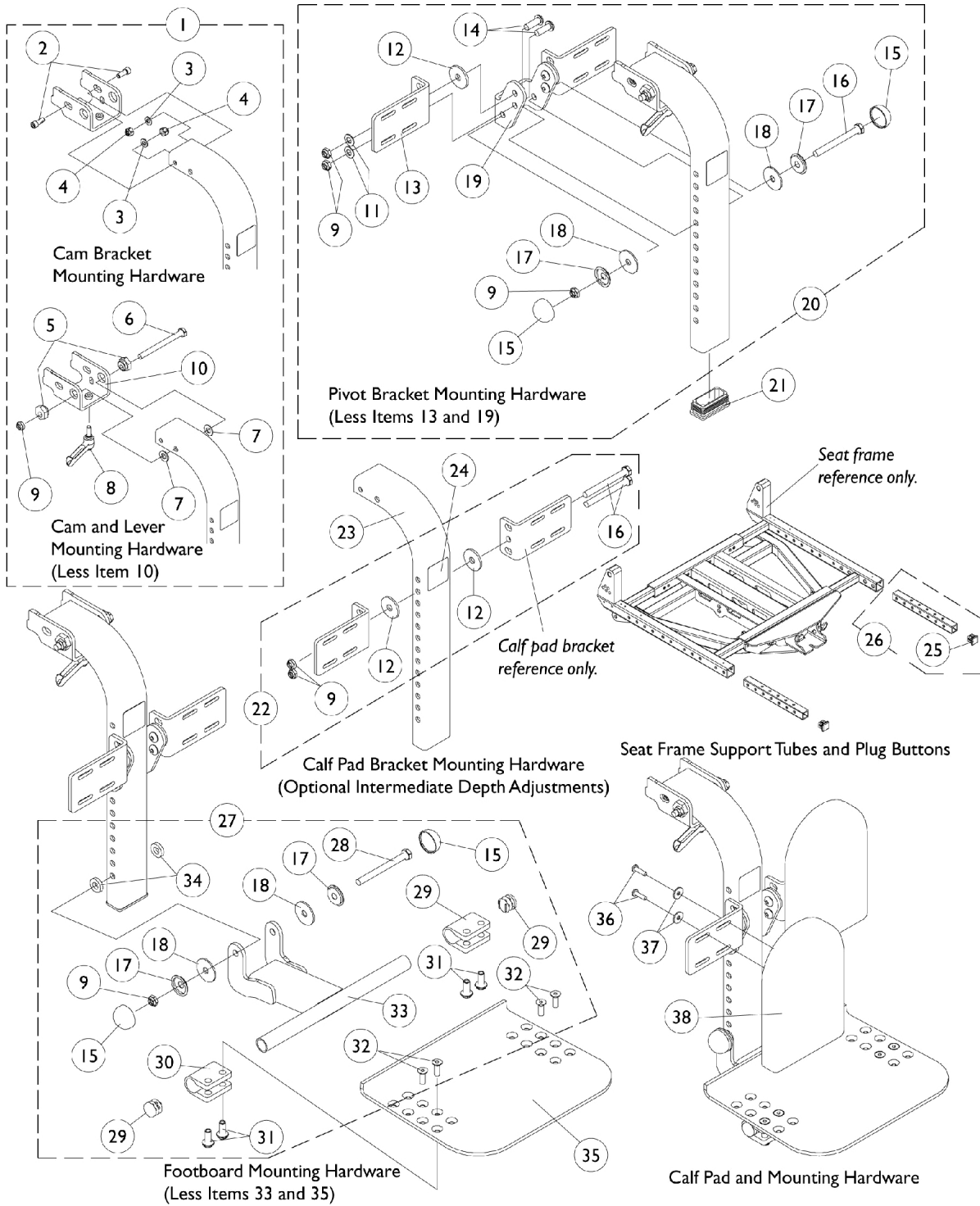

90 WSBT Footboard Assembly, 19"- 22" Deep Pronto R2 Made After 9/24/00 Only

Item Number	Note	Part Number	Description	Quantity Per	
				Package	Assembly
1	B	1101542-NLA	NLA - Hardware, Cam Bracket Mounting	1	1
2		1007219	Screw, Socket Head (1/4-20 x 5/8")	1	2
3		1026907	Washer (1/4 x 1/2 x 1/16")	1	2
4		7930333	Locknut (1/4-20)	25	2
5		1091547-NLA	NLA - Cam, Mounting Bracket, Upper	1	2
6		1037110	Screw, Hex Head (5/16-24 x 3-1/2")	1	1
7		1026032	Washer, Nylon (11/32 x 11/16 x 1/16")	1	2
8		1099502-NLA	NLA - Lever, Adjustment	1	1
9		7930330-NLA	NLA - Locknut (5/16-24)	25	9
10		1099494-NLA	NLA - Bracket, Cam with Fastener, Black	1	1
11		1025704	Washer, Flat (5/16 x 5/8 x 1/16")	1	4
12		1071487-NLA	NLA - Washer, Nylon (23/64 x 1-15/64 x 7/64")	1	4
13		1099500-NLA	NLA - Bracket, Calf Pad Mounting, Black	1	2
14		1099504-NLA	NLA - Screw, Socket Button Head (5/16-24 x 7/8")	1	4
15		1028835-NLA	NLA - Cap, Hub, Black	1	4
16		1028600-NLA	NLA - Screw, Hex Head (5/16-24 x 3")	1	3
17		1028491-NLA	NLA - Washer, Caplugs (11/32" I.D. x 1" O.D.)	1	4
18		1092409	Washer, Steel (5/16 x 1-1/4 x 1/16")	1	4
19		1099499-NLA	NLA - Bracket, Pivot, Black	1	1
20	C	1101543-NLA	NLA - Hardware, Pivot Bracket Mounting	1	1
21		1101088-NLA	NLA - Plug Button, Rectangular	1	1
22	D	1101092-NLA	NLA - Hardware, Calf Pad Bracket Mounting	1	1
23		1101541-NLA	NLA - Tube, Legrest with Warning Decal	1	1
24		1098331-NLA	NLA - Decal, Warning	1	1
25		0062200-NLA	NLA - Plug Button, Square (3/4")	1	2
26		1096519-NLA	NLA - Support Tube w/ Plug Button, Black	1	2
27	E	1101544-NLA	NLA - Hardware, Footboard Mounting	1	1
28		1025705-NLA	NLA - Screw, Hex Head (5/16-24 x 3-1/4")	1	1
29		1027097	Plug Button, Black (3/4")	1	2
30		1058517	Clamp, Footplate	1	2
31		1082686	Nut, Barrel, Hex Head (1/4-20 x 11/16")	1	4
32		1029545	Screw, Socket Flat Head (1/4-20 x 3/4")	1	4
33		1090551-NLA	NLA - Bracket, Footboard Pivot, Black	1	1
34		1074210-NLA	NLA - Washer, Nylon (23/64 x 3/4 x 5/32")	1	2
35		1094613-NLA	NLA - Footboard, Black (18" W)	1	1
36		7930328-NLA	NLA - Package, Screw, Phillips Pan Head (#10-32 x 11/16")	25	4
37		1070587	Washer, Flat (3/16 x 5/8 x 1/16")	1	4
38	A	88804529X003	Pad, Legrest, Vinyl - Right	1	1
38	A	88804529X004	Pad, Legrest, Vinyl - Left	1	1

NOTE: A - Specify U67 black upholstery color when ordering
 B - Includes Items 2-9
 C - Includes Items 9, 11, 12 and 14-18
 D - Includes Items 9, 12 and 16
 E - Includes Items 9, 15, 17, 18 and 28-34