

Battery Wire Harnesses, Sensor Proximity Switch, Extension Cables and Energy Chain For All Elevate Systems

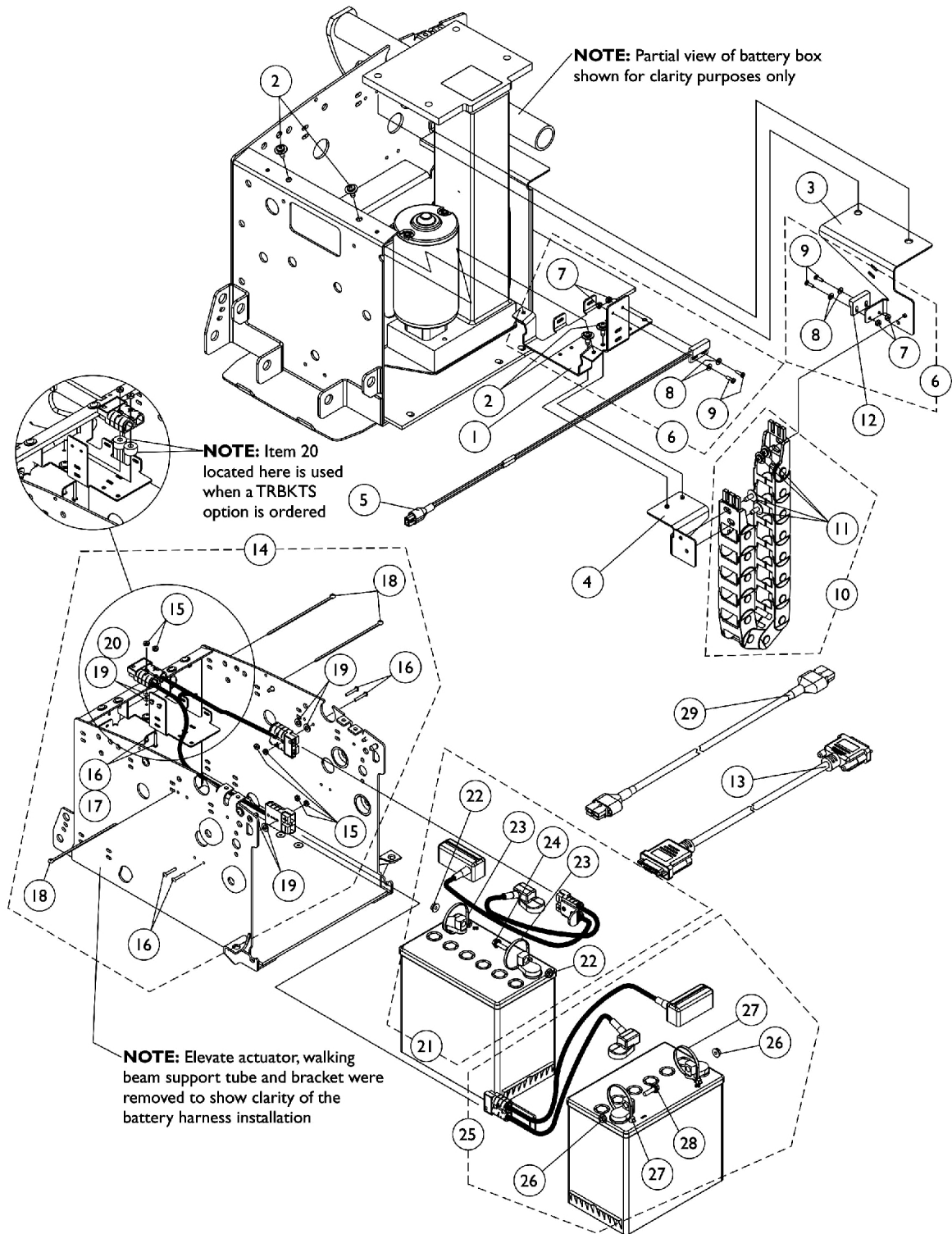

Battery Wire Harnesses, Sensor Proximity Switch, Extension Cables and Energy Chain For All Elevate Systems

Item Number	Note	Part Number	Description	Quantity Per	
				Package	Assembly
1		1124657-NLA	NLA - Bracket, Wire Harness Mounting, Black	1	1
2		1114308	Screw, Phillips Pan Head Tap (#10-32 x 1/2")	1	4
3		1124654-NLA	NLA - Bracket, Upper Energy Chain Mounting, Black	1	1
4		1124655-NLA	NLA - Bracket, Lower Energy Chain Mounting, Black	1	1
5		1122586	Sensor, Proximity Switch (30 1/4" L)	1	1
6	A	1125742	NLA - Kit, Sensor Proximity/Actuator Switch Mounting Hardware	1	1
7			Nut, Hex Keps (#4-40)	1	2
8			NLA - Washer, Plain (1/8 x 5/16 x 1/32")	1	2
9			NLA - Screw, Phillips Pan Head (#4-40 x 3/8")	1	2
10	F	1125745	Kit, Energy Chain with Mounting Hardware	1	1
11			Screw, Phillips Pan Head Tap (#10-32 x 1/2")	1	2
12		1024001	Sensor, Actuator Switch	1	1
13		1123277-NLA	NLA - Cable, Joystick Extension (48")	1	1
14	B	1125743-NLA	Kit, Battery Harness with Mounting Hardware, Elevate	1	1
15			NLA - Nut, Keps (#6-32)	1	6
16			NLA - Screw, Phillips Pan Head (#6-32 x 7/8")	1	6
18			Tie Wrap (5-5/8" L)	1	3
19			Washer (1/4 x 1/2 x 1/16")	1	4
14	C	1141968	NLA - Kit, Battery Harness with Mounting Hardware, Elevate with TRBKTS option	1	1
15			NLA - Nut, Keps (#6-32)	1	6
16			NLA - Screw, Phillips Pan Head (#6-32 x 7/8")	1	4
17			NLA - Screw, Phillips Pan Head (#6-32 x 1-1/8")	1	2
18			Tie Wrap (5-5/8" L)	1	3
19			Washer (1/4 x 1/2 x 1/16")	1	4
20			NLA - Spacer (1/4 x 5/8 x 3/8")	1	2
21	D	See Note	See Footnote	1	1
22		16721X000	Locknut (1/4-20)	1	2
23		1095502-NLA	NLA - Package, Tie Wrap (11-1/2" L)	10	1
24		1096799-NLA	NLA - Screw, Hex Flange Whiz Lock (1/4-20 x 7/8")	1	1
25	E	1125741-NLA	NLA - Kit, Front Battery Harness with Terminal Hardware	1	1
26			Locknut (1/4-20)	1	2
27			Tie Wrap (11-1/2" L)	1	4
28			NLA - Screw, Hex Flange Whiz Lock (1/4-20 x 7/8")	1	2
29		1126173	Harness, Elevate Actuator Extension	1	1

NOTE: A - Includes items 7-9
B - Includes the Battery Harness and items 15, 16, 18 and 19
C - Includes the Battery harness and items 15-20
D - Rear Battery Harness Kit that included the Rear Battery Harness is no longer available as a service part.
E - Includes the Front Battery Harness and items 26-28
F - Includes the Energy Chain and item 11