

# Quad Link Assembly

## Before 4/07/06

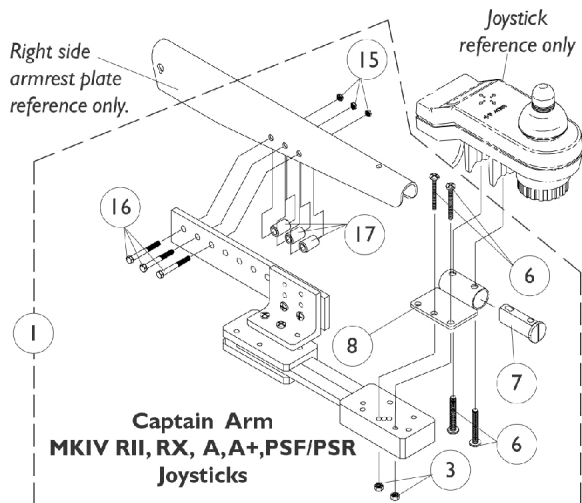
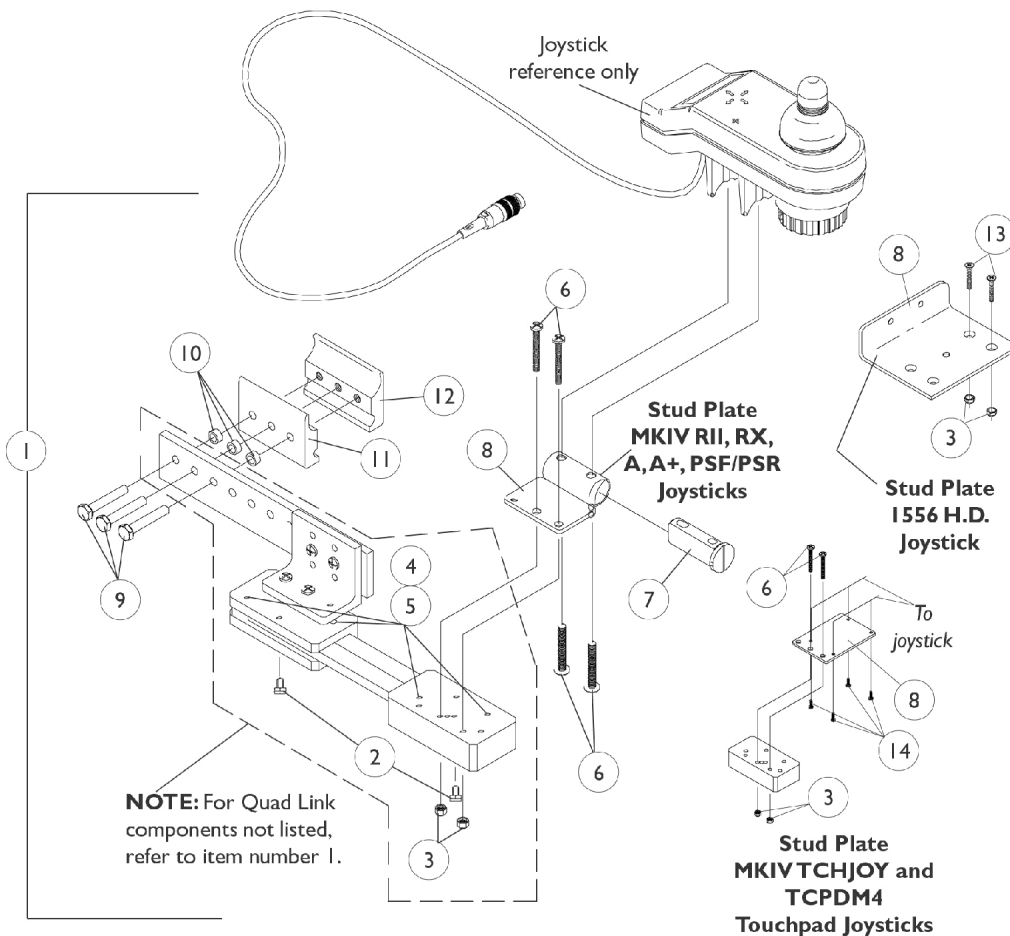

## Quad Link Assembly Before 4/07/06

| Item Number | Note | Part Number | Description   | Quantity Per |          |
|-------------|------|-------------|---|--------------|----------|
|             |      |             |   | Package      | Assembly |
| 1           | A    | 1052402-NLA | NLA - Kit, Quad Link Assembly - Right               | 1            | 1        |
| 2           |      |             | NLA - Ball Plunger Assembly with Lock Washer        | 2            | 1        |
| 3           |      |             | Locknut (#10-32)                                    | 1            | 2        |
| 4           |      |             | NLA - Screw, Cap, Socket Head (#10-32 x 1/2")       | 1            | 4        |
| 5           |      |             | NLA - Bushing, Bronze (3/16 x 1/4 x 1/4")           | 1            | 4        |
| 6           |      |             | Screw, Phillips Pan Head (#10-32 x 1-1/8")          | 1            | 4        |
| 7           |      |             | Spacer, Joystick Tube, Black                        | 1            | 1        |
| 8           |      |             | NLA - Stud Plate, Quad Link                         | 1            | 1        |
| 9           |      |             | Screw, Hex Head (1/4-20 x 1-1/2")                   | 1            | 3        |
| 10          |      |             | NLA - Spacer (1/4 x 3/8 x 3/16")                    | 1            | 3        |
| 11          |      |             | Half Clamp, Non-Threaded Holes                      | 1            | 1        |
| 12          |      |             | NLA - Half Clamp, Threaded Holes                    | 1            | 1        |
| 1           | A    | 1115372-NLA | NLA - Kit, Quad Link Assembly - Left                | 1            | 1        |
| 2           |      |             | NLA - Ball Plunger Assembly with Lock Washer        | 2            | 1        |
| 3           |      |             | Locknut (#10-32)                                    | 1            | 2        |
| 4           |      |             | NLA - Screw, Cap, Socket Head (#10-32 x 1/2")       | 1            | 4        |
| 5           |      |             | NLA - Bushing, Bronze (3/16 x 1/4 x 1/4")           | 1            | 4        |
| 6           |      |             | Screw, Phillips Pan Head (#10-32 x 1-1/8")          | 1            | 4        |
| 7           |      |             | Spacer, Joystick Tube, Black                        | 1            | 1        |
| 8           |      |             | NLA - Stud Plate, Quad Link                         | 1            | 1        |
| 9           |      |             | Screw, Hex Head (1/4-20 x 1-1/2")                   | 1            | 3        |
| 10          |      |             | NLA - Spacer (1/4 x 3/8 x 3/16")                    | 1            | 3        |
| 11          |      |             | Half Clamp, Non-Threaded Holes                      | 1            | 1        |
| 12          |      |             | NLA - Half Clamp, Threaded Holes                    | 1            | 1        |
| 1           | B,E  | 1034703-NLA | NLA - Kit, Quad Link Assembly - Right               | 1            | 1        |
| 2           |      |             | NLA - Ball Plunger Assembly with Lock Washer        | 2            | 1        |
| 3           |      |             | Locknut (#10-32)                                    | 1            | 2        |
| 4           |      |             | NLA - Screw, Cap, Socket Head (#10-32 x 1/2")       | 1            | 4        |
| 5           |      |             | NLA - Bushing, Bronze (3/16 x 1/4 x 1/4")           | 1            | 4        |
| 8           |      |             | Plate, Stud, Quad Link For 1556 Heavy Duty Joystick | 1            | 1        |
| 9           |      |             | Screw, Hex Head (1/4-20 x 1-1/2")                   | 1            | 3        |
| 10          |      |             | NLA - Spacer (1/4 x 3/8 x 3/16")                    | 1            | 3        |
| 11          |      |             | Half Clamp, Non-Threaded Holes                      | 1            | 1        |
| 12          |      |             | NLA - Half Clamp, Threaded Holes                    | 1            | 1        |
| 13          |      |             | Screw, Phillips Flat Head (#10-32 x 1-1/8")         | 1            | 2        |
| 1           | B    | 1114866-NLA | NLA - Kit, Quad Link Assembly - Left                | 1            | 1        |
| 2           |      |             | NLA - Ball Plunger Assembly with Lock Washer        | 2            | 1        |
| 3           |      |             | Locknut (#10-32)                                    | 1            | 2        |
| 4           |      |             | NLA - Screw, Cap, Socket Head (#10-32 x 1/2")       | 1            | 4        |
| 5           |      |             | NLA - Bushing, Bronze (3/16 x 1/4 x 1/4")           | 1            | 4        |
| 8           |      |             | Plate, Stud, Quad Link For 1556 Heavy Duty Joystick | 1            | 1        |
| 9           |      |             | Screw, Hex Head (1/4-20 x 1-1/2")                   | 1            | 3        |
| 10          |      |             | NLA - Spacer (1/4 x 3/8 x 3/16")                    | 1            | 3        |
| 11          |      |             | Half Clamp, Non-Threaded Holes                      | 1            | 1        |

## Quad Link Assembly Before 4/07/06

| Item Number | Note                             | Part Number | Description  | Quantity Per |          |
|-------------|----------------------------------|-------------|--|--------------|----------|
|             |                                  |             |  | Package      | Assembly |
| 12          | C                                | 1102027-NLA | NLA - Half Clamp, Threaded Holes                                 | 1            | 1        |
| 13          |                                  |             | Screw, Phillips Flat Head (#10-32 x 1-1/8")                      | 1            | 2        |
| 1           |                                  |             | NLA - Kit, Quad Link Assembly - Right For TCHJOY/TCPDM4 Touchpad | 1            | 1        |
| 2           |                                  |             | NLA - Ball Plunger Assembly with Lock Washer                     | 2            | 1        |
| 3           |                                  |             | Locknut (#10-32)   | 1            | 2        |
| 4           |                                  |             | NLA - Screw, Cap, Socket Head (#10-32 x 1/2")                    | 1            | 4        |
| 5           |                                  |             | NLA - Bushing, Bronze (3/16 x 1/4 x 1/4")                        | 1            | 4        |
| 6           |                                  |             | Screw, Phillips Pan Head (#10-32 x 1-1/8")                       | 1            | 2        |
| 8           |                                  |             | NLA - Plate, Stud, Quad Link MKIV TCHJOY/TCPDM4                  | 1            | 1        |
| 9           |                                  |             | Screw, Hex Head (1/4-20 x 1-1/2")                                | 1            | 3        |
| 10          |                                  |             | NLA - Spacer (1/4 x 3/8 x 3/16")                                 | 1            | 3        |
| 11          |                                  |             | Half Clamp, Non-Threaded Holes                                   | 1            | 1        |
| 12          |                                  |             | NLA - Half Clamp, Threaded Holes                                 | 1            | 1        |
| 14          |                                  |             | NLA - Screw, Phillips Flat Head Countersunk (#4-40 x 3/8")       | 1            | 4        |
| 1           | D                                | 1074153-NLA | NLA - Kit, Quad Link Assembly - Right For Van Seats              | 1            | 1        |
| 2           |                                  |             | NLA - Ball Plunger Assembly with Lock Washer                     | 2            | 1        |
| 3           |                                  |             | Locknut (#10-32)   | 1            | 2        |
| 4           |                                  |             | NLA - Screw, Cap, Socket Head (#10-32 x 1/2")                    | 1            | 4        |
| 5           |                                  |             | NLA - Bushing, Bronze (3/16 x 1/4 x 1/4")                        | 1            | 4        |
| 6           |                                  |             | Screw, Phillips Pan Head (#10-32 x 1-1/8")                       | 1            | 4        |
| 7           |                                  |             | Spacer, Joystick Tube, Black                                     | 1            | 1        |
| 8           |                                  |             | NLA - Stud Plate, Quad Link                                      | 1            | 1        |
| 15          |                                  |             | Locknut (1/4-20)   | 1            | 3        |
| 16          |                                  |             | Screw, Hex Head (1/4-20 x 1-1/2")                                | 1            | 3        |
| 17          | NLA - Spacer (1/4 x 7/16 x 5/8") | 1           | 3  |              |          |
| 2           |                                  | 1114863-NLA | NLA - Ball Plunger Assembly with Lock Washer                     | 2            | 1        |

NOTE: A - Includes the Quad Link, items 2-12 and used with MKIV RII, RX, A, A+,PSF/PSR joysticks  
B - Includes the Quad Link, items 2-5, 8-13 and used with a 1556 Heavy Duty joystick  
C - Includes the Quad Link, items 2-6, 8-12, 14 and used with MKIV TCHJOY/TCPDM4 joysticks. Left side mounted Quad Link must be ordered as a special  
D - Includes the Quad Link, items 2-8, 15-17 and used with MKIV RII, RX, A, A+, PSF/PSR joysticks attached to a van seat. Left side mounted Quad Link must be ordered as a special  
E - Quad Link Assembly is no longer available. Please see Quad Link Assembly (After 4/06/06) category and use new Quad Link design as a replacement.