

Quad Link Assembly

Before 4/07/06

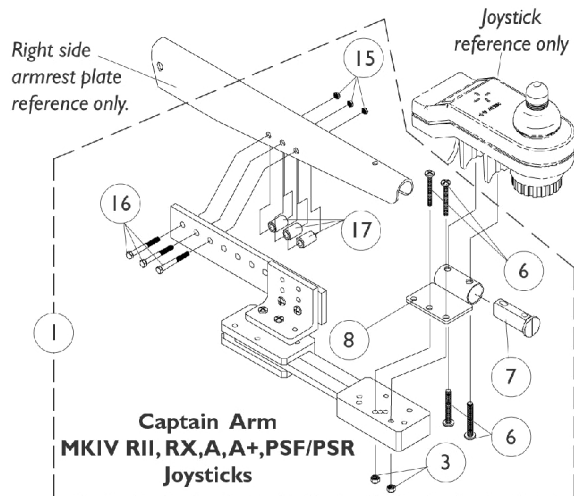
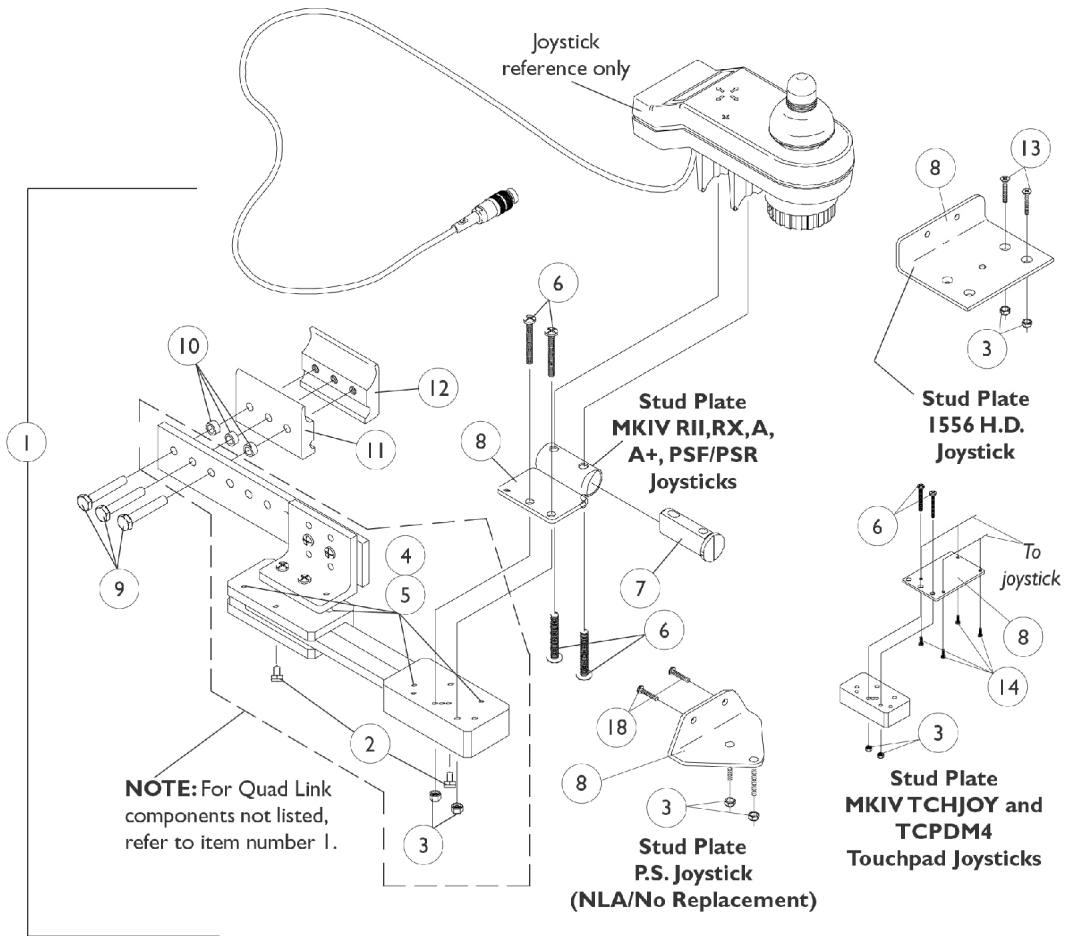

Quad Link Assembly Before 4/07/06

| Item Number | Note | Part Number | Description | Quantity Per | |
|-------------|------|----------------------------------|---|--------------|----------|
| | | | | Package | Assembly |
| 1 | A | 1052402-NLA | NLA - Kit, Quad Link Assembly - Right | 1 | 1 |
| 2 | | | NLA - Ball Plunger Assembly with Lock Washer | 2 | 1 |
| 3 | | | Locknut (#10-32) | 1 | 2 |
| 4 | | | NLA - Screw, Cap, Socket Head (#10-32 x 1/2") | 1 | 4 |
| 5 | | | NLA - Bushing, Bronze (3/16 x 1/4 x 1/4") | 1 | 4 |
| 6 | | | Screw, Phillips Pan Head (#10-32 x 1-1/8") | 1 | 4 |
| 7 | | | Spacer, Joystick Tube, Black | 1 | 1 |
| 8 | | | NLA - Stud Plate, Quad Link | 1 | 1 |
| 9 | | | Screw, Hex Head (1/4-20 x 1-1/2") | 1 | 3 |
| 10 | | | NLA - Spacer (1/4 x 3/8 x 3/16") | 1 | 3 |
| 11 | | | Half Clamp, Non-Threaded Holes | 1 | 1 |
| 12 | | NLA - Half Clamp, Threaded Holes | 1 | 1 | |
| 1 | A | 1115372-NLA | NLA - Kit, Quad Link Assembly - Left | 1 | 1 |
| 2 | | | NLA - Ball Plunger Assembly with Lock Washer | 2 | 1 |
| 3 | | | Locknut (#10-32) | 1 | 2 |
| 4 | | | NLA - Screw, Cap, Socket Head (#10-32 x 1/2") | 1 | 4 |
| 5 | | | NLA - Bushing, Bronze (3/16 x 1/4 x 1/4") | 1 | 4 |
| 6 | | | Screw, Phillips Pan Head (#10-32 x 1-1/8") | 1 | 4 |
| 7 | | | Spacer, Joystick Tube, Black | 1 | 1 |
| 8 | | | NLA - Stud Plate, Quad Link | 1 | 1 |
| 9 | | | Screw, Hex Head (1/4-20 x 1-1/2") | 1 | 3 |
| 10 | | | NLA - Spacer (1/4 x 3/8 x 3/16") | 1 | 3 |
| 11 | | | Half Clamp, Non-Threaded Holes | 1 | 1 |
| 12 | | NLA - Half Clamp, Threaded Holes | 1 | 1 | |
| 1 | B,F | 1034703-NLA | NLA - Kit, Quad Link Assembly - Right | 1 | 1 |
| 2 | | | NLA - Ball Plunger Assembly with Lock Washer | 2 | 1 |
| 3 | | | Locknut (#10-32) | 1 | 2 |
| 4 | | | NLA - Screw, Cap, Socket Head (#10-32 x 1/2") | 1 | 4 |
| 5 | | | NLA - Bushing, Bronze (3/16 x 1/4 x 1/4") | 1 | 4 |
| 8 | | | Plate, Stud, Quad Link For 1556 Heavy Duty Joystick | 1 | 1 |
| 9 | | | Screw, Hex Head (1/4-20 x 1-1/2") | 1 | 3 |
| 10 | | | NLA - Spacer (1/4 x 3/8 x 3/16") | 1 | 3 |
| 11 | | | Half Clamp, Non-Threaded Holes | 1 | 1 |
| 12 | | | NLA - Half Clamp, Threaded Holes | 1 | 1 |
| 13 | | | Screw, Phillips Flat Head (#10-32 x 1-1/8") | 1 | 2 |
| 1 | B | 1114866-NLA | NLA - Kit, Quad Link Assembly - Left | 1 | 1 |
| 2 | | | NLA - Ball Plunger Assembly with Lock Washer | 2 | 1 |
| 3 | | | Locknut (#10-32) | 1 | 2 |
| 4 | | | NLA - Screw, Cap, Socket Head (#10-32 x 1/2") | 1 | 4 |
| 5 | | | NLA - Bushing, Bronze (3/16 x 1/4 x 1/4") | 1 | 4 |
| 8 | | | Plate, Stud, Quad Link For 1556 Heavy Duty Joystick | 1 | 1 |
| 9 | | | Screw, Hex Head (1/4-20 x 1-1/2") | 1 | 3 |
| 10 | | | NLA - Spacer (1/4 x 3/8 x 3/16") | 1 | 3 |
| 11 | | | Half Clamp, Non-Threaded Holes | 1 | 1 |

Quad Link Assembly Before 4/07/06

| Item Number | Note | Part Number | Description | Quantity Per | |
|-------------|------|-------------|---|--------------|----------|
| | | | | Package | Assembly |
| 12 | | | NLA - Half Clamp, Threaded Holes | 1 | 1 |
| 13 | | | Screw, Phillips Flat Head (#10-32 x 1-1/8") | 1 | 2 |
| 1 | C | 1102027-NLA | NLA - Kit, Quad Link Assembly - Right For TCHJOY/TCPDM4 Touchpad | 1 | 1 |
| 2 | | | NLA - Ball Plunger Assembly with Lock Washer | 2 | 1 |
| 3 | | | Locknut (#10-32) | 1 | 2 |
| 4 | | | NLA - Screw, Cap, Socket Head (#10-32 x 1/2") | 1 | 4 |
| 5 | | | NLA - Bushing, Bronze (3/16 x 1/4 x 1/4") | 1 | 4 |
| 6 | | | Screw, Phillips Pan Head (#10-32 x 1-1/8") | 1 | 2 |
| 8 | | | NLA - Plate, Stud, Quad Link MKIV TCHJOY/TCPDM4 | 1 | 1 |
| 9 | | | Screw, Hex Head (1/4-20 x 1-1/2") | 1 | 3 |
| 10 | | | NLA - Spacer (1/4 x 3/8 x 3/16") | 1 | 3 |
| 11 | | | Half Clamp, Non-Threaded Holes | 1 | 1 |
| 12 | | | NLA - Half Clamp, Threaded Holes | 1 | 1 |
| 14 | | | NLA - Screw, Phillips Flat Head Countersunk (#4-40 x 3/8") | 1 | 4 |
| 1 | D | 1074153-NLA | NLA - Kit, Quad Link Assembly - Right For Van Seats | 1 | 1 |
| 2 | | | NLA - Ball Plunger Assembly with Lock Washer | 2 | 1 |
| 3 | | | Locknut (#10-32) | 1 | 2 |
| 4 | | | NLA - Screw, Cap, Socket Head (#10-32 x 1/2") | 1 | 4 |
| 5 | | | NLA - Bushing, Bronze (3/16 x 1/4 x 1/4") | 1 | 4 |
| 6 | | | Screw, Phillips Pan Head (#10-32 x 1-1/8") | 1 | 4 |
| 7 | | | Spacer, Joystick Tube, Black | 1 | 1 |
| 8 | | | NLA - Stud Plate, Quad Link | 1 | 1 |
| 15 | | | Locknut (1/4-20) | 1 | 3 |
| 16 | | | Screw, Hex Head (1/4-20 x 1-1/2") | 1 | 3 |
| 17 | | | NLA - Spacer (1/4 x 7/16 x 5/8") | 1 | 3 |
| 1 | E | 1106191-NLA | NLA - Kit, Quad Link Assembly - Right For PS joystick | 1 | 1 |
| 2 | | | NLA - Ball Plunger Assembly with Lock Washer | 2 | 1 |
| 3 | | | Locknut (#10-32) | 1 | 2 |
| 4 | | | NLA - Screw, Cap, Socket Head (#10-32 x 1/2") | 1 | 4 |
| 5 | | | NLA - Bushing, Bronze (3/16 x 1/4 x 1/4") | 1 | 4 |
| 8 | | | NLA - Plate, Stud, Quad Link P.S. Joystick | 1 | 1 |
| 9 | | | Screw, Hex Head (1/4-20 x 1-1/2") | 1 | 3 |
| 10 | | | NLA - Spacer (1/4 x 3/8 x 3/16") | 1 | 3 |
| 11 | | | Half Clamp, Non-Threaded Holes | 1 | 1 |
| 12 | | | NLA - Half Clamp, Threaded Holes | 1 | 1 |
| 18 | | | Screw, Phillips Pan Head (#10-32 x 11/16") | 1 | 2 |
| 2 | | 1114863-NLA | NLA - Ball Plunger Assembly with Lock Washer | 2 | 1 |

Quad Link Assembly

Before 4/07/06

NOTE: A - Includes the Quad Link, items 2-12 and used with MKIV RII, RX, A, A+, PSF/PSR joysticks
B - Includes the Quad Link, items 2-5, 8-13 and used with a 1556 Heavy duty joystick
C - Includes the Quad Link, items 2-6, 8-12, 14 and used with MKIV TCHJOY/TCPDM4 joysticks. For left side mounted Quad Link, order as a special.
D - Includes the Quad Link, items 2-8, 15-17 and used with MKIV RII, RX, A, A+, PSF/PSR joysticks for Van Seats. For left side mounted Quad Link, order as a special.
E - Includes the Quad Link, items 2-5, 8-12, 18 and used with a PS joystick.
F - Quad Link Assembly is no longer available. Please see Quad Link Assembly (After 4/06/06) category and use new Quad Link design as a replacement.