

Quad Link Assembly

Before 4/07/06

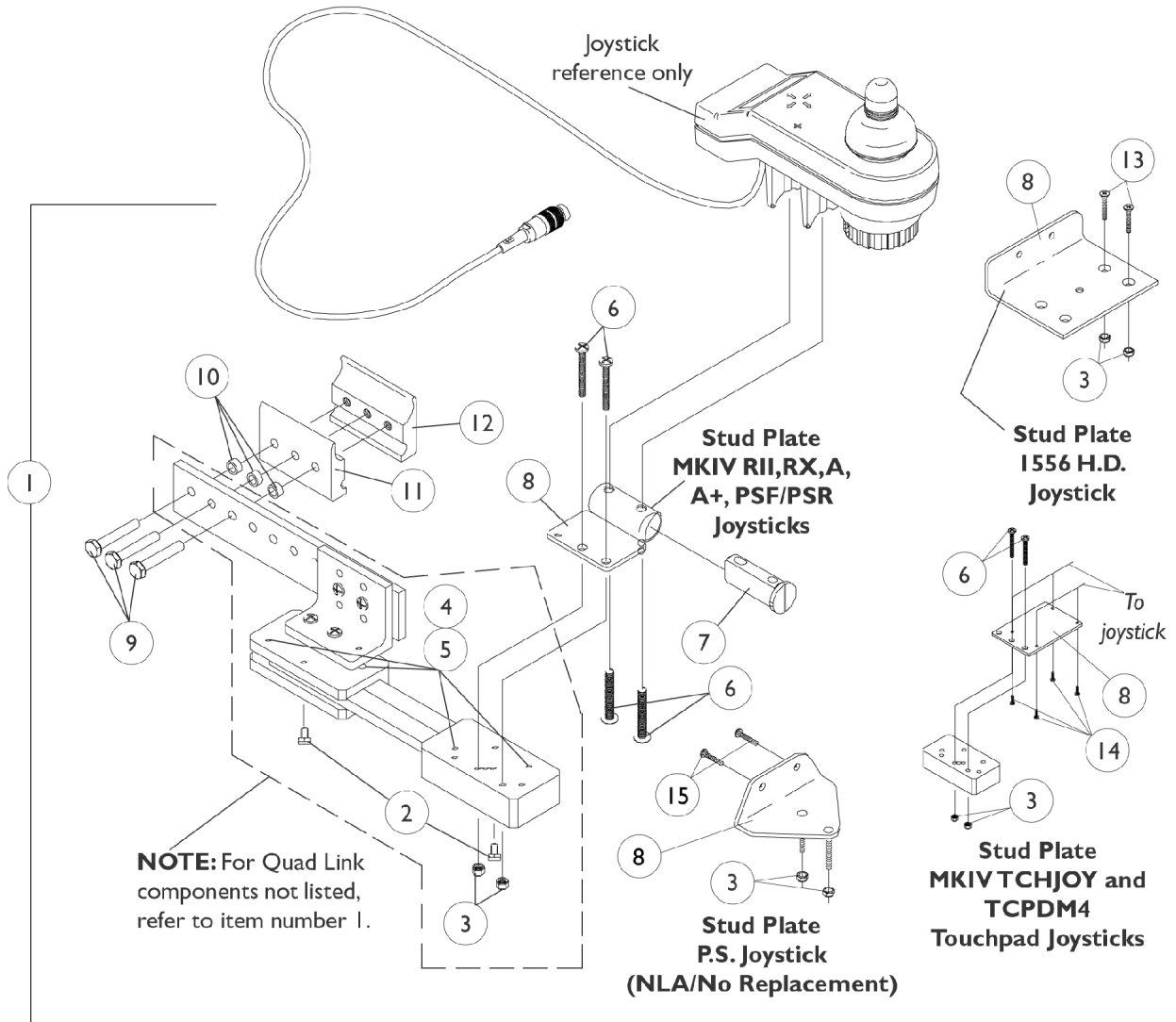

Quad Link Assembly Before 4/07/06

Item Number	Note	Part Number	Description	Quantity Per	
				Package	Assembly
1	A	1052402-NLA	NLA - Kit, Quad Link Assembly - Right	1	1
2			NLA - Ball Plunger Assembly with Lock Washer	2	1
3			Locknut (#10-32)	1	2
4			NLA - Screw, Cap, Socket Head (#10-32 x 1/2")	1	4
5			NLA - Bushing, Bronze (3/16 x 1/4 x 1/4")	1	4
6			Screw, Phillips Pan Head (#10-32 x 1-1/8")	1	4
7			Spacer, Joystick Tube, Black	1	1
8			NLA - Stud Plate, Quad Link	1	1
9			Screw, Hex Head (1/4-20 x 1-1/2")	1	3
10			NLA - Spacer (1/4 x 3/8 x 3/16")	1	3
11		Half Clamp, Non-Threaded Holes	1	1	
12		NLA - Half Clamp, Threaded Holes	1	1	
1	A	1115372-NLA	NLA - Kit, Quad Link Assembly - Left	1	1
2			NLA - Ball Plunger Assembly with Lock Washer	2	1
3			Locknut (#10-32)	1	2
4			NLA - Screw, Cap, Socket Head (#10-32 x 1/2")	1	4
5			NLA - Bushing, Bronze (3/16 x 1/4 x 1/4")	1	4
6			Screw, Phillips Pan Head (#10-32 x 1-1/8")	1	4
7			Spacer, Joystick Tube, Black	1	1
8			NLA - Stud Plate, Quad Link	1	1
9			Screw, Hex Head (1/4-20 x 1-1/2")	1	3
10			NLA - Spacer (1/4 x 3/8 x 3/16")	1	3
11		Half Clamp, Non-Threaded Holes	1	1	
12		NLA - Half Clamp, Threaded Holes	1	1	
1	B,E	1034703-NLA	NLA - Kit, Quad Link Assembly - Right	1	1
2			NLA - Ball Plunger Assembly with Lock Washer	2	1
3			Locknut (#10-32)	1	2
4			NLA - Screw, Cap, Socket Head (#10-32 x 1/2")	1	4
5			NLA - Bushing, Bronze (3/16 x 1/4 x 1/4")	1	4
8			Plate, Stud, Quad Link For 1556 Heavy Duty Joystick	1	1
9			Screw, Hex Head (1/4-20 x 1-1/2")	1	3
10			NLA - Spacer (1/4 x 3/8 x 3/16")	1	3
11			Half Clamp, Non-Threaded Holes	1	1
12			NLA - Half Clamp, Threaded Holes	1	1
13		Screw, Phillips Flat Head (#10-32 x 1-1/8")	1	2	
1	B	1114866-NLA	NLA - Kit, Quad Link Assembly - Left	1	1
2			NLA - Ball Plunger Assembly with Lock Washer	2	1
3			Locknut (#10-32)	1	2
4			NLA - Screw, Cap, Socket Head (#10-32 x 1/2")	1	4
5			NLA - Bushing, Bronze (3/16 x 1/4 x 1/4")	1	4
8			Plate, Stud, Quad Link For 1556 Heavy Duty Joystick	1	1
9			Screw, Hex Head (1/4-20 x 1-1/2")	1	3
10			NLA - Spacer (1/4 x 3/8 x 3/16")	1	3
11			Half Clamp, Non-Threaded Holes	1	1

Quad Link Assembly Before 4/07/06

Item Number	Note	Part Number	Description	Quantity Per			
				Package	Assembly		
12	C	1102027-NLA	NLA - Half Clamp, Threaded Holes	1	1		
13			Screw, Phillips Flat Head (#10-32 x 1-1/8")	1	2		
1			NLA - Kit, Quad Link Assembly - Right For TCHJOY/TCPDM4 Touchpad	1	1		
2			NLA - Ball Plunger Assembly with Lock Washer	2	1		
3			Locknut (#10-32)	1	2		
4			NLA - Screw, Cap, Socket Head (#10-32 x 1/2")	1	4		
5			NLA - Bushing, Bronze (3/16 x 1/4 x 1/4")	1	4		
6			Screw, Phillips Pan Head (#10-32 x 1-1/8")	1	2		
8			NLA - Plate, Stud, Quad Link MKIV TCHJOY/TCPDM4	1	1		
9			Screw, Hex Head (1/4-20 x 1-1/2")	1	3		
10			NLA - Spacer (1/4 x 3/8 x 3/16")	1	3		
11			Half Clamp, Non-Threaded Holes	1	1		
12			NLA - Half Clamp, Threaded Holes	1	1		
14			NLA - Screw, Phillips Flat Head Countersunk (#4-40 x 3/8")	1	4		
1	D	1106191-NLA	NLA - Kit, Quad Link Assembly - Right For PS joystick	1	1		
2			NLA - Ball Plunger Assembly with Lock Washer	2	1		
3			Locknut (#10-32)	1	2		
4			NLA - Screw, Cap, Socket Head (#10-32 x 1/2")	1	4		
5			NLA - Bushing, Bronze (3/16 x 1/4 x 1/4")	1	4		
8			NLA - Plate, Stud, Quad Link P.S. Joystick	1	1		
9			Screw, Hex Head (1/4-20 x 1-1/2")	1	3		
10			NLA - Spacer (1/4 x 3/8 x 3/16")	1	3		
11			Half Clamp, Non-Threaded Holes	1	1		
12			NLA - Half Clamp, Threaded Holes	1	1		
15			Screw, Phillips Pan Head (#10-32 x 11/16")	1	2		
2			1114863-NLA	NLA - Ball Plunger Assembly with Lock Washer	2	1	
<p>NOTE: A - Includes the Quad Link, items 2-12 and used with MKIV RII, RX, A, A+, PSF/PSR joysticks B - Includes the Quad Link, items 2-5, 8-13 and used with a 1556 Heavy Duty joystick C - Includes the Quad Link, items 2-6, 8-12, 14 and used with MKIV TCHJOY/TCPDM4 joysticks. For left side mounted Quad Link, order as a special. D - Includes the Quad Link, items 2-5, 8-12, 15 and used with a PS joystick E - Quad Link Assembly is no longer available. Please see Quad Link Assembly (After 4/06/06) category and use new Quad Link design as a replacement.</p>							