

# Max Controller 5.0, 5.5 & 4-Way Switch Tilt Only

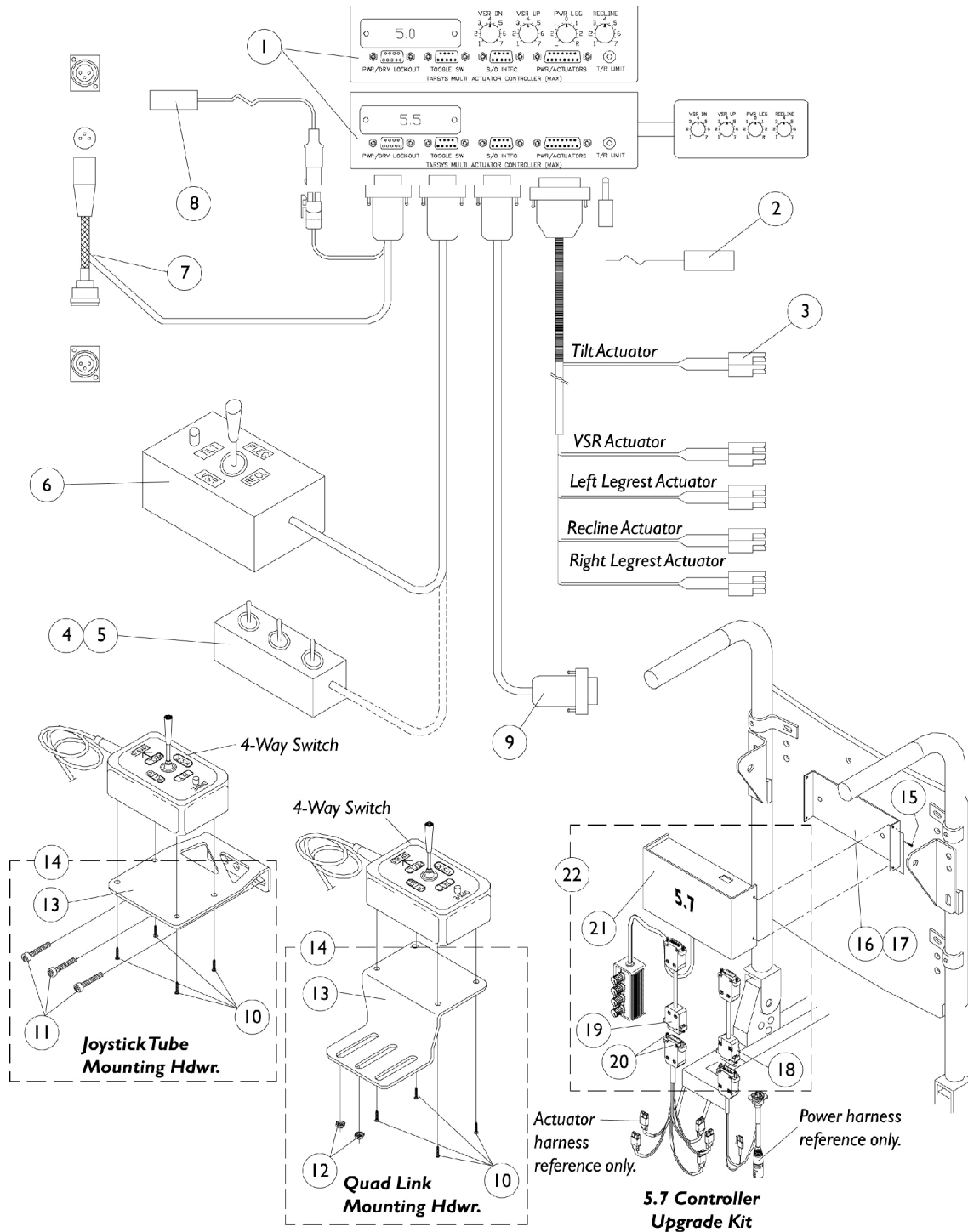

## Max Controller 5.0, 5.5 & 4-Way Switch Tilt Only

Item Number	Note	Part Number	Description	Quantity Per	
				Package	Assembly
1		0020000	Controller, MAX (5.0)	1	1
1		0189000	Controller, MAX (5.5)	1	1
2	E	0018500-NLA	NLA - Switch, Limit	1	1
3		0019000	Harness, Actuator	1	1
4		0038100-NLA	NLA - Box, Switch, Triple	1	1
4		0037900-NLA	NLA - Box, Switch, Double	1	1
4		0038000	Box, Switch, Single	1	1
5		1077304	Dual Lock, Male/ Female Adhesive Back (1" x 3")	1	1
6		0279800-NLA	NLA - Box, Four Way Switch	1	1
7		0118100-NLA	NLA - Harness, Power, Storm, Square Plug	1	1
7		0190200-NLA	NLA - Power Harness, Storm, Round Plug	1	1
8	C	0018600-NLA	NLA - Switch, Limit - Molex Style	1	1
9		0200300-NLA	NLA - Cable, Interface, Power Legs Combined	1	1
9		0015000	Cable, Interface, Power Legs Independent (1 or 2 Functions)	1	1
9		0014800	Cable, Interface, Invacare R.I.M. Control	1	1
9		0015400-NLA	NLA - Cable, Interface, Peachtree Power Legs Combined	1	1
10		1072695-NLA	NLA - Screw, Phillips Pan Head Tap (#6 x 1/2")	1	4
11		7930304-NLA	NLA - Screw, Socket Head (1/4-20 x 1-1/4")	25	3
12		317601-NLA	NLA - Locknut, Low Profile (#10-32)	1	2
13	G	0194602-NLA	NLA - Plate, Joystick Tube Mounting	1	1
13	F	0212002-NLA	NLA - Plate, Quad Link Mounting	1	1
14	G	1077266-NLA	NLA - Mounting Plate Assembly, Joystick Tube	1	1
14	F	1077267	Mounting Plate Assembly, Quad Link	1	1
15		0067906-NLA	NLA - Screw, Phillips Head (#4-40 x 1/4")	1	4
16		0117206-NLA	NLA - Plate, Max Controller Mounting (4.0-5.5)	1	1
17	D	7930333	Locknut (1/4-20)	25	2
18		0279600-NLA	NLA - Adapter Cable, Power Harness 5.7 to 5.0-5.5	1	1
19		0279500-NLA	NLA - Adapter Cable, Actuator Harness 5.7 to 5.0-5.5	1	1
20		1082368-NLA	NLA - Stand-Off (1/4" D x 1/4" L #4-40)	1	4
21		1081573	Controller, MAX 5.7 (For Upgrade Kit Only)	1	1
22	B	1081827-NLA	NLA - Kit, MAX Controller Upgrade (5.7)	1	1
	A	1085399	Instruction Sheet, MAX Controller 5.7 Upgrade Kit	1	1

NOTE: A - Not Shown  
B - Includes items 18-21 and Instruction Sheet  
C - Drive Lockout  
D - Anchors Mounting Plate to Back Assembly  
E - Tilt and Recline  
F - Use with Quad Link before 4/07/06  
G - Use with Joystick Tube and Quad Link (QLA) after 4/06/06