

Quad Link Assembly (QL)

After 4/06/06

When converting an old style Quad Link that attaches to a mounting plate is currently on the chair then order the following for Van Seat; Quad Link Mtg. Hdwr. (item 12), Quad Link (item 1) & Joystick Tube Clamp (item 14)

NOTE: Substitute (item 4) with 2 ea. of the PPH Screws (item 5) when an offset joystick tube is currently on the chair.

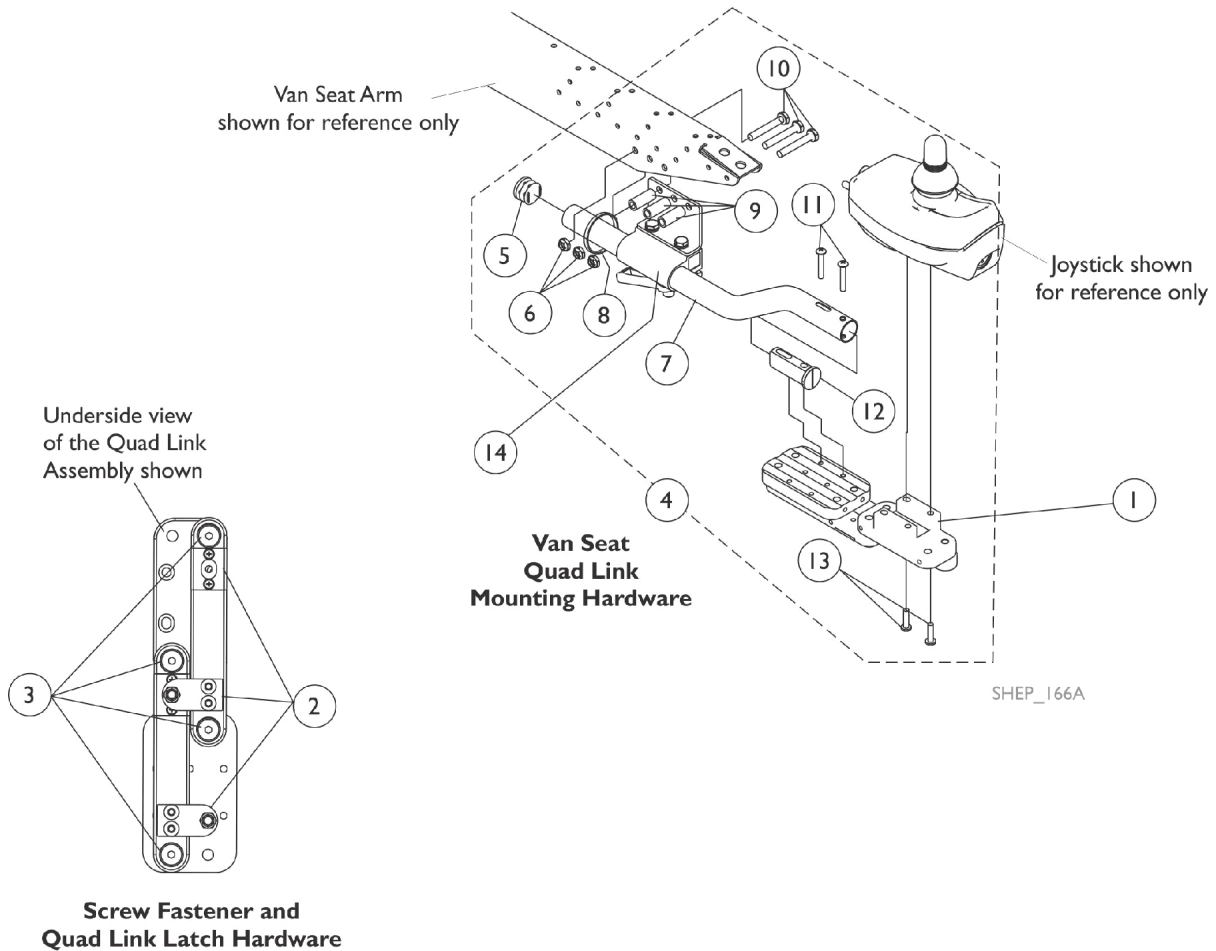

Quad Link Assembly (QL)

After 4/06/06

When converting an old style Quad Link that attaches to a mounting plate is currently on the chair then order the following for Van Seat; Quad Link Mtg. Hdwr. (item 12), Quad Link (item 1) & Joystick Tube Clamp (item 14)

NOTE: Substitute (item 4) with 2 ea. of the PPH Screws (item 5) when an offset joystick tube is currently on the chair.

Item Number	Note	Part Number	Description	Quantity Per	
				Package	Assembly
1		1140898	Quad Link (QL) with Instruction Sheet - Right	1	1
1		1140899	Quad Link (QL) with Instruction Sheet - Left	1	1
2	A	1140425	Kit, Quad Link Latch Hardware	1	1
3	B	1140424-NLA	NLA - Kit, Quad Link Screw Fastener Hardware	1	1
4	C,E,E1	1143042	Kit, Quad Link Mounting Hardware - Van Seat	1	1
5			Plug Button, Black (7/8")	1	1
6			NLA - Locknut (1/4-20)	1	3
7			Tube, Joystick Offset (2")	1	1
8			Tie Wrap (11-1/2" L)	1	1
9			Spacer (1/4 x 3/8 x 1")	1	3
10			Screw, Hex Head (1/4-20 x 1-5/8")	1	3
11			Screw, Phillips Pan Head (#10-32 x 1-1/8")	1	2
12			Spacer, Joystick Tube, Black	1	1
13			Screw, Phillips Pan Head w/ Patch (#10-32 x 3/4")	1	2
14		1139681	Clamp Assembly, Fixed Height, Captain/ Van Seat	1	1
	D	1134844	Instruction Sheet, Quad Link	1	1
<p>NOTE: A - Latch Kit includes 4 ea. Button Head Cap Screws (10-32 x 3/8"), 2 ea. Latch Spring Assembly, 4 ea. Phillips Flat C/Sunk Head Screws, 2 ea. Spring Catch Plates, 2 ea. Socket Head Set Screws (10-32 x 3/8") B - Screw Fastener Kit includes 4 ea. Socket Head Shoulder Screws (3/8 x 3/8"), 2 ea. Socket Head Cap Screws (1/4-20 x 3/8"), 2 ea. Socket Head Set Screws (1/4-20 x 1/2"), 4 ea. Socket Head Set Screws (10-32 x 1/8") C - Includes items 5-13 D - Not Shown E - If Quad Link is to be mounted on chairs w/ van seats built Before 4/07/06, then a new Upper Arm Asbly. (adj. height) or complete Fixed Height Arm Asbly. must be ordered as well. See van seat arms category. E1 - The new Arm Pads have 3 additional holes drilled in the armrest plate so that the quad link can be properly mounted.</p>					