

Wheel Locks & Attaching Hardware

Push/Pull to Lock

Wheel Locks can be converted from Push to Pull or Pull to Push. See Prospin X4 Owner's Manual (1125104) for instructions.

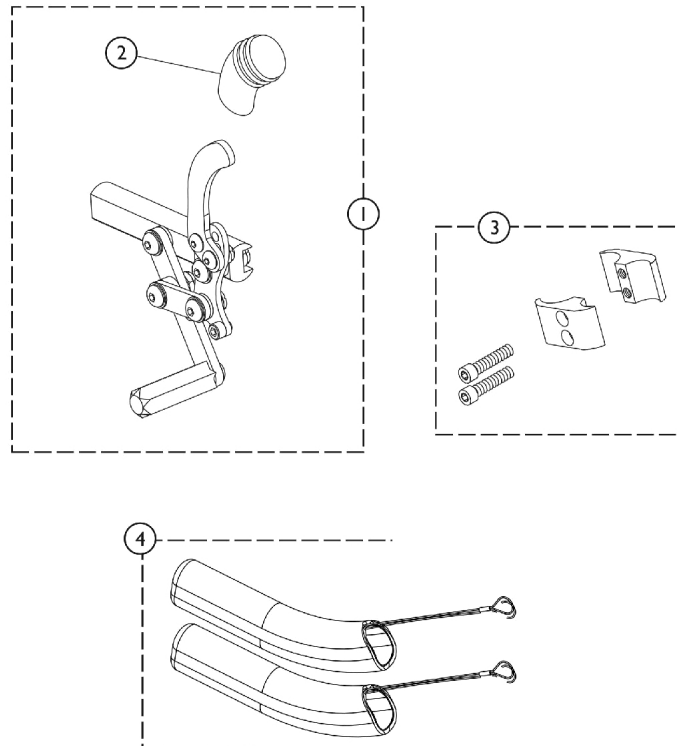

| Item Number | Note | Part Number | Description | Quantity Per | |
|-------------|------|-------------|--|--------------|----------|
| | | | | Package | Assembly |
| 1 | A,C | 1125459 | Wheel Lock Assembly, Push/Pull - Right | 1 | 1 |
| 1 | A,C | 1125460 | Wheel Lock Assembly, Push/Pull - Left | 1 | 1 |
| 1 | B,C | 1134129 | Wheel Lock Assembly, Push/Pull for Amputee - Right | 1 | 1 |
| 1 | B,C | 1134130 | Wheel Lock Assembly, Push/Pull for Amputee - Left | 1 | 1 |
| 2 | | 1130584 | Package, Cap, Brake Lever End, Black | 10 | 1 |
| 3 | D | 1068210-NLA | Kit, Wheel Lock Attaching Hardware (1" Tubing) | 1 | 1 |
| | | | Screw, Allen Head (1/4-20 x 1") | 1 | 2 |
| | | | Clamp, Half, Non-Threaded | 1 | 1 |
| | | | Clamp, Half, Threaded | 1 | 1 |
| 4 | | 1146498 | Handle, Wheel Lock Extension, Black (6") (Pair) | 1 | 2 |

NOTE: A - Chairs without Amputee Attachment
 B - Chairs with Amputee Attachment
 C - Wheel Locks can be converted from Push to Pull or Pull to Push. See Owner's Manual for instructions.
 D - Includes 2 ea. half clamps and 2 ea. screws