

TRSS Toggle and Mounting Hardware

Conventional Tilt & Tilt w/ BPO Option

(After 1/16/05)

As of 7/1/2009, switches are mercury free. TRSS Tilt Recline Single Switch is not used with MK6i electronics.

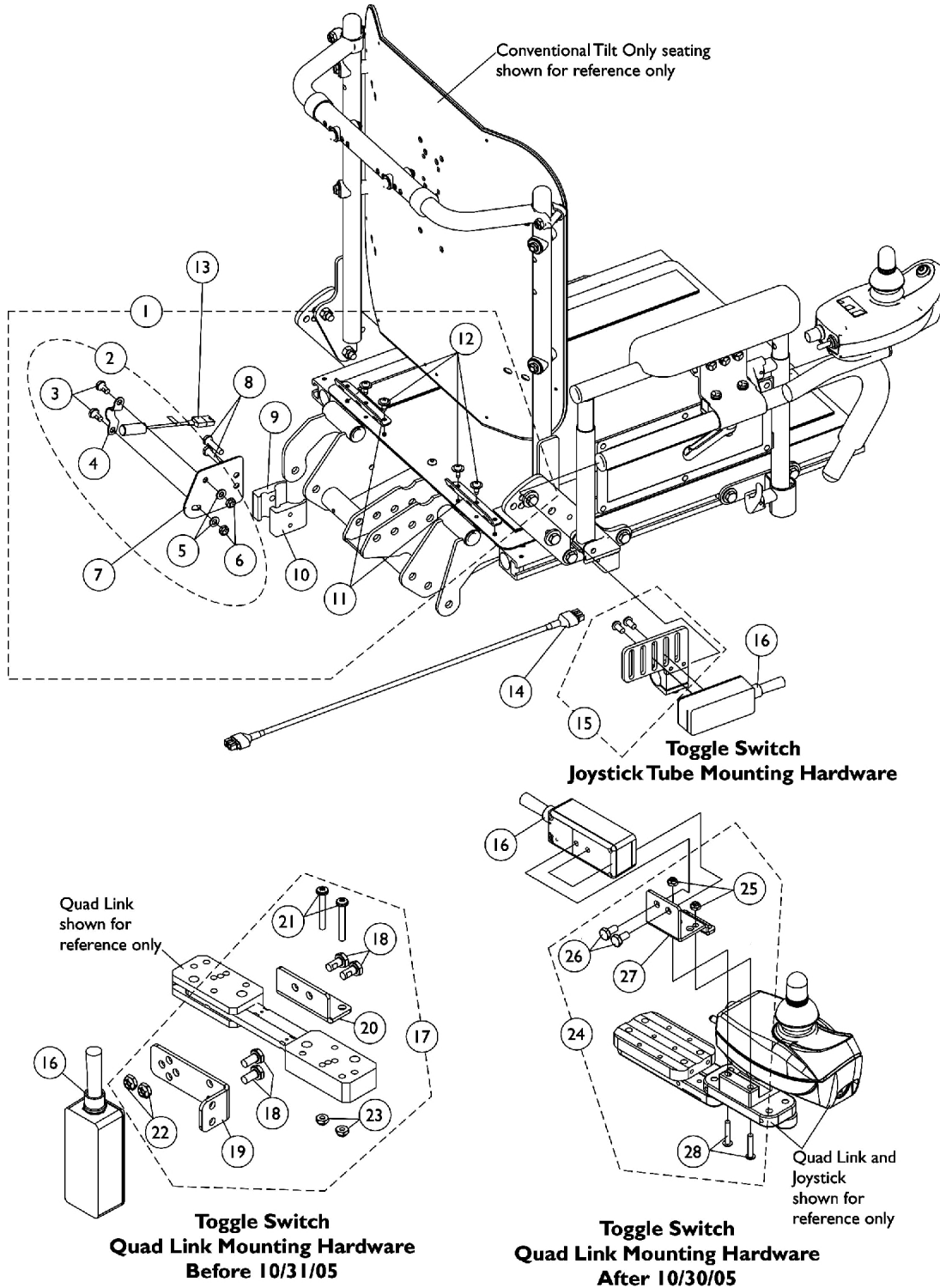

TRSS Toggle and Mounting Hardware

Conventional Tilt & Tilt w/ BPO Option

(After 1/16/05)

As of 7/1/2009, switches are mercury free. TRSS Tilt Recline Single Switch is not used with MK6i electronics.

Item Number	Note	Part Number	Description	Quantity Per	
				Package	Assembly
1	A	1128357-NLA	NLA - Kit, Switch Brackets with Hardware For Conventional Tilt Only with TRSS	1	1
3			Screw, Hex Head w/ Patch (1/4-20 x 1/2")	1	2
4			NLA - Bracket, Switch Mounting, Black	1	1
5			Washer (1/4 x 1/2 x 1/16")	1	2
6			Locknut (1/4-20)	1	2
7			Bracket, Drive Lockout, Black	1	1
8			NLA - Screw, Hex Head (1/4-20 x 1-1/8")	1	2
9			Half Clamp, Non-Threaded Holes	1	1
10			NLA - Half Clamp, Threaded Holes	1	1
11			NLA - Bracket, Seat Pan Wiring, Black	1	2
12			Screw, Phillips Pan Head Tap (#10-32 x 1/2")	1	4
13		1080635-NLA	NLA - Harness, Recline/Tilt Limit Mercury Free Ball Switch	1	1
14	C	1126179-NLA	NLA - Harness, Actuator Extension To SAC or TRSS	1	1
15		1125722-NLA	NLA - Toggle Switch Mounting Bracket Assembly	1	1
16		1089384	Switch, Toggle Tilt Recline Single (TRSS)	1	1
2	B	1125770-NLA	NLA - Kit, Switch Mounting Hardware	1	1
3			Screw, Hex Head w/ Patch (1/4-20 x 1/2")	1	2
4			NLA - Bracket, Switch Mounting, Black	1	1
5			Washer (1/4 x 1/2 x 1/16")	1	2
6			Locknut (1/4-20)	1	2
17					
17	D	1091497-NLA	NLA - Kit, Quad Link Toggle Switch Mounting Hardware	1	1
18			Screw, Hex Head w/ Patch (1/4-20 x 1/2")	1	4
19			NLA - Bracket, Toggle Switch Mounting, Black	1	1
20			NLA - Bracket, Quad Link Toggle Switch Mounting, Black	1	1
21			Screw, Phillips Pan Head (#10-32 x 1-3/8")	1	2
22			Locknut (1/4-20)	1	2
23			Locknut (#10-32)	1	2
24		1139684-NLA	NLA - Kit, Quad Link Toggle Switch Mounting Hardware	1	1
25			Locknut (#10-32)	1	2
26			Screw, Hex Head w/ Patch (1/4-20 x 1/2")	1	2
27			Bracket, Toggle Switch Mounting, Black	1	1
28			Screw, Phillips Pan Head w/Patch (#10-32 x 7/8")	1	2

NOTE: A - Includes items 3-12
 B - Includes items 3-6
 C - Includes Bracket, Half Clamps and Screws. Individual components are not sold separately
 D - Before 10/31/05 and includes items 18-23
 E - After 10/30/05 and includes items 25-28

Mounting hardware after 1/16/05 will now accommodate the Personal Back 10 and DualFlex Backs from Invacare.