

# Quad Link

1/13/04 Thru 10/30/05

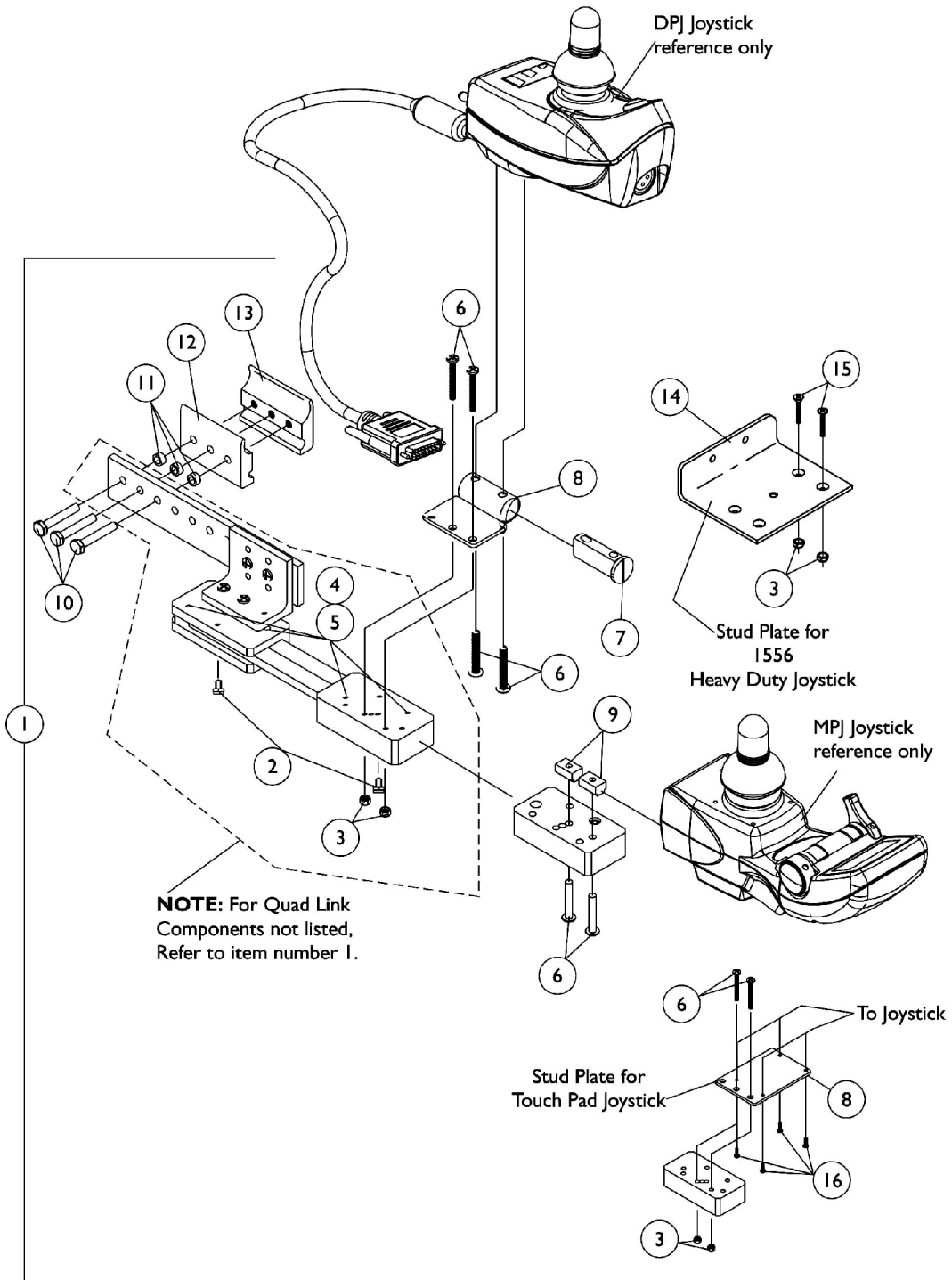

# Quad Link

## 1/13/04 Thru 10/30/05

Item Number	Note	Part Number	Description	Quantity Per	
				Package	Assembly
1	A	1052402-NLA	NLA - Kit, Quad Link Assembly - Right	1	1
2			NLA - Ball Plunger Assembly with Lock Washer	2	1
3			Locknut (#10-32)	1	2
4			NLA - Screw, Cap, Socket Head (#10-32 x 1/2")	1	4
5			NLA - Bushing, Bronze (3/16 x 1/4 x 1/4")	1	4
6			Screw, Phillips Pan Head (#10-32 x 1-1/8")	1	4
7			Spacer, Joystick Tube, Black	1	1
8			NLA - Stud Plate, Quad Link	1	1
10			Screw, Hex Head (1/4-20 x 1-1/2")	1	3
11			NLA - Spacer (1/4 x 3/8 x 3/16")	1	3
12			Half Clamp, Non-Threaded Holes	1	1
13			NLA - Half Clamp, Threaded Holes	1	1
1	A	1115372-NLA	NLA - Kit, Quad Link Assembly - Left	1	1
2			NLA - Ball Plunger Assembly with Lock Washer	2	1
3			Locknut (#10-32)	1	2
4			NLA - Screw, Cap, Socket Head (#10-32 x 1/2")	1	4
5			NLA - Bushing, Bronze (3/16 x 1/4 x 1/4")	1	4
6			Screw, Phillips Pan Head (#10-32 x 1-1/8")	1	4
7			Spacer, Joystick Tube, Black	1	1
8			NLA - Stud Plate, Quad Link	1	1
10			Screw, Hex Head (1/4-20 x 1-1/2")	1	3
11			NLA - Spacer (1/4 x 3/8 x 3/16")	1	3
12			Half Clamp, Non-Threaded Holes	1	1
13			NLA - Half Clamp, Threaded Holes	1	1
1	B	1117278-NLA	NLA - Kit, Quad Link Assembly - Right	1	1
2			NLA - Ball Plunger Assembly with Lock Washer	2	1
3			Locknut (#10-32)	1	2
4			NLA - Screw, Cap, Socket Head (#10-32 x 1/2")	1	4
5			NLA - Bushing, Bronze (3/16 x 1/4 x 1/4")	1	4
6			Screw, Phillips Pan Head (#10-32 x 1-1/8")	1	2
9			NLA - T-Nut (#10-32)	1	2
10			Screw, Hex Head (1/4-20 x 1-1/2")	1	3
11			NLA - Spacer (1/4 x 3/8 x 3/16")	1	3
12			Half Clamp, Non-Threaded Holes	1	1
13			NLA - Half Clamp, Threaded Holes	1	1
1	B		1117239-NLA	NLA - Kit, Quad Link Assembly - Left	1
2		NLA - Ball Plunger Assembly with Lock Washer		2	1
3		Locknut (#10-32)		1	2
4		NLA - Screw, Cap, Socket Head (#10-32 x 1/2")		1	4
5		NLA - Bushing, Bronze (3/16 x 1/4 x 1/4")		1	4
6		Screw, Phillips Pan Head (#10-32 x 1-1/8")		1	2
9		NLA - T-Nut (#10-32)		1	2
10		Screw, Hex Head (1/4-20 x 1-1/2")		1	3
11		NLA - Spacer (1/4 x 3/8 x 3/16")		1	3
12		Half Clamp, Non-Threaded Holes		1	1
13		NLA - Half Clamp, Threaded Holes		1	1

# Quad Link

## 1/13/04 Thru 10/30/05

Item Number	Note	Part Number	Description	Quantity Per			
				Package	Assembly		
1	C,E	1034703-NLA	NLA - Kit, Quad Link Assembly - Right	1	1		
2			NLA - Ball Plunger Assembly with Lock Washer	2	1		
3			Locknut (#10-32)	1	2		
4			NLA - Screw, Cap, Socket Head (#10-32 x 1/2")	1	4		
5			NLA - Bushing, Bronze (3/16 x 1/4 x 1/4")	1	4		
10			Screw, Hex Head (1/4-20 x 1-1/2")	1	3		
11			NLA - Spacer (1/4 x 3/8 x 3/16")	1	3		
12			Half Clamp, Non-Threaded Holes	1	1		
13			NLA - Half Clamp, Threaded Holes	1	1		
14			Plate, Stud, Quad Link For 1556 Heavy Duty Joystick	1	1		
15			C	1114866-NLA	Screw, Phillips Flat Head (#10-32 x 1-1/8")	1	2
1					NLA - Kit, Quad Link Assembly - Left	1	1
2					NLA - Ball Plunger Assembly with Lock Washer	2	1
3					Locknut (#10-32)	1	2
4	NLA - Screw, Cap, Socket Head (#10-32 x 1/2")	1			4		
5	NLA - Bushing, Bronze (3/16 x 1/4 x 1/4")	1			4		
10	Screw, Hex Head (1/4-20 x 1-1/2")	1			3		
11	NLA - Spacer (1/4 x 3/8 x 3/16")	1			3		
12	Half Clamp, Non-Threaded Holes	1			1		
13	NLA - Half Clamp, Threaded Holes	1			1		
14	Plate, Stud, Quad Link For 1556 Heavy Duty Joystick	1			1		
15	D	1102027-NLA			Screw, Phillips Flat Head (#10-32 x 1-1/8")	1	2
1					NLA - Kit, Quad Link Assembly - Right For TCHJOY/TCPDM4 Touchpad	1	1
2					NLA - Ball Plunger Assembly with Lock Washer	2	1
3			Locknut (#10-32)	1	2		
4			NLA - Screw, Cap, Socket Head (#10-32 x 1/2")	1	4		
5			NLA - Bushing, Bronze (3/16 x 1/4 x 1/4")	1	4		
6			Screw, Phillips Pan Head (#10-32 x 1-1/8")	1	2		
8			NLA - Plate, Stud, Quad Link MKIV TCHJOY/TCPDM4	1	1		
10			Screw, Hex Head (1/4-20 x 1-1/2")	1	3		
11			NLA - Spacer (1/4 x 3/8 x 3/16")	1	3		
12			Half Clamp, Non-Threaded Holes	1	1		
13			NLA - Half Clamp, Threaded Holes	1	1		
16			NLA - Screw, Phillips Flat Head Countersunk (#4-40 x 3/8")	1	4		
2			1114863-NLA	NLA - Ball Plunger Assembly with Lock Washer	2	1	

NOTE: A - Includes the Quad Link, items 2-8, 10-13 and used with an SPJ-80 and DPJ joystick  
B - Includes the Quad Link, items 2-6, 9-13 and used with a MPJ joystick  
C - Includes the Quad Link, items 2-5, 10-15 and used with a 1556 Heavy Duty joystick  
D - Includes the Quad Link, items 2-6, 8, 10-12 and 16. Used with a Touch Pad joystick. Left side mounted Quad Link must be requested as a "special" order  
E - Quad Link Assembly is no longer available. Please see Quad Link Assembly (After 10/30/05) category and use new Quad Link design as a replacement.