

# Electronics

## Quad Link

1/13/04 Thru 10/30/05

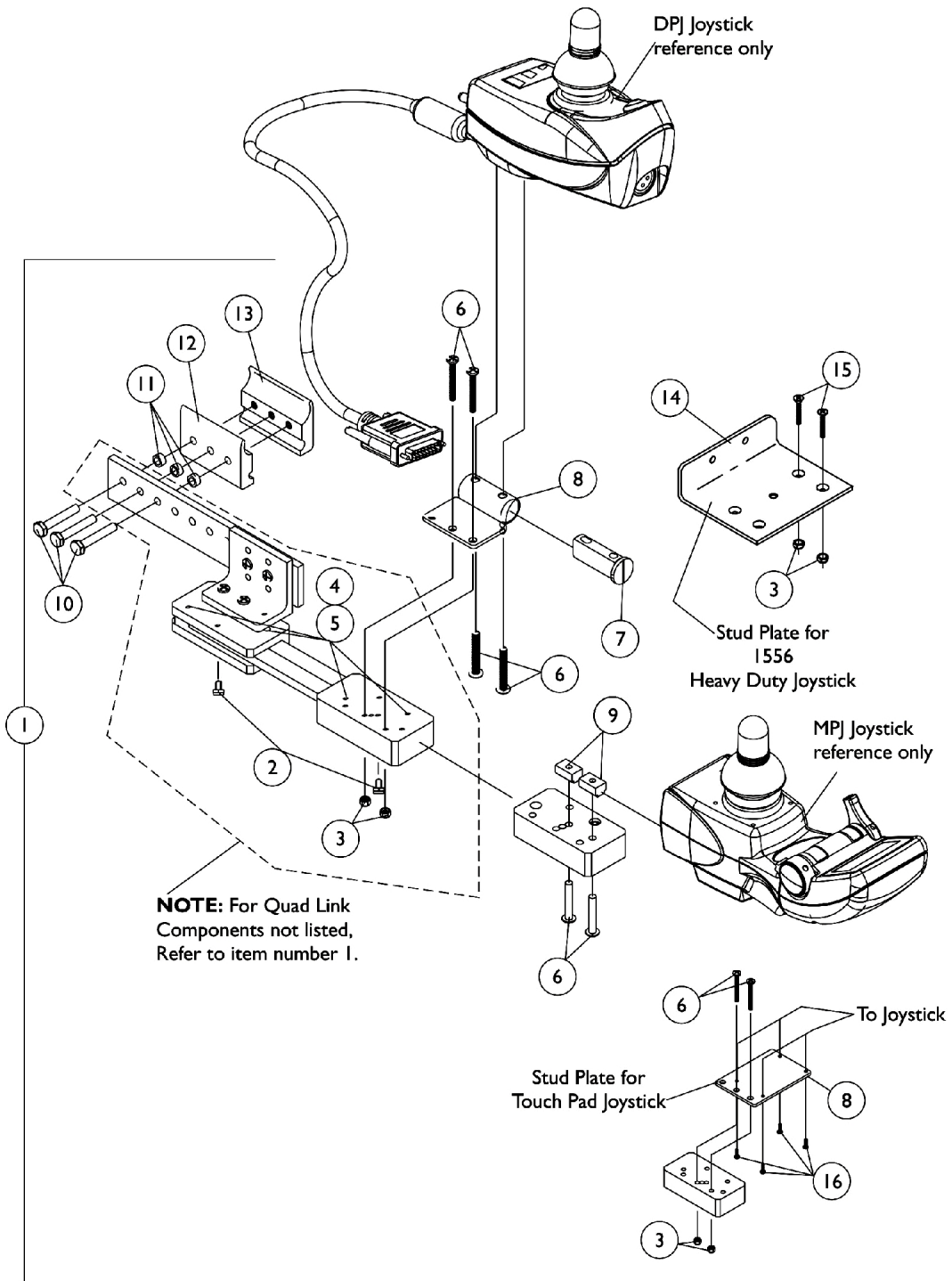

# Electronics

## Quad Link

1/13/04 Thru 10/30/05

Item Number	Note	Part Number	Description	Quantity Per		
				Package	Assembly	
1	A	1052402-NLA	NLA - Kit, Quad Link Assembly - Right	1	1	
2			NLA - Ball Plunger Assembly with Lock Washer	2	1	
3			Locknut (#10-32)	1	2	
4			NLA - Screw, Cap, Socket Head (#10-32 x 1/2")	1	4	
5			NLA - Bushing, Bronze (3/16 x 1/4 x 1/4")	1	4	
6			Screw, Phillips Pan Head (#10-32 x 1-1/8")	1	4	
7			Spacer, Joystick Tube, Black	1	1	
8			NLA - Stud Plate, Quad Link	1	1	
10			Screw, Hex Head (1/4-20 x 1-1/2")	1	3	
11			NLA - Spacer (1/4 x 3/8 x 3/16")	1	3	
12			Half Clamp, Non-Threaded Holes	1	1	
13			NLA - Half Clamp, Threaded Holes	1	1	
1	A		1115372-NLA	NLA - Kit, Quad Link Assembly - Left	1	1
2		NLA - Ball Plunger Assembly with Lock Washer		2	1	
3		Locknut (#10-32)		1	2	
4		NLA - Screw, Cap, Socket Head (#10-32 x 1/2")		1	4	
5		NLA - Bushing, Bronze (3/16 x 1/4 x 1/4")		1	4	
6		Screw, Phillips Pan Head (#10-32 x 1-1/8")		1	4	
7		Spacer, Joystick Tube, Black		1	1	
8		NLA - Stud Plate, Quad Link		1	1	
10		Screw, Hex Head (1/4-20 x 1-1/2")		1	3	
11		NLA - Spacer (1/4 x 3/8 x 3/16")		1	3	
12		Half Clamp, Non-Threaded Holes		1	1	
13		NLA - Half Clamp, Threaded Holes		1	1	
1	B	1117278-NLA		NLA - Kit, Quad Link Assembly - Right	1	1
2			NLA - Ball Plunger Assembly with Lock Washer	2	1	
3			Locknut (#10-32)	1	2	
4			NLA - Screw, Cap, Socket Head (#10-32 x 1/2")	1	4	
5			NLA - Bushing, Bronze (3/16 x 1/4 x 1/4")	1	4	
6			Screw, Phillips Pan Head (#10-32 x 1-1/8")	1	2	
9			NLA - T-Nut (#10-32)	1	2	
10			Screw, Hex Head (1/4-20 x 1-1/2")	1	3	
11			NLA - Spacer (1/4 x 3/8 x 3/16")	1	3	
12			Half Clamp, Non-Threaded Holes	1	1	
13			NLA - Half Clamp, Threaded Holes	1	1	
1	B		1117239-NLA	NLA - Kit, Quad Link Assembly - Left	1	1
2				NLA - Ball Plunger Assembly with Lock Washer	2	1
3		Locknut (#10-32)		1	2	
4		NLA - Screw, Cap, Socket Head (#10-32 x 1/2")		1	4	
5		NLA - Bushing, Bronze (3/16 x 1/4 x 1/4")		1	4	
6		Screw, Phillips Pan Head (#10-32 x 1-1/8")		1	2	
9		NLA - T-Nut (#10-32)		1	2	
10		Screw, Hex Head (1/4-20 x 1-1/2")		1	3	
11		NLA - Spacer (1/4 x 3/8 x 3/16")		1	3	
12		Half Clamp, Non-Threaded Holes		1	1	

# Electronics

## Quad Link

1/13/04 Thru 10/30/05

Item Number	Note	Part Number	Description	Quantity Per	
				Package	Assembly
13			NLA - Half Clamp, Threaded Holes	1	1
1	C,E	1034703-NLA	NLA - Kit, Quad Link Assembly - Right	1	1
2			NLA - Ball Plunger Assembly with Lock Washer	2	1
3			Locknut (#10-32)	1	2
4			NLA - Screw, Cap, Socket Head (#10-32 x 1/2")	1	4
5			NLA - Bushing, Bronze (3/16 x 1/4 x 1/4")	1	4
10			Screw, Hex Head (1/4-20 x 1-1/2")	1	3
11			NLA - Spacer (1/4 x 3/8 x 3/16")	1	3
12			Half Clamp, Non-Threaded Holes	1	1
13			NLA - Half Clamp, Threaded Holes	1	1
14			Plate, Stud, Quad Link For 1556 Heavy Duty Joystick	1	1
15			Screw, Phillips Flat Head (#10-32 x 1-1/8")	1	2
1	C	1114866-NLA	NLA - Kit, Quad Link Assembly - Left	1	1
2			NLA - Ball Plunger Assembly with Lock Washer	2	1
3			Locknut (#10-32)	1	2
4			NLA - Screw, Cap, Socket Head (#10-32 x 1/2")	1	4
5			NLA - Bushing, Bronze (3/16 x 1/4 x 1/4")	1	4
10			Screw, Hex Head (1/4-20 x 1-1/2")	1	3
11			NLA - Spacer (1/4 x 3/8 x 3/16")	1	3
12			Half Clamp, Non-Threaded Holes	1	1
13			NLA - Half Clamp, Threaded Holes	1	1
14			Plate, Stud, Quad Link For 1556 Heavy Duty Joystick	1	1
15			Screw, Phillips Flat Head (#10-32 x 1-1/8")	1	2
1	D	1102027-NLA	NLA - Kit, Quad Link Assembly - Right For TCHJOY/TCPDM4 Touchpad	1	1
2			NLA - Ball Plunger Assembly with Lock Washer	2	1
3			Locknut (#10-32)	1	2
4			NLA - Screw, Cap, Socket Head (#10-32 x 1/2")	1	4
5			NLA - Bushing, Bronze (3/16 x 1/4 x 1/4")	1	4
6			Screw, Phillips Pan Head (#10-32 x 1-1/8")	1	2
8			NLA - Plate, Stud, Quad Link MKIV TCHJOY/TCPDM4	1	1
10			Screw, Hex Head (1/4-20 x 1-1/2")	1	3
11			NLA - Spacer (1/4 x 3/8 x 3/16")	1	3
12			Half Clamp, Non-Threaded Holes	1	1
13			NLA - Half Clamp, Threaded Holes	1	1
16			NLA - Screw, Phillips Flat Head Countersunk (#4-40 x 3/8")	1	4
2		1114863-NLA	NLA - Ball Plunger Assembly with Lock Washer	2	1

# Electronics

## Quad Link

**1/13/04 Thru 10/30/05**

NOTE: A - Includes the Quad Link, items 2-8, 10-13 and used with an DPJ joystick  
B - Includes the Quad Link, items 2-6, 9-13 and used with a MPJ joystick  
C - Includes the Quad Link, items 2-5, 10-15 and used with a 1556 Heavy Duty joystick  
D - Includes the Quad Link, items 2-6, 8, 10-12 and 16. Used with a Touch Pad joystick. Left side mounted Quad Link must be requested as a "special" order  
E - Quad Link Assembly is no longer available. Please see Quad Link Assembly (After 10/30/05) category and use new Quad Link design as a replacement.