

# Front Rigging Hanger Assembly

ASBA Seat For (TDX Before 7/5/05) (M71 Before 8/8/05) (M91 Before 10/4/05)

NOTE: Front rigging hangers and seat pans share the same mounting hardware, see Seat Pan and Mounting Hardware page.

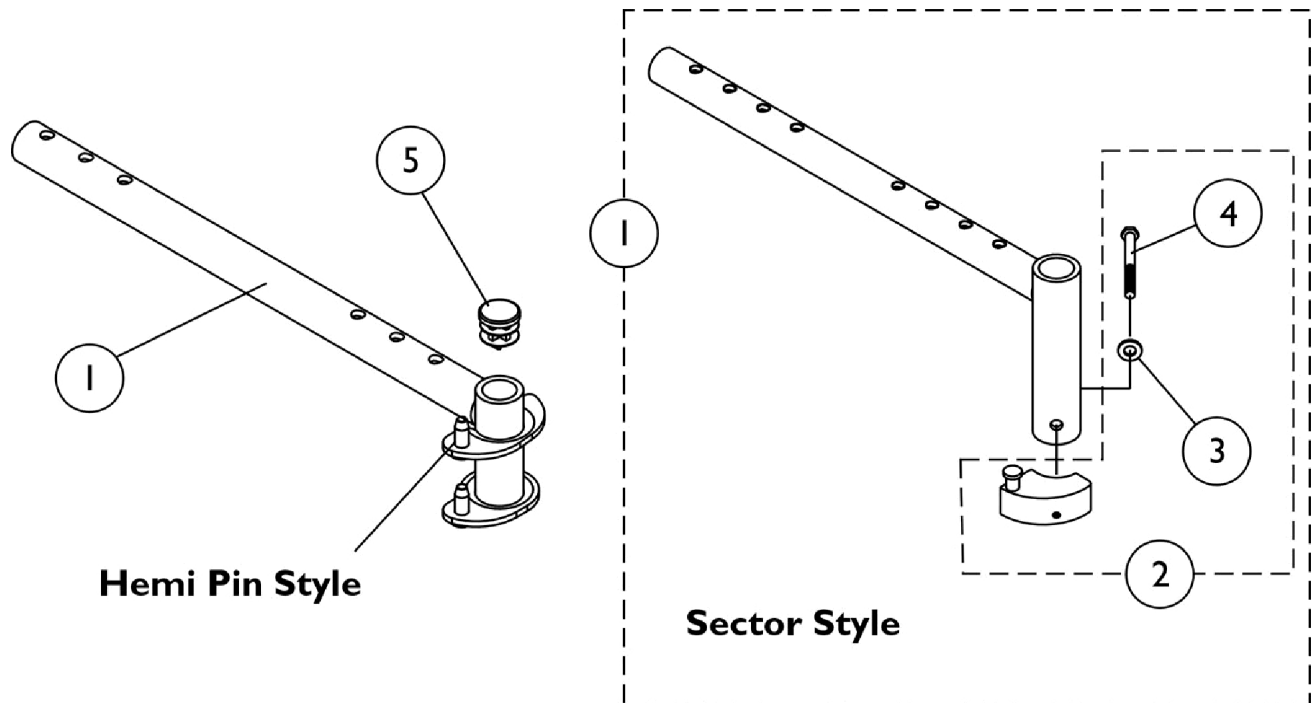

Item Number	Note	Part Number	Description	Quantity Per	
				Package	Assembly
1	A	1068435	Front Rigging Hanger Assembly w/ Sector Block, Black - Right (12 - 21" D)	1	1
1	A	1068436	Front Rigging Hanger Assembly w/ Sector Block, Black - Left (12 - 21" D)	1	1
1	A	1068437-NLA	NLA - Front Rigging Hanger Assembly w/ Sector Block, Black - Right (22" D)	1	1
1	A	1068438-NLA	NLA - Front Rigging Hanger Assembly w/ Sector Block, Black - Left (22" D)	1	1
1	B	1114766	Front Rigging Hanger Assembly w/ Plug Button, Pin Style, Hemi, Black - Right (12 - 21" D)	1	1
1	B	1114767	Front Rigging Hanger Assembly w/ Plug Button, Pin Style, Hemi, Black - Left (12 - 21" D)	1	1
1	B	1132339-NLA	NLA - Front Rigging Hanger Assembly w/ Plug Button, Pin Style, Hemi, Black - Right (22" D)	1	1
1	B	1132340-NLA	NLA - Front Rigging Hanger Assembly w/ Plug Button, Pin Style, Hemi, Black - Left (22" D)	1	1
2	C	1054571	Kit, Sector Block - Right	1	1
2	C	1054572	Kit, Sector Block - Left	1	1
3		1026907	Washer (1/4 x 1/2 x 1/16")	1	1
4		1052957	Screw, Hex Head w/ Patch (1/4-20 x 2")	1	1
5		1134426	Package, Plug Button, Black (3/4")	10	1

NOTE: A - Includes front rigging hanger and item 2  
 B - Includes front rigging hanger and item 5  
 C - Includes sector block assembly and items 3-4