

ADJASBA/ADJRECL Seat Frame, Seat Pan and Hardware (20"-24" Wide) x (16"-22" Deep) (After 7/4/05)

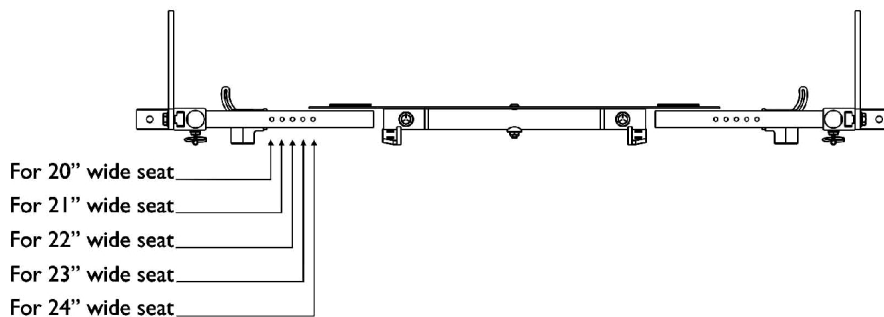
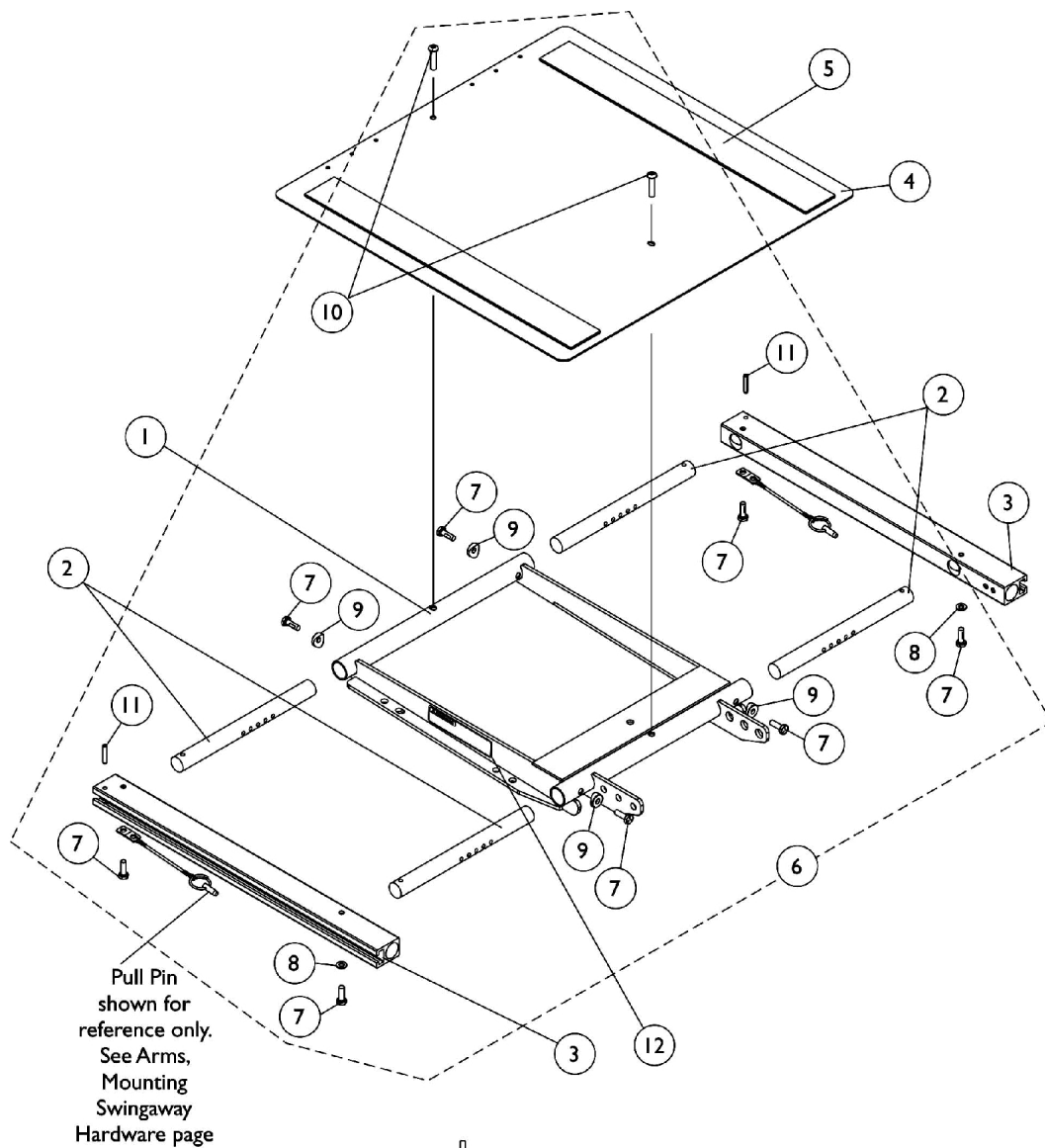

Seat Frame Width Settings

ADJASBA/ADJRECL Seat Frame, Seat Pan and Hardware (20"-24" Wide) x (16"-22" Deep) (After 7/4/05)

| Item Number | Note | Part Number | Description | Quantity Per | |
|------------------------------------------------------------------------------------------------------------------------------------------------------------------------------------------------------|------|-------------|----------------------------------------------------------------------------------------------------------------|--------------|----------|
| | | | | Package | Assembly |
| 1 | D | 1120288 | Frame, Center Seat, Black | 1 | 1 |
| 2 | | 1120283 | Crossbar, Seat Frame (20" - 24" W) | 1 | 4 |
| 3 | | 1122647 | Rail, Seat Frame (16 - 20" D For Formula TRE and 16 - 19" D For ADJASBA) | 1 | 2 |
| 3 | | 1122677 | Rail, Seat Frame (20 - 22" D Formula TRE) (19 - 22" D ADJASBA) | 1 | 2 |
| 4 | | 1124388 | Pan, Seat, with Hook and Loop Fasteners (20 - 24" W) x (16 - 20" D For Formula TRE) & (16 - 19" D For ADJASBA) | 1 | 1 |
| 4 | | 1124667 | Pan, Seat with Hook and Loop Fasteners (20 - 24" W) x (20 - 22" D For Formula TRE) & (19 - 22" D For ADJASBA) | 1 | 1 |
| 5 | A | 1043082 | Hook Fastener with Adhesive Back (2" W x 18" L) | 1 | 2 |
| 5 | A | 1044580 | Loop Fastener with Adhesive Back (2" W x 18" L) | 1 | 2 |
| 5 | B | 1043084 | Hook Fastener with Adhesive back (2" W x 22" L) | 1 | 2 |
| 5 | B | 1044584 | Loop Fastener with Adhesive back (2" W x 22" L) | 1 | 2 |
| 6 | C | 1135501 | Kit, Seat Frame Assembly Hardware | 1 | 1 |
| 7 | | | Screw, Hex Head w/ Patch (1/4-20 x 3/4") | 1 | 8 |
| 8 | | | Washer (1/4 x 1/2 x 1/16") | 1 | 2 |
| 9 | | | Spacer, Coved (1/4 x 11/16 x 1/2") | 1 | 4 |
| 10 | | | Screw, Socket Button (1/4-20 x 3/4") | 1 | 2 |
| 11 | | | NLA - Pin, Roll (3/16 x 1") | 1 | 2 |
| 12 | | 1114823 | Decal, Seat Adjustment Warning | 1 | 2 |
| NOTE: A - For 16"-19" deep seats B - For 19"-22" deep seats C - Includes items 7-11 D - When ordering Center Seat Frame (item 1), also order 2 ea. Seat Adjustment Warning Decal (item 12). | | | | | |