

Wheel Lock - Hublock Replacement Kits - After 10/31/07

Attendant Foot Operated

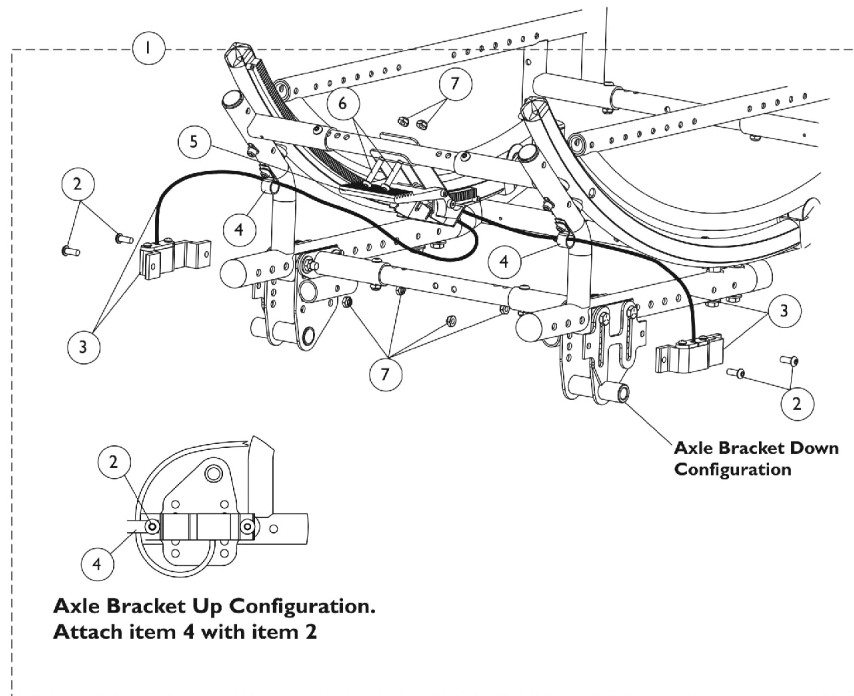

Item Number	Note	Part Number	Description	Quantity Per	
				Package	Assembly
1	A	1132607-NLA	NLA - Kit, Hublock Cables and Hardware - Foot Operated	1	1
2			Screw, Socket Button Head (1/4-28 x 5/8")	1	4
3			Latch with Cable Assembly, Hublock - Right	1	1
3			Latch with Cable Assembly, Hublock - Left	1	1
4			NLA - Bracket, Cable/Wire Mounting, Black	1	2
5			Actuator Assembly, Foot Operated	1	1
6			Screw, Socket Button Head (1/4-28 x 1-1/4")	1	2
7			Locknut (1/4-28)	1	6
3	B,C,D	1132357	Latch with Cable Assembly, Hublock - Right	1	1
3	B,C,D	1132358	Latch with Cable Assembly, Hublock - Left	1	1

NOTE: A - Includes items 2-7
 B - Hublock replacement cables for chairs built after 10/31/07.
 C - For chairs manufactured before 2/2/09, it is recommended to order the Hublock Latch with Cable Assembly part numbers 1132357 and 1132358 together.
 D - For chairs manufactured after 2/1/09, it is also recommended to order both Hublock Latch with Cable Assembly part numbers 1132357 and 1132358 together to allow even wear on the components.

NOTE: Invacare does not recommend the use of service part number(s), 1132357 and/or 1132358, for replacement hub lock cable(s) for wheel chairs manufactured prior to November 1, 2007. Wheel chairs manufactured prior to this date require Replacement Kits which include complete replacement of the foot operated pedal housing components in addition to cable assemblies. Please consult with Invacare's customer service group for the appropriate Replacement Kit suitable for installation onto your particular model wheel chair.