

Walking Beam Assembly (After 4/25/05)

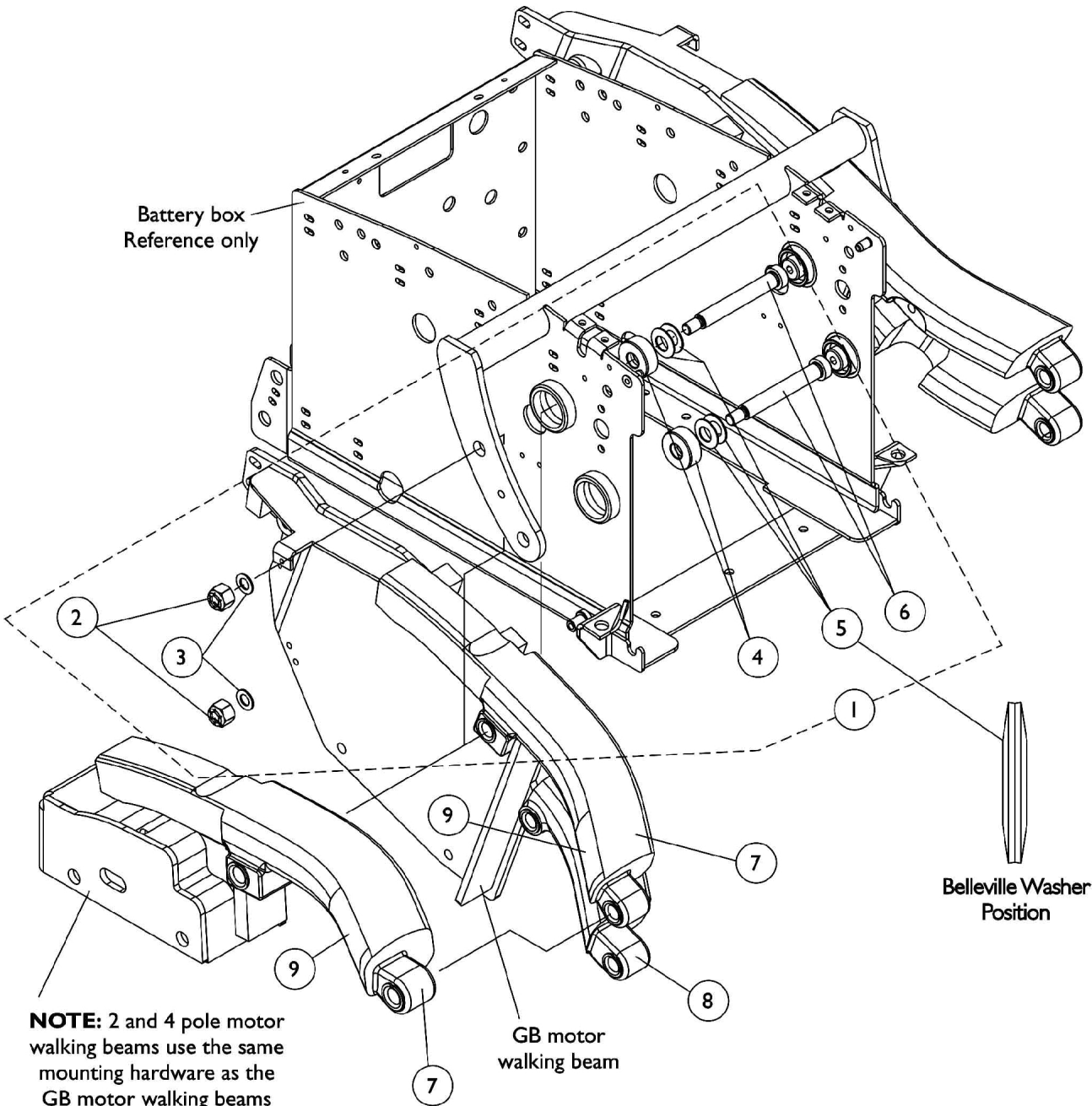

NOTE: 2 and 4 pole motor walking beams use the same mounting hardware as the GB motor walking beams

GB motor walking beam

Belleville Washer Position

Walking Beam Assembly (After 4/25/05)

Item Number	Note	Part Number	Description	Quantity Per	
				Package	Assembly
1	A	1128397-NLA	NLA - Hardware, Walking Beam Mounting	1	1
2		1065216	Locknut (3/8-16)	1	2
3		1065214	Washer, Flat (3/8 x 11/16 x 1/16")	1	2
4		1133037-NLA	NLA - Bushing (1/2 x 1-1/4 x 1/2")	1	2
5		1133083	Washer, Belleville (1/2 x 1 x 1/32")	1	4
6		1113246-NLA	NLA - Screw, Shoulder Hex Socket Head (1/2 x 3-1/4", 3/8-16)	1	2
7	B	8881113144-NL A	NLA - Beam, Walking without Model Decal GB - Right	1	1
7	B	8881113145	NLA - Beam, Walking without Model Decal GB - Left	1	1
7	B	8881113158-NL A	NLA - Walking Beam w/o Model Decal, 2 and 4 Pole Motor - Right	1	1
7	B	8881113159-NL A	NLA - Walking Beam w/o Model Decal, 2 and 4 Pole Motor - Left	1	1
8	B	8881113218-NL A	NLA - Walking Beam, Lower - Right	1	1
8	B	8881113219-NL A	NLA - Walking Beam, Lower - Left	1	1
9		1117207-NLA	NLA - Decal, TDX 3, Yellow	1	1
9	C	1144624	Decal, TDX 3, Black	1	1
9		1146484-NLA	NLA - Decal, TDX 3 SE, Yellow	1	1
9	C	1146485-NLA	NLA - Decal, TDX 3 SE, Black	1	1
9		1117206-NLA	NLA - Decal, TDX 4, Yellow	1	1
9	C	1144623	Decal, TDX 4, Black	1	1
9		1117205-NLA	NLA - Decal, TDX 5, Yellow	1	1
9	C	1144622	Decal, TDX 5, Black	1	1

NOTE: A - Includes items 2-6
 B - Specify frame color when ordering, see page titled "Frame Finishes and Touch-Up Paints".
 C - Black Decal is used whenever frame color 30P, Sunny Yellow is ordered