

Stability Lock & Battery Box-To-Walking Beam Extension Spring Assembly

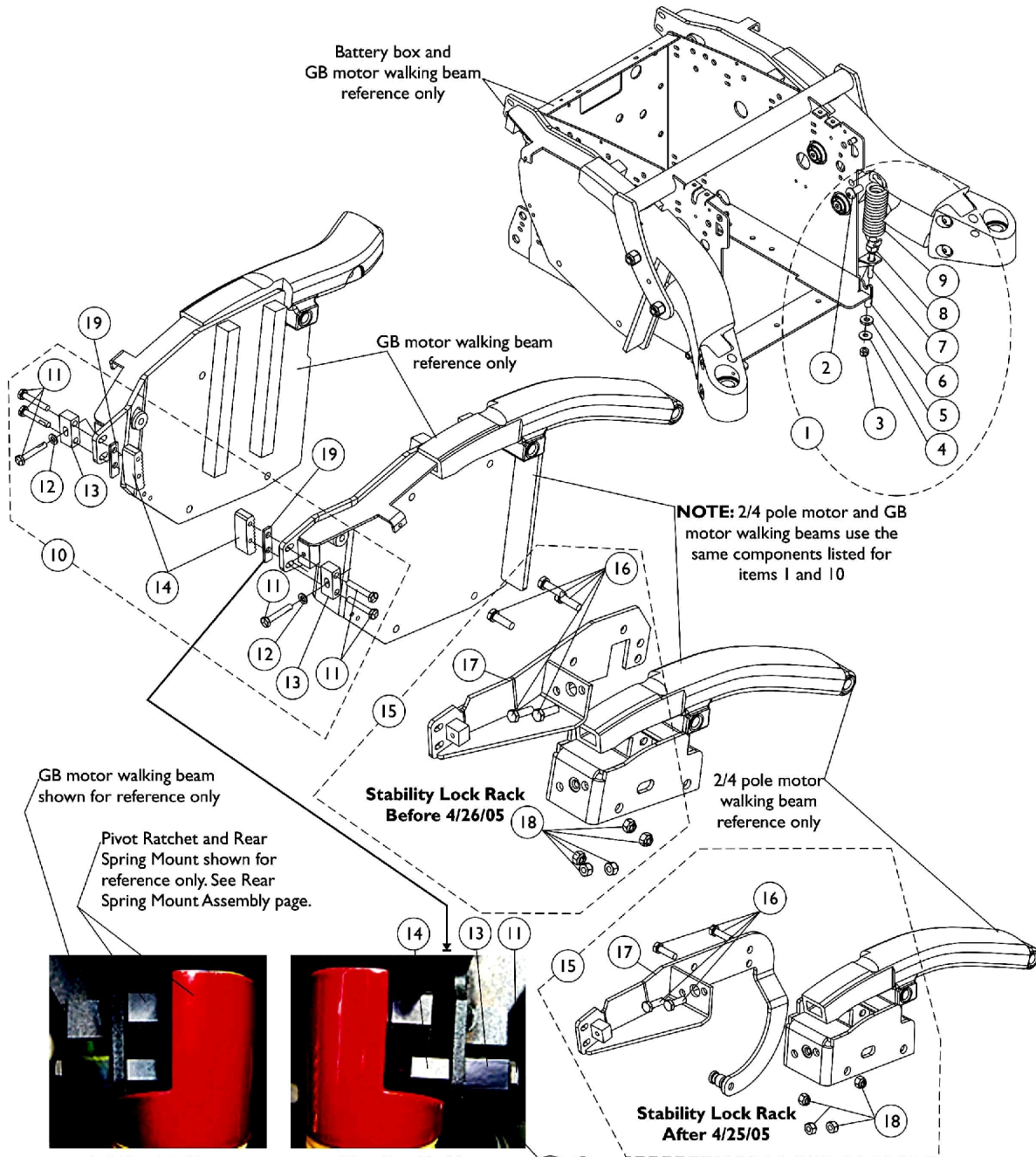

Left Rear Top View
(Shim spacer is not required in this view)



Right Rear Top View
(rack is out of alignment and shim spacer is required)

Item 19 Rack Shim Spacer Application

Selective use of item 19 rack shim spacer will be present on chairs whenever overlap of the stability lock motor rack is less than 1/2" in reference to the pivot ratchet surface.

Stability Lock & Battery Box-To-Walking Beam Extension Spring Assembly

Item Number	Note	Part Number	Description	Quantity Per	
				Package	Assembly
1	A	1119780-NLA	NLA - Extension Spring Assembly, Battery Box - Walking Beam	1	1
2		1022866-NLA	NLA - Screw, Socket Button Head (3/8-16 x 3/4")	1	2
3		1025736	Locknut (1/4-20)	1	1
4		1026900	Washer (1/4 x 23/32 x 1/16")	1	1
5		1106225-NLA	NLA - Washer, Nylon (5/16 x 11/16 x 1/8")	1	1
6		1117229-NLA	NLA - Sleeve, Lock Nylon	1	1
7		1113248-NLA	NLA - Rod, Spring Connector	1	1
8		1025736	Locknut (1/4-20)	1	1
9		1117196-NLA	NLA - Spring, Extension (1-1/4 x 4-3/4" L)	1	1
10	B	1117230-NLA	NLA - Hardware, Stability Lock	2	1
11		1117224-NLA	NLA - Screw, Hex Head w/ Patch (1/4-20 x 1-1/2")	1	6
12		1026907	Washer (1/4 x 1/2 x 1/16")	1	2
13		1117244-NLA	NLA - Block, Stability Lock Clamp	1	2
14	G	1121250-NLA	NLA - Rack, Motor	1	2
15	C,E	1120372-NLA	NLA - Rack, Stability Lock with Hardware - Right	1	1
15	C,E	1120373-NLA	NLA - Rack, Stability Lock with Hardware - Left	1	1
15	C,F	1133080-NLA	NLA - Rack, Stability Lock with Hardware - Right	1	1
15	C,F	1133081-NLA	NLA - Rack, Stability Lock with Hardware - Left	1	1
16		1003548	Screw, Hex Head (5/16-18 x 1")	1	5
17	E	1113314-NLA	NLA - Rack, Stability Lock - Right	1	1
17	E	1113315-NLA	NLA - Rack, Stability Lock - Left	1	1
17	F	1133076-NLA	NLA - Rack, Stability Lock - Right	1	1
17	F	1133077-NLA	NLA - Rack, Stability Lock - Left	1	1
18		1026158	Locknut (5/16-18)	1	5
19	D	1121431-NLA	NLA - Spacer, Rack Shim, Black	1	2

NOTE: A - Includes items 2-9.
B - Includes items 11-14.
C - Includes items 16-18.
D - Rack Shim Spacers are not present on all chairs. See pictorial for reference.
E - Before 4/26/05.
F - After 4/25/05.
G - No longer available. To order replacement use part number 1117230 (Item 10)