

# 90FB Footboard Assembly

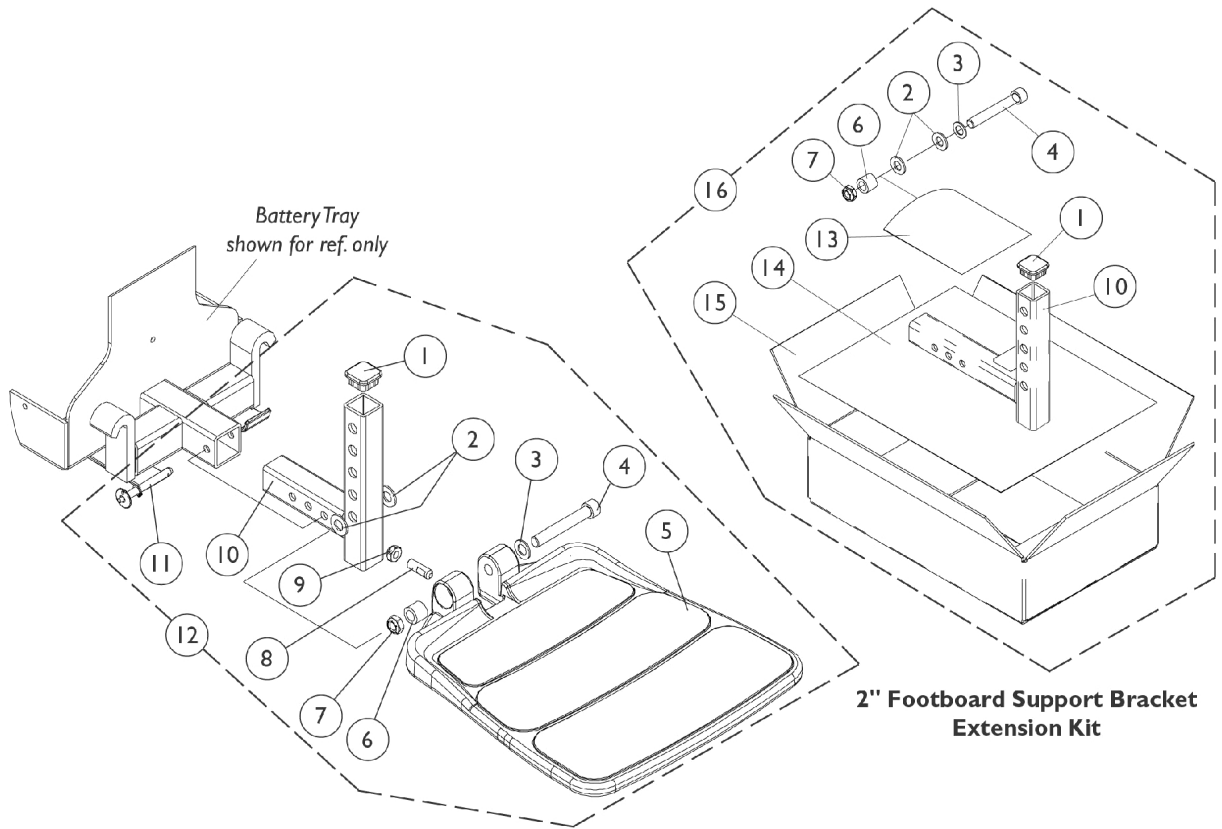

## 90FB Footboard Assembly

Item Number	Note	Part Number	Description	Quantity Per	
				Package	Assembly
12	A,B,D, E	1105027-NLA	NLA - Footboard Assembly	1	1
1			Plug Button, Black (1" Square)	1	1
2			Washer, Nylon (3/8 x 3/4 x 1/16")	1	2
3			Washer, Flat (3/8 x 11/16 x 1/16")	1	1
4			Screw, Socket Head (3/8-16 x 2-1/2")	1	1
5			NLA - Footboard with Cover	1	1
6			Bushing (3/8 x 5/8 x 1/2")	1	1
7			Locknut, Low Profile (3/8-16)	1	1
8			Screw, Set Socket Flat Point (5/16-18 x 1")	1	1
9			Locknut (5/16-18)	1	1
10			Bracket, Footboard Support, Black	1	1
11	Pin, Quick Release	1	1		
13	C,D	1300010-NLA	NLA - Bag, Zip-Lip (4" L x 4" W)	1	1
14		1114833-NLA	NLA - Instruction Sheet, 2" Footboard Extension	1	1
15		40131X044	Carton, Shipper	1	1
16		1115378	Kit, 2" Footboard Extension	1	1
1		Plug Button, Black (1" Square)	1	1	
2		Washer, Nylon (3/8 x 3/4 x 1/16")	1	2	
3		Washer, Flat (3/8 x 11/16 x 1/16")	1	1	
4		Screw, Socket Head (3/8-16 x 2-1/2")	1	1	
6		Bushing (3/8 x 5/8 x 1/2")	1	1	
7		Locknut, Low Profile (3/8-16)	1	1	
10		Bracket, Footboard Support, Black (2" Extension)	1	1	
13		NLA - Bag, Zip-Lip (4" L x 4" W)	1	1	
14		NLA - Instruction Sheet, 2" Footboard Extension	1	1	
15		Carton, Shipper	1	1	

NOTE: A - Includes items 1-11  
 B - When ordering a footboard assembly for the first time that requires a 2" extension kit, items 5, 8, 9, 11 and 16 must be ordered  
 C - Includes items 1-4, 6, 7, 10 and 13-15  
 D - Part number 1114833 is no longer available from the Invacare Service Parts Department. Refer to the Invacare Website under "Product Literature Search". Enter the part number in the "Keywords" field and download a free PDF version copy.  
 E - Part #1105027 is No Longer Available and a replacement is currently not available.