

# Axles & Axle Mounting Plate Hardware

For Amputee Attachment, no new hardware is needed, see Owner's Manual to reconfigure Axle Bracket, item 4.

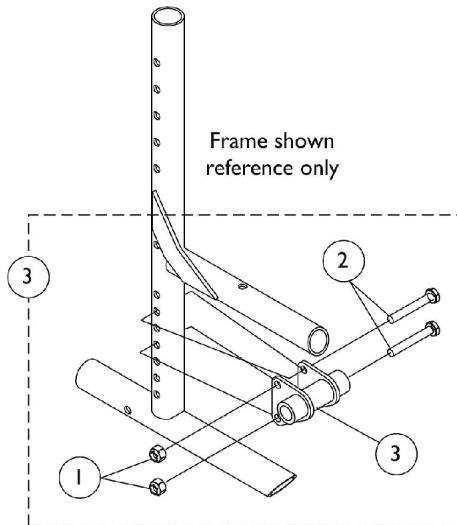

**Chairs built Before 6/24/99**

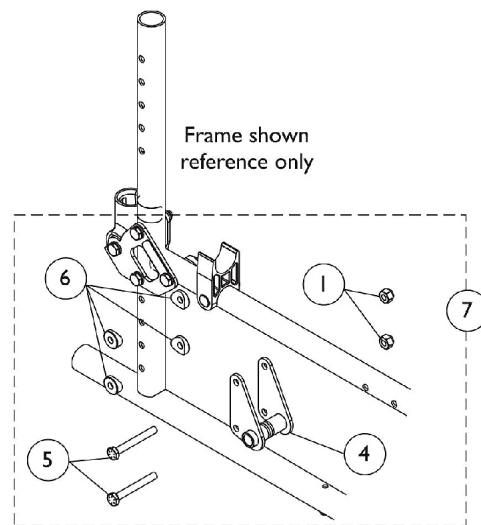

**Chairs built After 6/23/99**

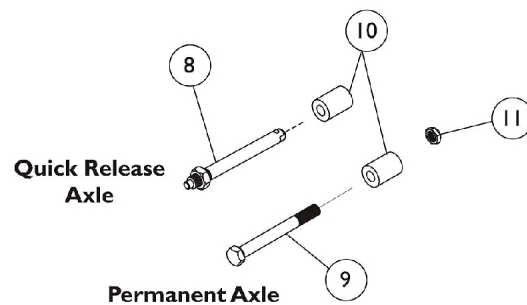

# Axles & Axle Mounting Plate Hardware

For Amputee Attachment, no new hardware is needed, see Owner's Manual to reconfigure Axle Bracket, item 4.

| Item Number  | Note     | Part Number | Description                                     | Quantity Per |          |
|--|----------|-------------|---|--------------|----------|
|  |          |             |   | Package      | Assembly |
| 1  |          | 1065362     | Locknut (1/4-28)                                | 1            | 4        |
| 2  |          | 1055348     | Screw, Hex Head (1/4-28 x 1-3/4")               | 1            | 4        |
| 3  | C,D,F, A | 1083141-NLA | NLA - Plate, Axle with Mounting Hardware (Pair) | 2            | 1        |
| 3  | B,C,D, F | 1083142-NLA | NLA - Plate, Axle with Mounting Hardware (Pair) | 2            | 1        |
| 4  |          | 1086807-NLA | NLA - Plate, Axle Mounting - Right              | 1            | 1        |
| 4  |          | 1086808     | Plate, Axle Mounting - Left                     | 1            | 1        |
| 5  |          | 1114099     | NLA - Screw, Hex Head (1/4-28 x 2")             | 1            | 4        |
| 6  |          | 1026099     | Spacer, Coved (1/4 x 11/16 x 1/2")              | 1            | 8        |
| 7  | E,G      | 1088229     | Plate, Axle with Mounting Hardware (Pair)       | 2            | 1        |
| 8  | D,A      | 1026930-NLA | NLA - Axle, Quick Release (1/2 x 4-1/2")        | 1            | 2        |
| 8  | B,D      | 1040361     | Axle, Quick Release w/ Locknut (1/2" x 5")      | 1            | 2        |
| 8  | E,A      | 1015436     | Axle, Quick Release (7/16" x 4-1/2")            | 1            | 2        |
| 8  | B,E      | 56000X651   | Axle, Quick Release (7/16" x 5-7/16")           | 1            | 2        |
| 9  | D        | 1049227     | Screw, Hex Head (1/2-20 x 5-1/4")               | 1            | 2        |
| 9  | E,A      | 47203X025   | Bolt, Hex Head Cap (7/16-20 x 4-3/4")           | 1            | 2        |
| 9  | B,E      | 1085454     | Bolt, Hex Head Cap (7/16-20 x 5-1/8")           | 1            | 2        |
| 10   | D        | 1038117-NLA | NLA - Bushing                                   | 1            | 2        |
| 10   | E,A      | 1026101     | Spacer (7/16 x 5/8 x 3/16")                     | 1            | 2        |
| 10   | B,E      | 1088230-NLA | NLA - Spacer (7/16 x 5/8 x 5/8")                | 1            | 2        |
| 11   | D        | 1025737     | Locknut (1/2-20)                                | 1            | 2        |
| 11   | E        | 1088235-NLA | NLA - Locknut (7/16-20)                         | 1            | 2        |
| NOTE: A - Chairs with Space-Saver Style Arms.<br>B - Chairs with Conventional Style Arms.<br>C - Axle Mounting Plate is not sold separately on chairs built Before 6/24/99. Must be replaced in pairs only.<br>D - Chairs built Before 6/24/99.<br>E - Chairs built After 6/23/99.<br>F - Includes items 1-3.<br>G - Includes items 1,4-6. |          |             |   |              |          |